

# LAHP-201-33MTRBKT ASSEMBLY



## MOUNT COMPATIBILITY

| Mount Compatibility  |            |                                   |                                 |
|--|------------|-----------------------------------|---------------------------------|
| Motor Frame Size   | Motor Type | LAHP-33/33W Series                |                                 |
|  |            | Motor Bracket PN                  | Coupling PN                     |
| <b><i>SVL-201 / SVL-201B</i></b><br><b><i>(40mm frame)</i></b> | Servo      | <a href="#">LAHP-201-33MTRBKT</a> | <a href="#">LAHP-33-CPL-201</a> |

## ASSEMBLY INSTRUCTIONS

The following illustrations show how to install the motor mount to the actuator. These steps only apply to LAHP-33 series actuators.

- 1) Slide the motor mount frame onto the shaft on the end of the actuator.
- 2) Secure the mount using the three (3) supplied SHCS and three (3) washers.

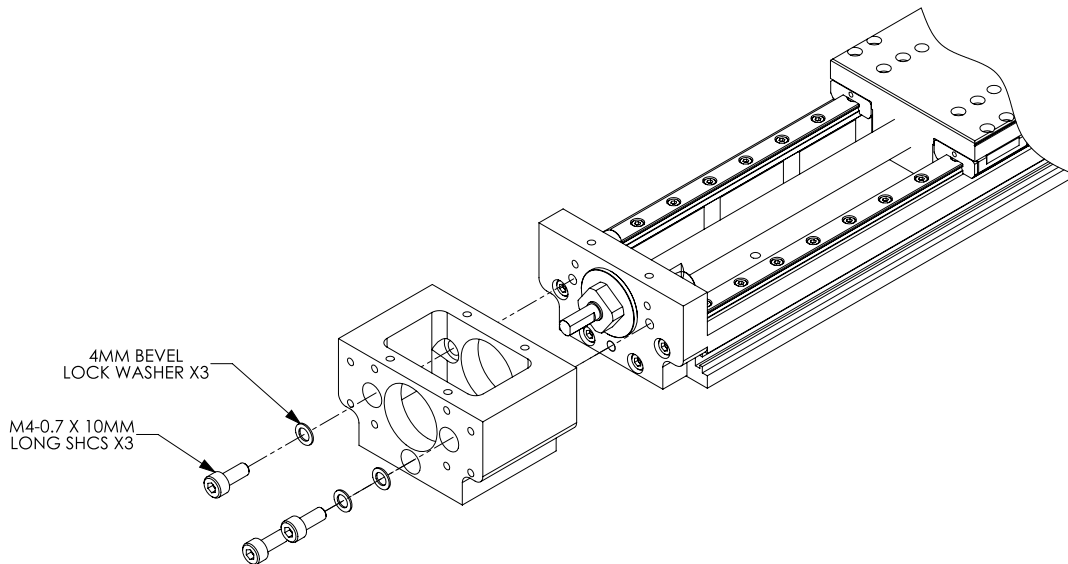

- 3) Secure the plate to the end of the mount using the four (4) supplied SHCS and four (4) washers.

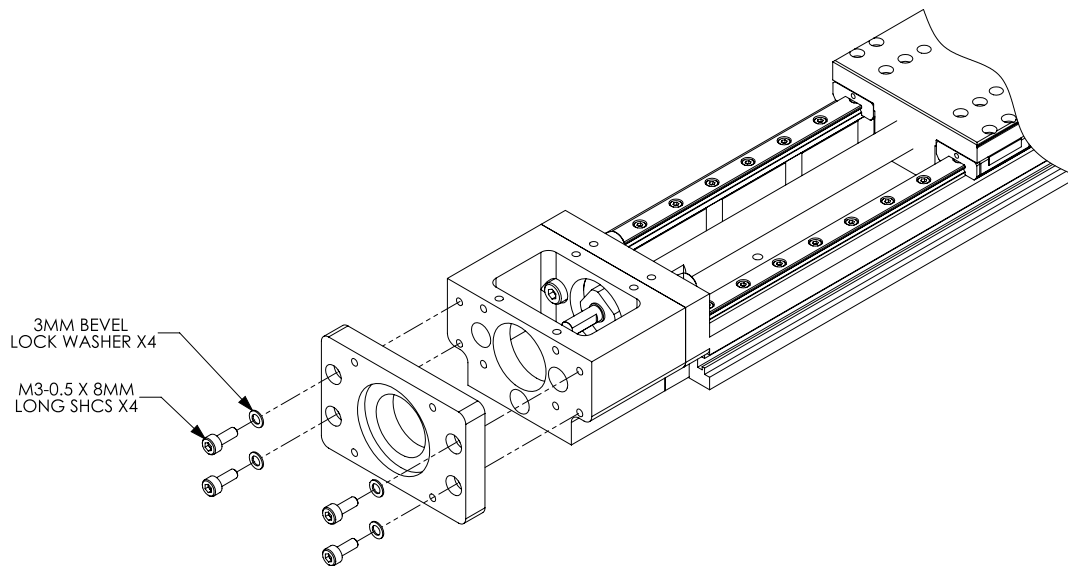

- 4) Slide the coupling (sold separately, see table) through the plate, into the mount frame and onto the shaft of the actuator.
- 5) Slide the [SVL-201](#) or [SVL-201B](#) servo motor shaft through the plate and into the coupling and secure to the plate using the two (2) supplied SHCS and two (2) washers. Tighten the 2 screws on the coupling to a torque of 0.5 Nm (4.4 in·lbs) to secure to the actuator and motor shafts.

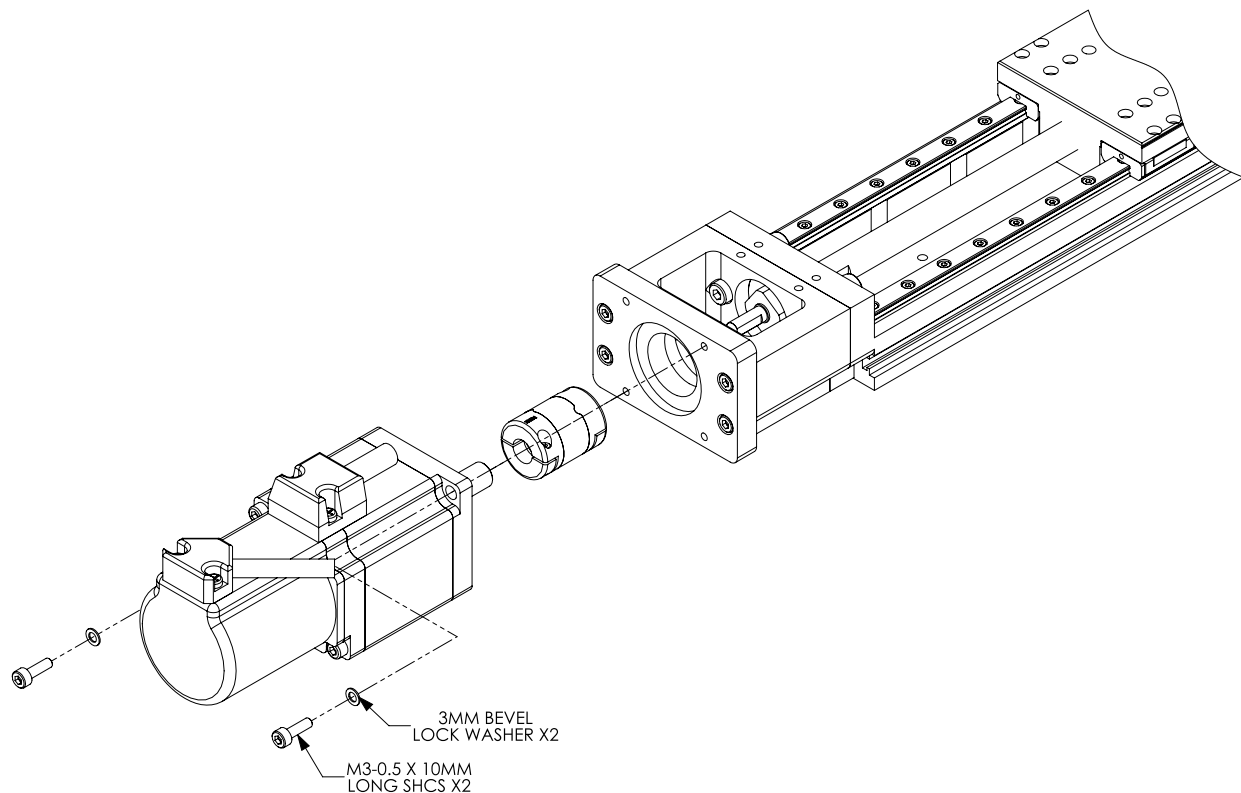

**NOTE:** Ensure Actuator Shaft and Motor Shaft are clean of grease and debris prior to installing coupling.



**NOTE:** When mounting motor, orient so that motor cables are directed for best cable management in final overall installation.



*NOTE: Perform these steps with the actuator shaft in the vertical position to minimize axial misalignment of the motor.*

- 6) Place the cover over the mount and secure using the four (4) supplied SHCS and four (4) washers.

