

LAHP-201-25MTRBKT ASSEMBLY



MOUNT COMPATIBILITY

Mount Compatibility			
Motor Frame Size	Motor Type	LAHP-25 Series	
		Motor Bracket PN	Coupling PN
<u>SVL-201 / SVL-201B</u> (40mm frame)	Servo	LAHP-201-25MTRBKT	LAHP-25-CPL-201

ASSEMBLY INSTRUCTIONS

The following illustrations show how to install the motor mount to the actuator. These steps only apply to LAHP-25 series actuators.

- 1) Place the coupling (sold separately, see table) into the motor mount frame and slide onto the shaft on the end of the actuator input shaft, then align set screw with flat on input shaft and tighten.
- 2) Secure the mount using the three (3) supplied SHCS and three (3) washers.

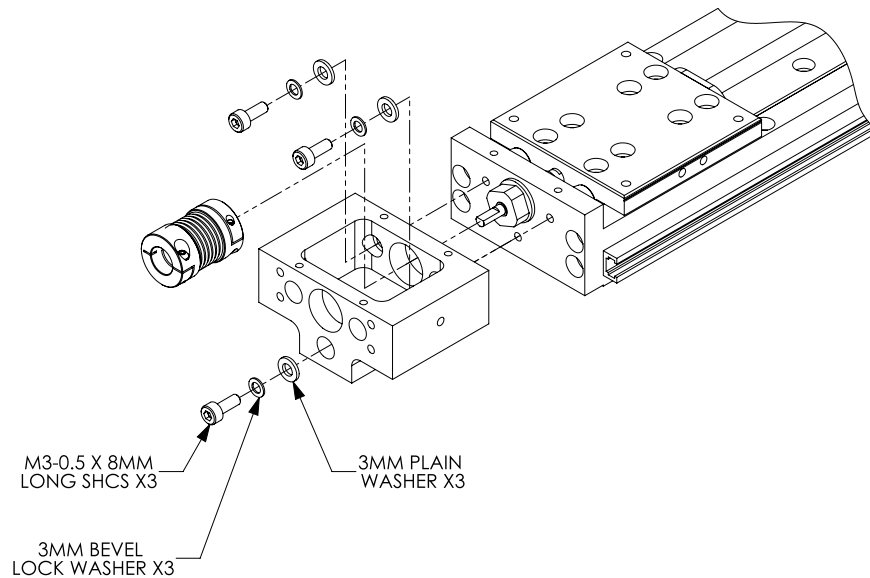

NOTE: Ensure Actuator Shaft and Motor Shaft are clean of grease and debris prior to installing coupling.

- 3) Secure the plate to the end of the mount using the four (4) supplied Button Head Cap Screws (BHCS) and four (4) washers.

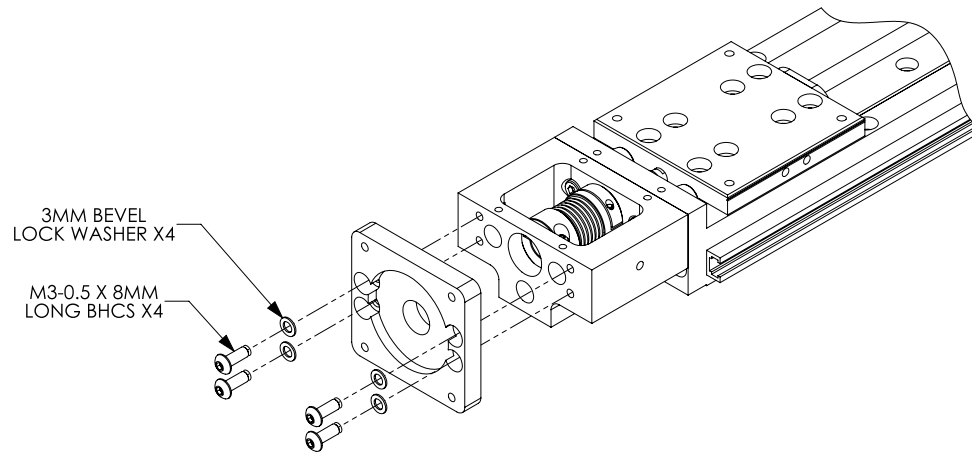

- 4) Slide the [SVL-201](#) or [SVL-201B](#) servo motor shaft through the plate and into the coupling and secure to the plate using the two (2) supplied SHCS and two (2) washers. Tighten the 2 screws on the coupling to a torque of 0.43 Nm (3.8 in·lbs) to secure to the actuator and motor shafts.

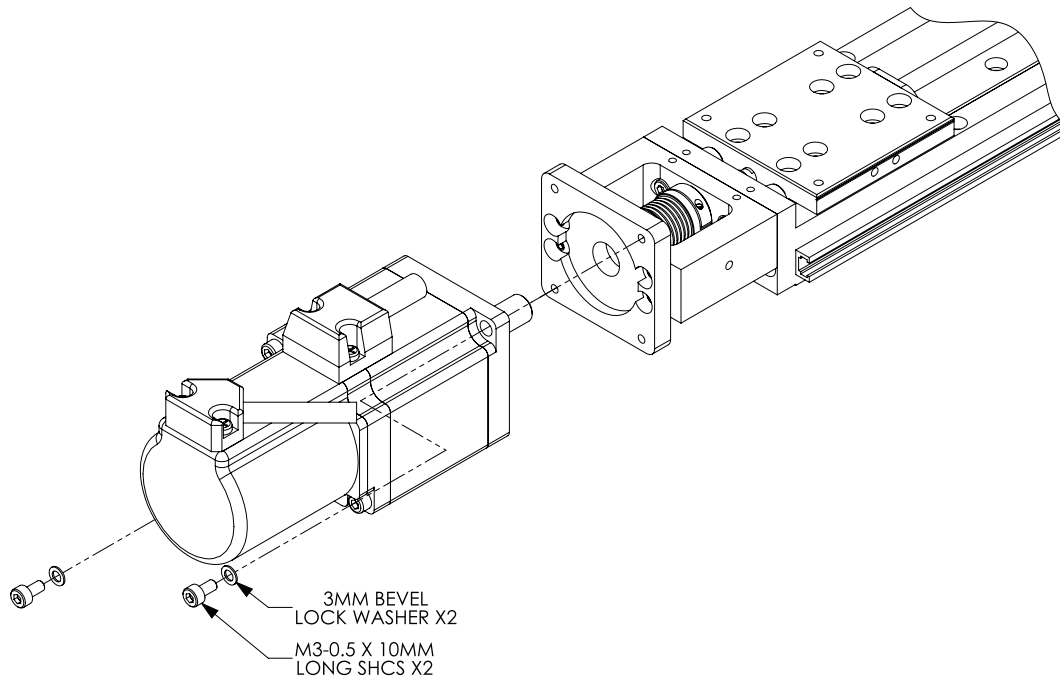

NOTE: When mounting motor, orient so that motor cables are directed for best cable management in final overall installation.



NOTE: Perform this step with the actuator shaft in the vertical position to minimize axial misalignment of the motor.

- 5) Place the cover over the mount and secure using the supplied M2.5-0.45 x 6mm SHCS and 2.5 mm washers.

