

SUREGEAR® STRAIN WAVE GEARBOX MOUNTING INSTRUCTIONS



INSPECTION AND PREPARATION

Upon delivery of your gearbox, confirm that you received the correct model that appears on your purchase order.

Check to ensure the motor shaft size and input shaft bore are matched. Inspect the gearbox for shipping damage. If any damage is suspected, notify the shipping agent immediately.

Clean and de-grease the motor mounting surface, shaft, gearbox mounting surface, and input hub bore (Figure 1).

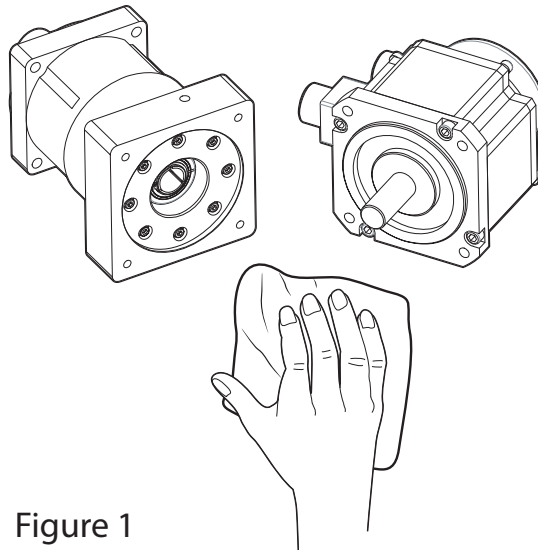

Figure 1

OPERATION NOTES

- *Avoid use in wet or corrosive areas unless the gearbox is rated for use in those environments.*
- *Ambient temperature around the gearbox should be in the range of -40°C to 90°C (-40°F to 194°F) to prevent damage to the unit.*
- *Ensure that the motor speed and torque loads do not exceed the maximums specified for the given unit.*
- *Do not disassemble or modify the gearbox. Doing so may cause injury or damage to the gearbox.*
- *The gearbox is sealed and pre-lubricated for its lifetime with an appropriate grease and does not require a change of lubricant.*
- *Depending on environment and application, the gearbox temperature can increase to levels that may cause injury if touched. Do not touch the gearbox during operation or immediately after operation.*

MOUNTING INSTRUCTIONS

- 1) Remove access hole plug from the motor adapter (if provided, see Figure 2).
- 2) Rotate the clamping collar until the tightening screw is lined up with the access hole.
- 3) Insert the motor shaft into the gearbox input hub, with the motor shaft keyway (if present) aligned with the gearbox input shaft clamp opening. Be sure to align the collet gap over the flat and the set collar perpendicular to the flat. (Figure 3).
- 4) Install the mounting screws to ensure alignment of the motor to the gearbox. Initially tighten the mounting screws in a cross pattern to 5% of the required torque for the mounting screws. If possible, mount the motor to the gearbox in a vertical position (Figure 4).
- 5) Tighten the collar bolt on the input shaft. Reinstall the access hole plug (if provided). Refer to the torque specifications in the following table and tighten to the given torque specifications. (Figure 5).
- 6) Tighten the mounting screws (Figure 4) to the specified torque.

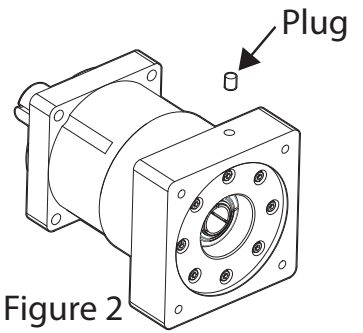

Figure 2

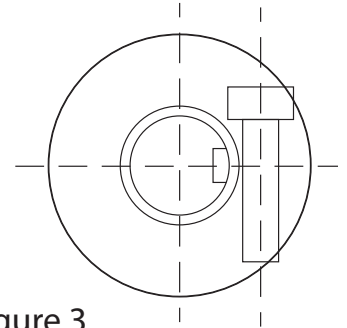

Figure 3

Bolt Size	Tightening Torque	
	N·m	lb·in
M3	2.0	18
M4	4.6	41
M5	9.6	85
M6	16.4	145
M8	39.0	345
10-32	7.5	66
1/4	18.8	166

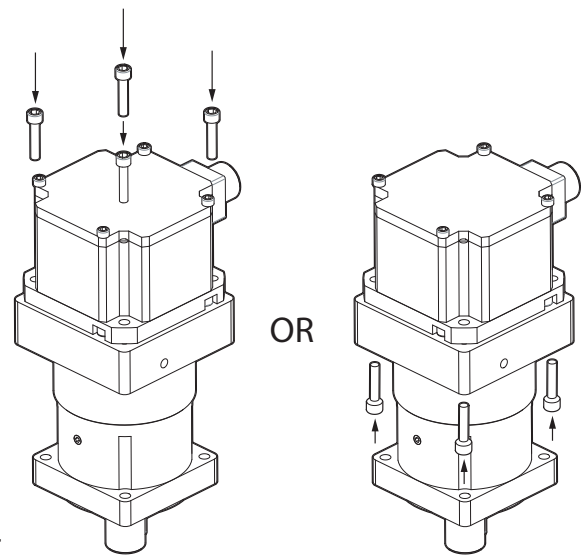

Figure 4

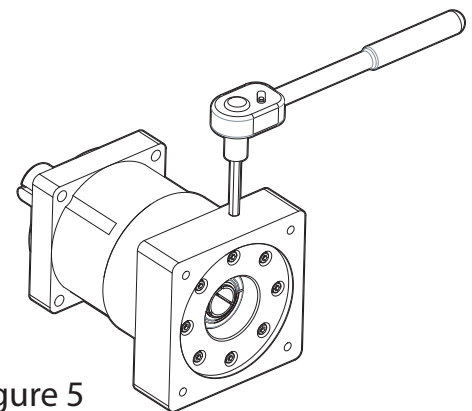

Figure 5