

## Basic ejector

SBP HV 3 16 22 KU

Part no.:10.02.01.01962

<https://www.schmalz.com/10.02.01.01962>

Home > Vacuum Technology for Automation > Vacuum Components > Vacuum Generators > Basic Ejectors > Basic Ejectors SBP-HV/HF With Plastic Main Body > SBP HV 3 16 22 KU

### Basic ejector for universal use



Shape: High Vacuum

Number of stages: 3

Nozzle diameter: 1.6 mm

Size: 22

Degree of evacuation: 90 %

Suction rate (max.): 308.8 l/min

Air consumption suction: 103 l/min

Material: Plastic

### Design Data

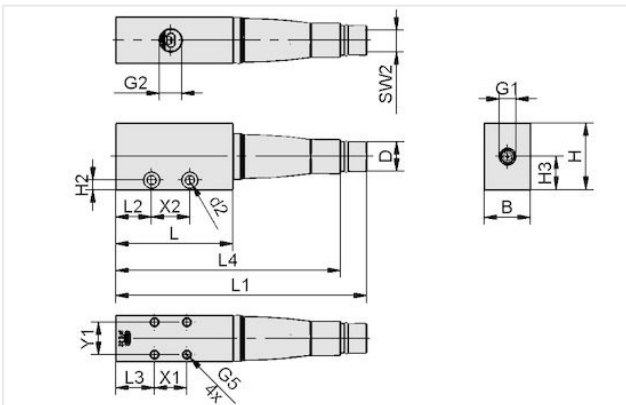

Attribute	Value
B	31.50 mm
d2	6.20 mm
D	20 mm
G1	G1/4"-F
G2	G3/8"-F
G5	M6-F
H	45 mm
H2	6.50 mm
H3	22.50 mm
L	80 mm
L1	171 mm
L2	24.50 mm
L3	26.50 mm
L4	153 mm
SW2	14 mm
X1	22 mm
X2	26 mm
Y1	22 mm

### Technical Data

#### Contact Schmalz

Schmalz Inc. | 5850 Oak Forest Drive, Raleigh, NC 27616, United States | +1 (919) 713-0880 | [schmalz.us@schmalz.com](mailto:schmalz.us@schmalz.com)

## Basic ejector

SBP HV 3 16 22 KU

Part no...:10.02.01.01962

<https://www.schmalz.com/10.02.01.01962>

Attribute	Value
Nozzle diameter	1.60 mm
Number of stages	3
Degree of evacuation	90 %
Suction rate (max.)	308.80 l/min
Air consumption suction	6.34 m <sup>3</sup> /h
Air consumption suction	103 l/min
Sound level free	80 dB(A)
Sound level suction	72 dB(A)
Pressure range (operating pressure)	2.0 - 6.0 bar
Recomm. internal hose diameter compressed air	6 mm
Recomm. internal hose diameter vacuum	12 mm
Weight	208.40 g
Operating temperature	0 ... 60 °C
Pressure range (operating pressure)	28.8 - 86.8
Suction rate (max.)	10.90 cfm
Air consumption suction	3.64 cfm
Product family	SBP-HV-HF-KU

## Accessories



### SD 29x70 SHC 22

Part no...:10.02.01.01517

External diameter D: 29 mm

Length L: 70 mm

Construction use: Schmalz Holder Cap

Size: 22

## Contact Schmalz

Schmalz Inc. | 5850 Oak Forest Drive, Raleigh, NC 27616, United States | +1 (919) 713-0880 | [schmalz.us@schmalz.com](mailto:schmalz.us@schmalz.com)

## Basic ejector

SBP HV 3 16 22 KU

Part no...:10.02.01.01962

<https://www.schmalz.com/10.02.01.01962>



### SD 29x121.5 SHC

Part no...:10.02.01.01831

External diameter D: 29 mm

Length L: 121.5 mm

Construction use: Schmalz Holder Cap

## Spare parts



### SFE 22 POM

Part no...:10.02.01.01767

Hole diameter: 22 mm

Width B: 31.5 mm

Height H: 45 mm

Length L: 80 mm

Thread G1: G1/4"-F

Thread G2: G3/8"-F

Compressed-air connection: G1/4"-F

Suction cup connection: G3/8"-F



### SEP HV 3 16 22

Part no...:10.02.01.01397

Shape: High Vacuum

Number of stages: 3

Nozzle size: 1.6 mm

Hole diameter: 22 mm

Degree of evacuation: 90 %

Pressure range (operating pressure): 2.0 ... 6.0 bar

Pressure optimal: 4 bar

Suction rate (max.): 308.8 l/min

Air consumption suction: 103 l/min

## Contact Schmalz

Schmalz Inc. | 5850 Oak Forest Drive, Raleigh, NC 27616, United States | +1 (919) 713-0880 | [schmalz.us@schmalz.com](mailto:schmalz.us@schmalz.com)

## Basic ejector

SBP HV 3 16 22 KU

Part no...:10.02.01.01962

<https://www.schmalz.com/10.02.01.01962>



### SHC 3 22

Part no...:10.02.01.01514

Number of stages: 3

Hole diameter: 22 mm

External diameter D: 20 mm

Length L: 73 mm

Thread G1: M27x1.5-M