

Bellows suction cup (round)

SPB1 50 ED-65 G1/4-AG

Part no...:10.01.06.03500

Home > Vacuum Technology for Automation > Vacuum Components > Vacuum Suction Cups > Suction Cups for Packaging > Bellows Suction Cups
 SPB1 (1.5 Folds) > SPB1 50 ED-65 G1/4-AG

Bellows suction cup (round) for very uneven workpieces



Size: 50

Suction cup material: Elastodur

Material hardness [Shore A]: 65 Shore A

Thread G1: G1/4"-M

Number of folds: 1.5

Design Data

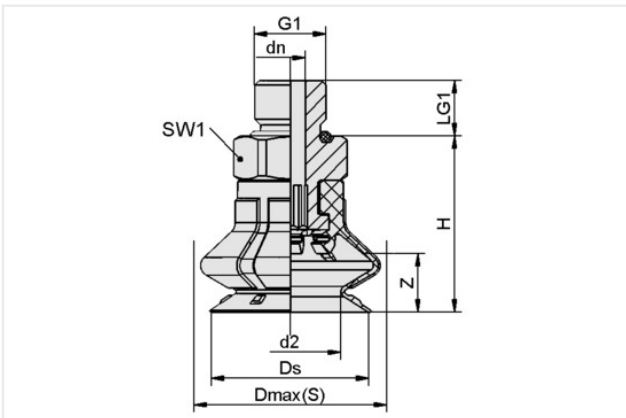

Attribute	Value
d2	32.30 mm
dn	6.10 mm
Dmax(S)	58.40 mm
Ds	51.40 mm
G1	G1/4"-M
H	39.20 mm
LG1	10 mm
SW1	17 mm
Z (Stroke)	18 mm

Technical Data

Attribute	Value
Suction force (-600mbar)	54.70 N
Pull-off force	72.70 N
Lateral force	31.20 N
Volume	30.18 cm ³
Curve radius (min) (convex)	100 mm
Hose diameter (empf.) d	6 mm
Size	50
Number of folds	1.50

Bellows suction cup (round)

SPB1 50 ED-65 G1/4-AG

Part no...:10.01.06.03500

Suction cup material	Elastodur
Material hardness [Shore A]	65 Shore A
Weight	26.30 g
Product family	SPB1

Accessories



SIEB 17.5x0.8 MS-A2 280 0.28/0.16

Part no...:10.07.01.00308

External diameter D: 17.5 mm

Length L: 0.8 mm

Material: Brass / Stainless steel

Filter pore size: 280 µm



SPI 40 PA SPB1-50

Part no...:10.01.06.03388

Size: 40

Material: Polyamide

Use: SPB1-50

Spare parts

Bellows suction cup (round)

SPB1 50 ED-65 G1/4-AG

Part no...:10.01.06.03500



SC 050 G1/4-AG

Part no...:10.01.06.02487

Connection geometry: 50

Connection: G1/4"-M

Length L1: 26.5 mm

Fitting length: 7.2 mm

Nominal diameter dn: 6.1 mm



SPB1 50 ED-65 SC050

Part no...:10.01.06.02456

Size: 50

Suction cup material: Elastodur

Material hardness [Shore A]: 65 Shore A

Number of folds: 1.5