

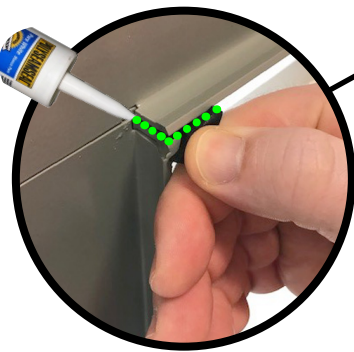

CENTER CHANNEL REINSTALLATION

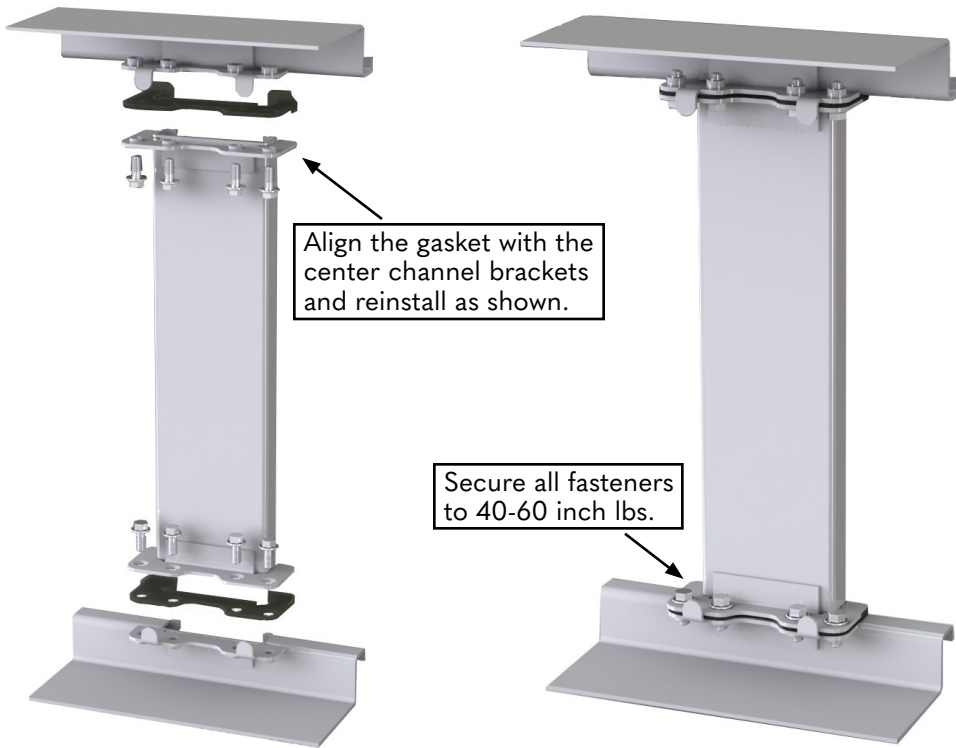

-Apply sealant (RTV or similar) to just the inside left and right sides of both the top and bottom gasket surface.

-Gently peel back gasket and add sealant to door opening seams. 
*Shown in green dots ●●●●●

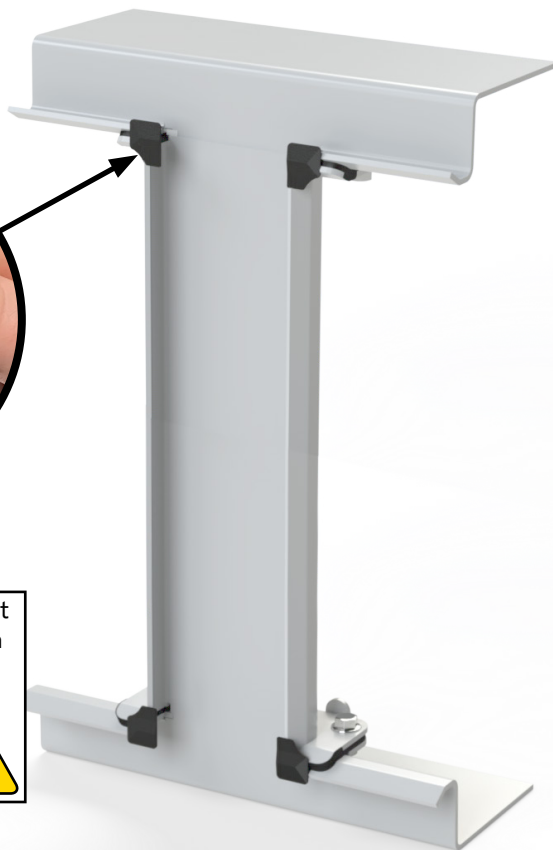

14 Gauge Enclosures

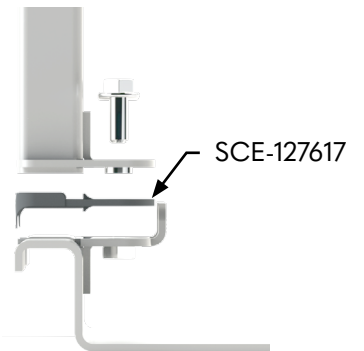

11/12 Gauge Enclosures
90° Flange Trough Collar

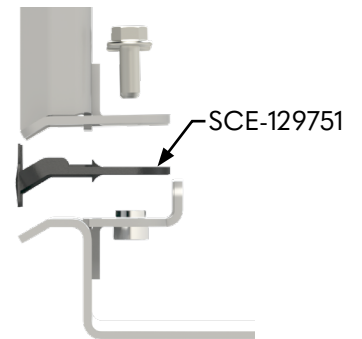

12 Gauge Enclosures
30° Flange Trough Collar