

# HD PANEL SUPPORTS & CENTER PANEL SUPPORT

"SHOWN INSTALLED IN A TWO DOOR FS ENCLOSURE"

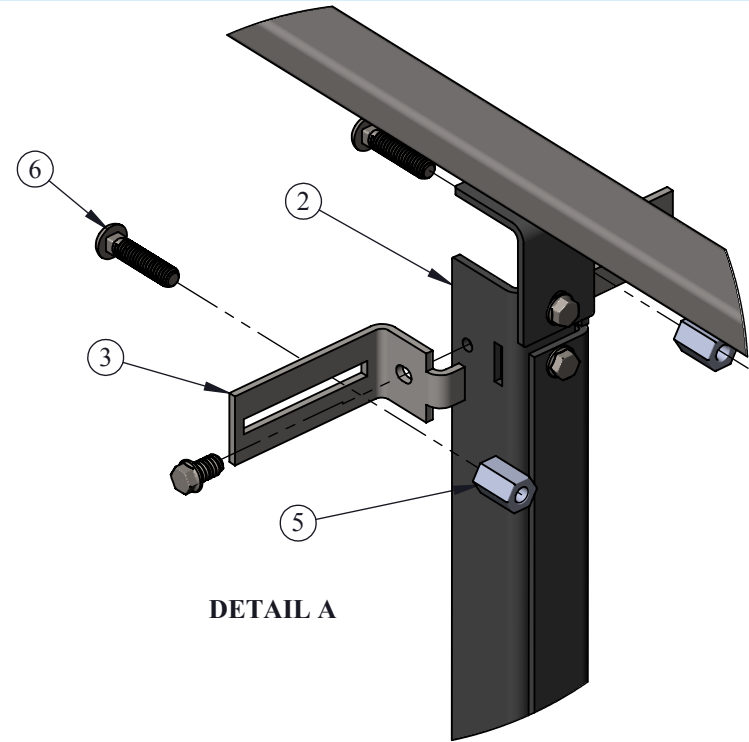
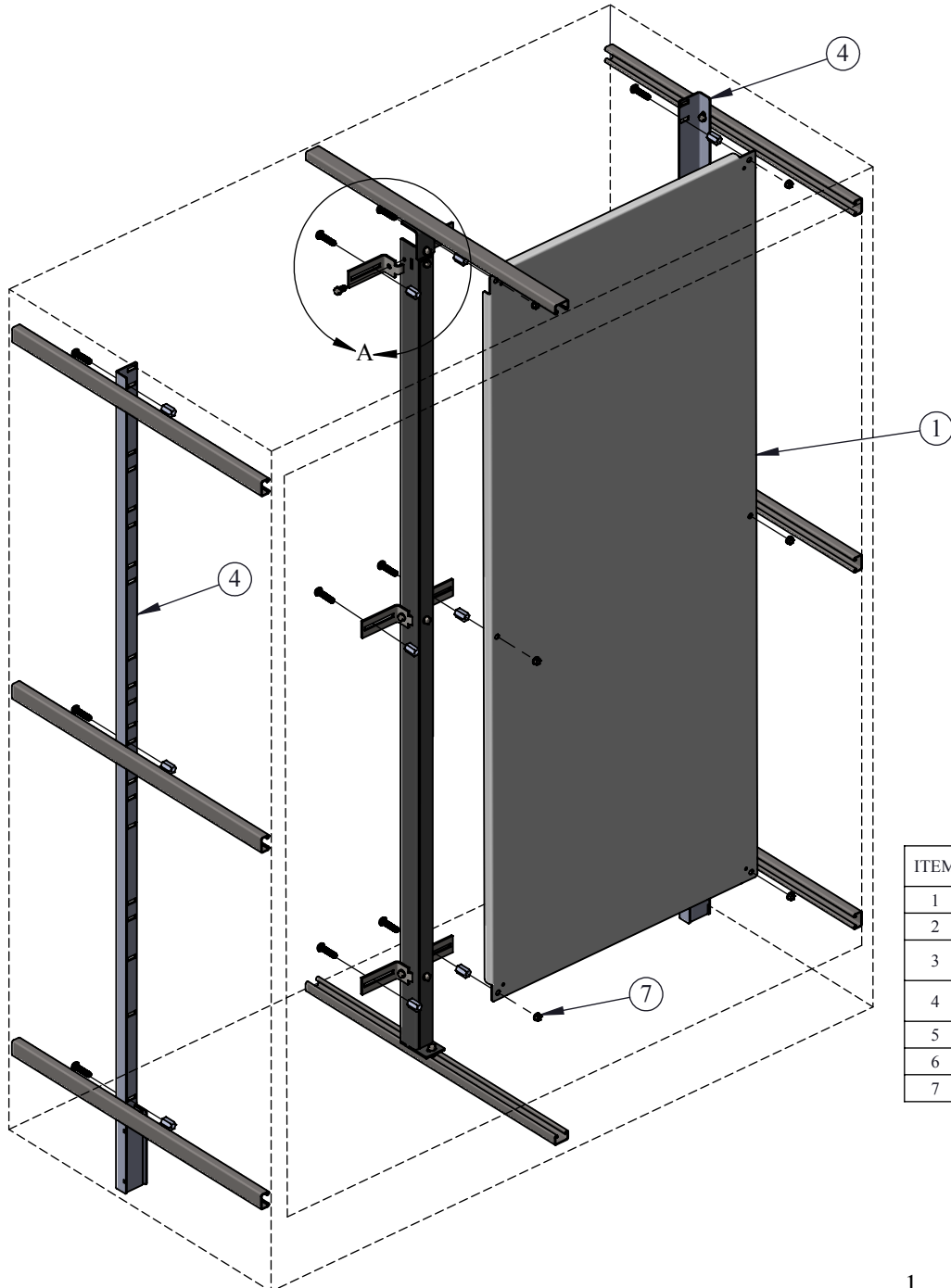

DETAIL A

## INSTALLATION INSTRUCTIONS

**STEP 1:** FIRST INSTALL CENTER PANEL SUPPORT (ITEM 2) IN THE ENCLOSURE USING HARDWARE INCLUDED IN BOLT PACK 102027 (SEE CENTER PANEL SUPPORT INSTALL MANUAL IF NEEDED).

**STEP 2:** INSTALL HD PANEL SUPPORTS (ITEM 4) TO THE MOUNTING CHANNELS INSIDE OF ENCLOSURE WHERE NEEDED (LEFT, RIGHT OR BOTH SIDES) USING HARDWARE INCLUDED IN BOLT PACK 102028. THEN ATTACH INDIVIDUAL PANEL SUPPORT (ITEM 3) IN SLOT ON CENTER PANEL SUPPORT USING HARDWARE PROVIDED (SEE **DETAIL A**)

**STEP 3:** ATTACH COUPLING NUTS AND CARRIAGE BOLTS (ITEMS 5 & 6) TIGHTLY TO PANEL SUPPORTS WHERE NEEDED. USE 4 PER HALF PANEL, 6 PER FULL PANEL.

**STEP 4:** INSTALL PANEL(S) (ITEM 1) USING SERRATED FLANGED NUTS (ITEM 7).

ITEM	PART NAME
1	FULL PANEL
2	CENTER PANEL SUPPORT
3	INDIVIDUAL PANEL SUPPORT
4	HEAVY DUTY PANEL SUPPORT
5	COUPLING NUTS
6	CARRIAGE BOLTS
7	SERRATED FLANGED NUTS