

# PRODUCT INFORMATION PACKET



Model No: 056H17T2011

Catalog No: Y500

Speed Ratio Motor, 0.25 HP, 3 Ph, 60 Hz, 230 V, 1800 RPM, 56C Frame, TENV



Regal and LEESON are trademarks of Regal Rexnord Corporation or one of its affiliated companies.  
©2025 Regal Rexnord Corporation, All Rights Reserved. MC017097E





### Nameplate Specifications

Phase	<b>3</b>	Output HP	<b>0.25 Hp</b>
Output KW	<b>0.19 kW</b>	Voltage	<b>230 V</b>
Speed	<b>1725 rpm</b>	Service Factor	<b>1.00</b>
Frame	<b>56C</b>	Enclosure	<b>Totally Enclosed Non Ventilated</b>
Thermal Protection	<b>No Protection</b>	Efficiency	<b>72 %</b>
Ambient Temperature	<b>40 °C</b>	Frequency	<b>60 Hz</b>
Current	<b>1.0 A</b>	Power Factor	<b>65</b>
Duty	<b>Continuous</b>	Insulation Class	<b>H</b>
Design Code	<b>INV</b>	KVA Code	<b>M</b>
Drive End Bearing Size	<b>6203</b>	Opp Drive End Bearing Size	<b>6203</b>
UL	<b>Recognized</b>	CSA	<b>Y</b>
CE	<b>Y</b>	IP Code	<b>43</b>
Number of Speeds	<b>1</b>		

### Technical Specifications

Electrical Type	<b>Squirrel Cage Inverter Duty</b>	Starting Method	<b>Inverter Only</b>
Poles	<b>4</b>	Rotation	<b>Reversible</b>
Resistance Main	<b>64.1 Ohms</b>	Mounting	<b>Rigid Base</b>
Motor Orientation	<b>Horizontal</b>	Drive End Bearing	<b>Ball</b>
Opp Drive End Bearing	<b>Ball</b>	Frame Material	<b>Rolled Steel</b>
Shaft Type	<b>NEMA 56</b>	Overall Length	<b>9.91 in</b>
Frame Length	<b>6.25 in</b>	Shaft Diameter	<b>0.625 in</b>
Shaft Extension	<b>2.06 in</b>	Assembly/Box Mounting	<b>F1 ONLY</b>
Inverter Load	<b>CONSTANT 1000:1</b>		
Outline Drawing	<b>A-SS403144-625</b>	Connection Drawing	<b>A-EE7300HX</b>

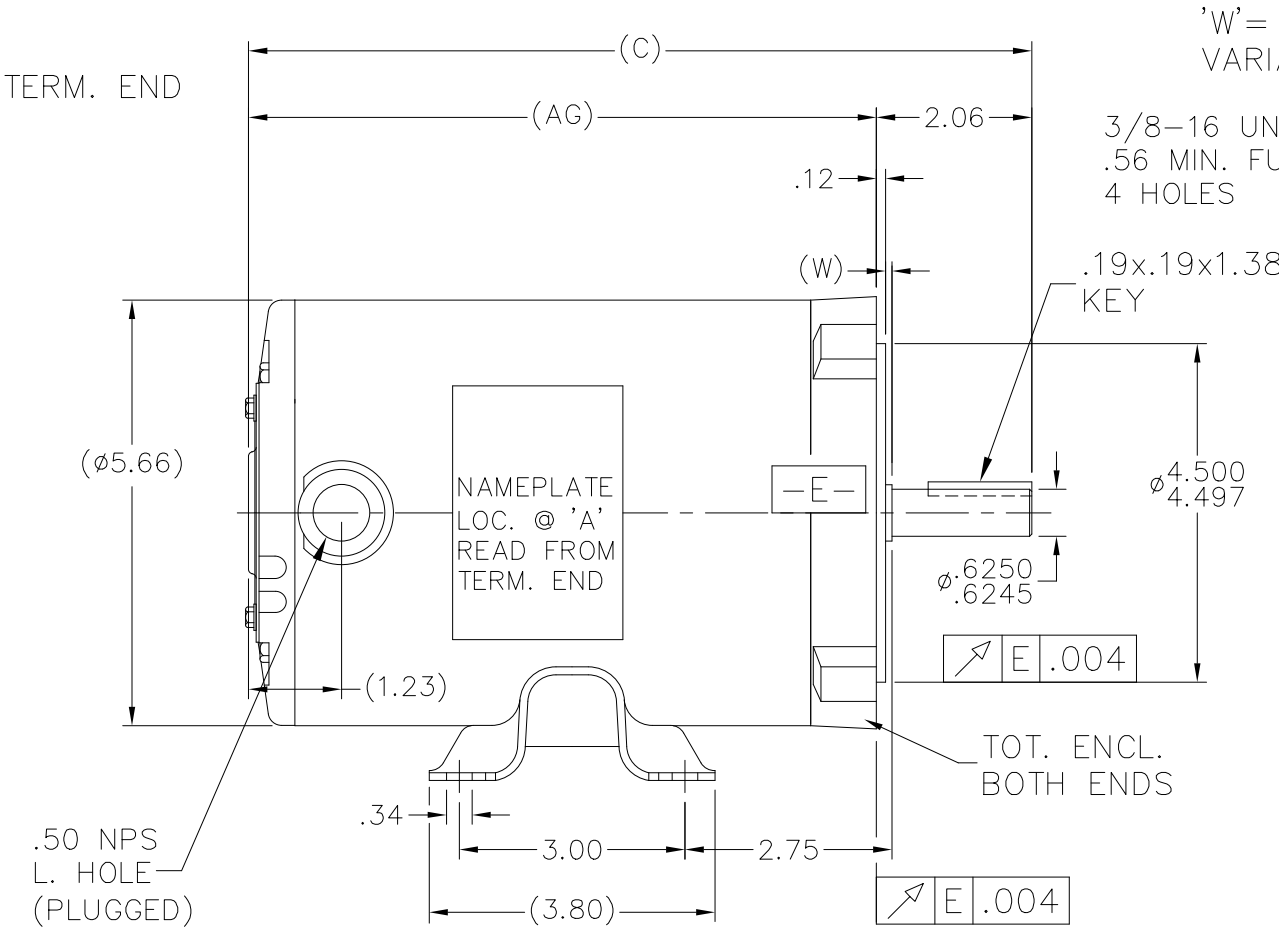

'W' = CLEARANCE ALLOWED FOR ALL VARIANCES IN MANUFACTURING & ASSEMBLY

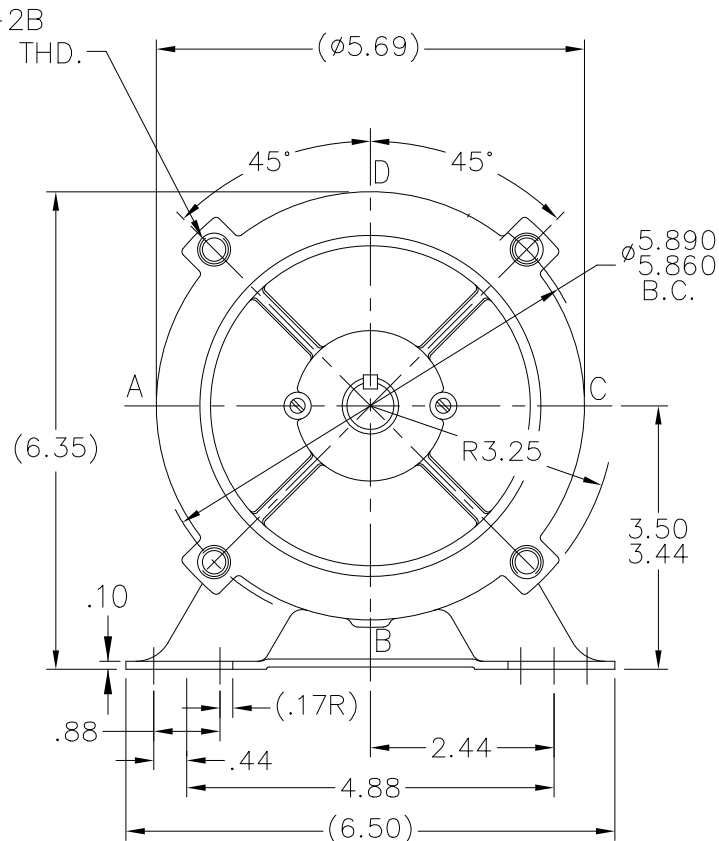

DASH	FR	C	AG		DASH	FR	C	AG		DASH	FR	C	AG	
550	56	9.16	7.10	01-17-2002	650	56	10.16	8.10		725	56	10.91	8.85	
600	56	9.66	7.60		675	56	10.41	8.35		750	56	11.16	9.10	
625	56	9.91	7.85		700	56	10.66	8.60		775	56	11.41	9.35	

				TOLERANCES UNLESS SPECIFIED		Regal Rexnord		Regal Beloit America, Inc.		DRAWN NJS 05-11-2001			
				DEC.	INCHES					CHK	ML 05-11-2001		
4	CHD FROM MARATHON TO RRX LOGO			KVDG 05-28-2024	DS	.X	±.1	TITLE OUTLINE		APPD	TOM 05-14-2001		
3	REVISED "C" & "AG" DIMS	ISAAC10-2047		TJW 7/27/2010	CTO	.XX	±.03			SCALE	3=8		
2	REDRAWN IN AUTOCAD			TAT 07-06-2004	ML	.XXX	±.005	MAT'L.		REF			
1	NEW DRAWING	MU37179		NJS 05-14-2001		.XXXX	±.0005			FINISH			
NO.	REVISION			BY & DATE	CHK	ANG	±7'30"			PREV			
THIS DRAWING IN DESIGN AND DETAIL IS OUR PROPERTY AND MUST NOT BE USED EXCEPT IN CONNECTION WITH OUR WORK ALL RIGHTS OF DESIGN AND INVENTION ARE RESERVED THIS IS AN ELECTRONICALLY GENERATED DOCUMENT - DO NOT SCALE THIS PRINT				RFP	CAD FILE ss403144				SIZE	DRAWING NO.	PAGE	OF	REV.
				DIST	WP	3 of 8				A	SS403144	4	4

THREE PHASE – SINGLE VOLTAGE MOTOR

TO REVERSE ROTATION:  
INTERCHANGE ANY TWO LINE  
LEAD CONNECTIONS

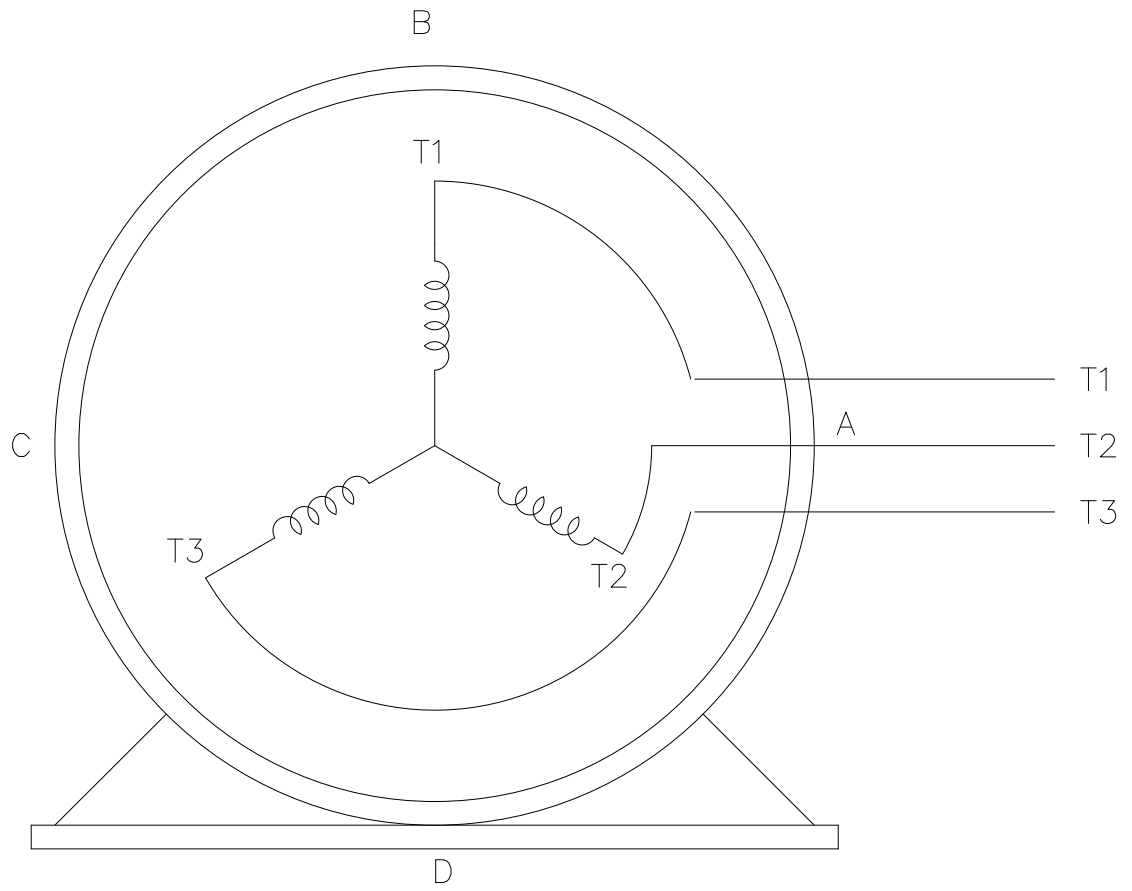

VIEW OF TERMINAL END

TERMINAL BOARD  
WHEN SPECIFIED

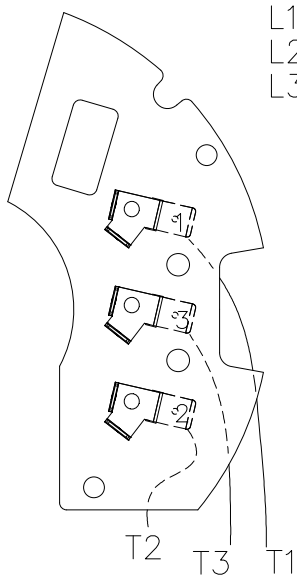

L1 TO 1  
L2 TO 2  
L3 TO 3

DRAWING REVISION D	REVISION BY GKB	REV DATE/ © DATE 04/15/2025	TOLERANCES (EXCEPT AS NOTED): DEC. INCH — mm ANGLE .X ±0.1 [±3] ±0.5° .XX ±0.01 [±0.3] .XXX ±0.005 [±0.13] .XXXX ±0.0005 [±0.013] REMOVE BURRS & BREAK SHARP EDGES: .003/.015 [.08/.38] X 45 CORNER FILLETS: R.02 [.5] MACHINED SURFACES: 125/ 3.2/ mm/ INCH ✓	DRAWN BY NJS	Regal Beloit America, Inc.	
REQUEST NUMBER ECR-0242041	APPROVED BY RK	DATE 04/15/2025		DATE 06/18/2001		
REQUEST NUMBER DESCRIPTION CHANGED FROM MARATHON TO RRX TEMPLATE			APPROVED BY GK	DESCRIPTION CONNECTION DIAGRAM SINGLE VOLT - 3Ø MOTOR	PROCESS/FINISH	
COPYRIGHT (PER REVISION DATE) REGAL BELOIT AMERICA, INC. ALL RIGHTS RESERVED. PROPRIETARY AND CONFIDENTIAL INFORMATION - THIS DOCUMENT IS THE PROPERTY OF REGAL BELOIT AMERICA, INC. ("OWNER") AND CONTAINS OWNER'S PROPRIETARY INFORMATION. ANY PERSON, CORPORATION OR OTHER FIRM RECEIVING IT IS DEEMED, BY RECEIVING IT, TO AGREE THAT IT, AND/OR ANY PART OF IT, SHALL NOT BE DISCLOSED TO ANY PERSON, CORPORATION OR OTHER ENTITY, DUPLICATED, AND/OR USED, EXCEPT AS EXPRESSLY APPROVED IN WRITING IN ADVANCE BY OWNER. THIS DOCUMENT SHALL BE RETURNED TO OWNER UPON REQUEST. IT MAY BE SUBJECT TO CERTAIN RESTRICTIONS UNDER APPLICABLE EXPORT CONTROL LAWS AND REGULATIONS.			DATE 06/19/2001	MAT'L		
						REFERENCE



NONE	P/N	NONE	
NONE	NONE		
NONE FT-LB		NONE V	NONE Hz

DATE: 06/28/2017 01:10:36 AM  
FORM 3531 REV.3 02/07/99  
\*\* Subject to change without notice.

Data Sheet

Date: 8/23/2017  
 Customer: \_\_\_\_\_  
 Attention: \_\_\_\_\_  
 Submitted by: VINAYAK YERATE



56H17T2011

Submittal

Data @ 230 V

Motor Load Data

Load	0%	25%	50%	75%	100%	115%	125%	LR
Current (Amps)	0.70	0.76	0.80	0.90	1.00	1.04	1.10	7.0
Torque (ft-lb)	0.00	0.18	0.37	0.55	0.76	0.88	0.96	3.5
RPM	1800	1780	1760	1740	1725	1,715	1705	0
Efficiency (%)		45.5	62.5	70.0	72.0	74.0	74.0	
P.F. (%)	17.0	32.0	45.0	57.0	65.0	70.0	72.5	75.0

Motor Speed Data

	LR	Pull-Up	BD	Rated	Idle
Speed (RPM)	0	500	975	1725	1800
Current (Amps)	7.0	6.4	5.0	1.00	0.70
Torque (ft-lb)	3.5	3.2	3.7	0.76	0.00

Information Block

HP	0.3			
Sync. RPM	1800			
Frame	48			
Enclosure	TENV			
Construction	TTR			
Voltage	230 V			
Frequency	60 Hz			
Design	B			
LR Code letter	M			
Service Factor	1.15			
Temp Rise @ FL	45 °C			
Duty	CONT			
Ambient	40 °C			
Elevation	1,000 feet			
Rotor/Shaft wk <sup>2</sup>	0.04 Lb-Ft <sup>2</sup>			
Ref Wdg	TE48428 R2			
Sound Pressure @ 1M	62 dBA			
VFD Rating	CONSTANT 1000:1			
Outline Dwg	A-SS403144-625			
Conn. Diag	A-EE7300HX			
Additional Specifications:				
0				
0				
EQUIV CKT (OHMS / PHASE)				
R1	R2	X1	X2	Xm
9.2470	7.1480	9.0770	4.2830	170.1880

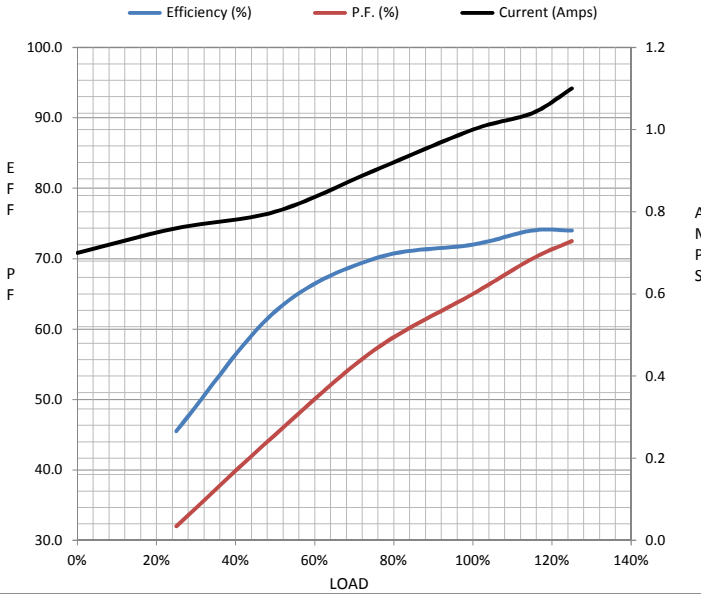

Speed - Torque Curve

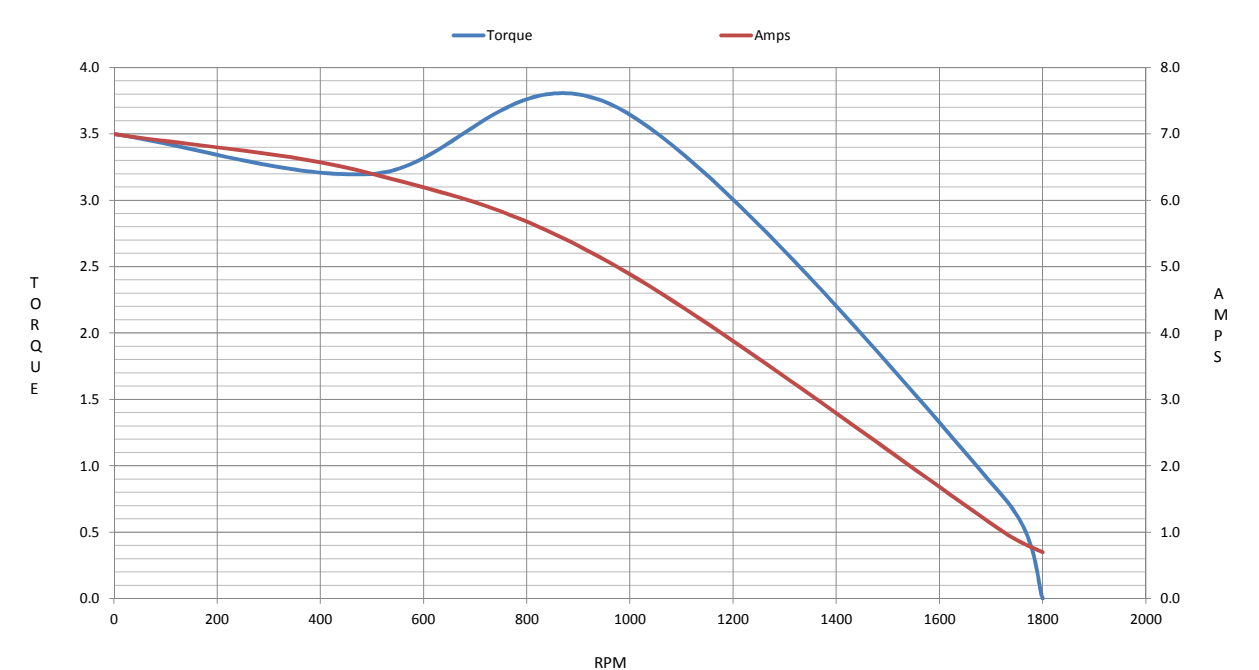

REV 1 - CHANGED HEADER FROM MARATHON TO LESSON - 8/4/2025

## EC Declaration of Conformity

The undersigned representing  
the manufacturer:

Regal Beloit America  
1946 West Cook Road  
Fort Wayne, IN 46818

and the authorized representative  
established within the Community:

Regal Beloit Italy  
Via Modena, 18  
24040 Ciserano(BG) - Italy

are committed to providing customers with products that comply with applicable regulations and international protocols to which they are subject, including the requirements of the European Parliament Directive on the Harmonization of the laws relating to electrical equipment designed for use within certain voltage limits (2014/35/EU).

Regal Beloit America declares that the following product(s), to which this declaration relates, are in conformity with the relevant sections of the EC standards listed below.

This statement supersedes any statements previously issued pertaining to the product(s) listed below and is subject to change without notice.

Model No : 056H17T2011

(Model No. may contain prefix and/or suffix characters)

Catalog No : Y500

Rework No : N/A

Directives :

Low Voltage Directive 2014/35/EU

Harmonized Standards Used :

EN 60034-1: 2010 (IEC 60034-1: 2010)

EN 60034-5: 2001/A1:2007 (IEC 60034-5: 2000/A1:2006)

Authorized Representative:



Zach Stauffer  
Vice President, Engineering

Authorized Representative in the Community:



Stefano Casiraghi  
Technology Director, Engineering

Created on 07/08/2025

**CE 25**