

*Thank you! We appreciate the confidence and trust you have placed in Automation Direct through the purchase of this convenience outlet.*



### SPECIFICATION

Voltage Rating: **125V**  
Current Rating: **15A**  
Total Current Rating: **15A**  
Outlet Type: **Receptacle Dual USB Charger Type C + C, Black**  
USB Ports: **Dual Type C**  
USB Rating: **Class 2, 5V, 3.1 A**  
Mounting: **Panel or 35mm DIN Rail**  
Wire Size Capacity: **12 - 14 AWG**  
Wire Strip Length: **0.24- 0.28 in (6 - 7 mm)**  
Wire Type: **Copper or Copper Clad**  
Tightening Torque: **4.5 lb-in (0.51 N.m)**  
Operating Temperature: **32 - 122°F (0 - 50 °C)**  
Humidity: **5 to 95% (non-condensing)**  
Altitude: **2,000 meters max**  
Environmental Air: **No corrosive gases permitted**  
Pollution Degree: **II**  
Enclosure Type: **Open Equipment**  
Circuit Protection: **Not built into module: Install protection element such as a 20A Fuse or Single Pole Circuit Breaker.**  
RoHS Compliant: **No**  
UL Standard: **UL508 and CSA C22.2 No. 14 File E551575, Canada & USA**

### READ BEFORE USE

**USE EXTREME CAUTION** when doing electrical wiring to avoid injury due to electric shock. Automation Direct assumes the operator of this product has basic knowledge of electricity and will not be liable for any injury or damages due to improper use.

**OBSERVE AND FOLLOW** all standard electrical codes and industry safety rules. When necessary, call a qualified electrician to install and test this convenience outlet.

**CHECK SPECIFICATION.** Make sure the outlet is installed in accordance with this product's specifications.

**DO NOT SERVICE** this product if you are not qualified to do so.

### PRODUCT DESCRIPTION

This two-receptacle DIN Rail (or Panel) mounted USB port outlet is used for powering laptop computers, test equipment and other electrical devices.

The GR-REC2-USB-2C is a 125VAC, 15A rated convenience outlet with two USB Type C charging ports.

### OPERATION

1. Mount the outlet on the 35mm DIN rail (or panel).
2. Check the markings at the terminal side and make sure they match your electrical wiring.
3. If your device doesn't work after plugging in, turn off all power to the outlet and disconnect all the wires immediately.
4. Repair your wiring and check the "Wiring Installation" instructions again.
5. If the problem persists, please contact Automation Direct for technical support.

### MECHANICAL DRAWING (All dimensions are in mm)

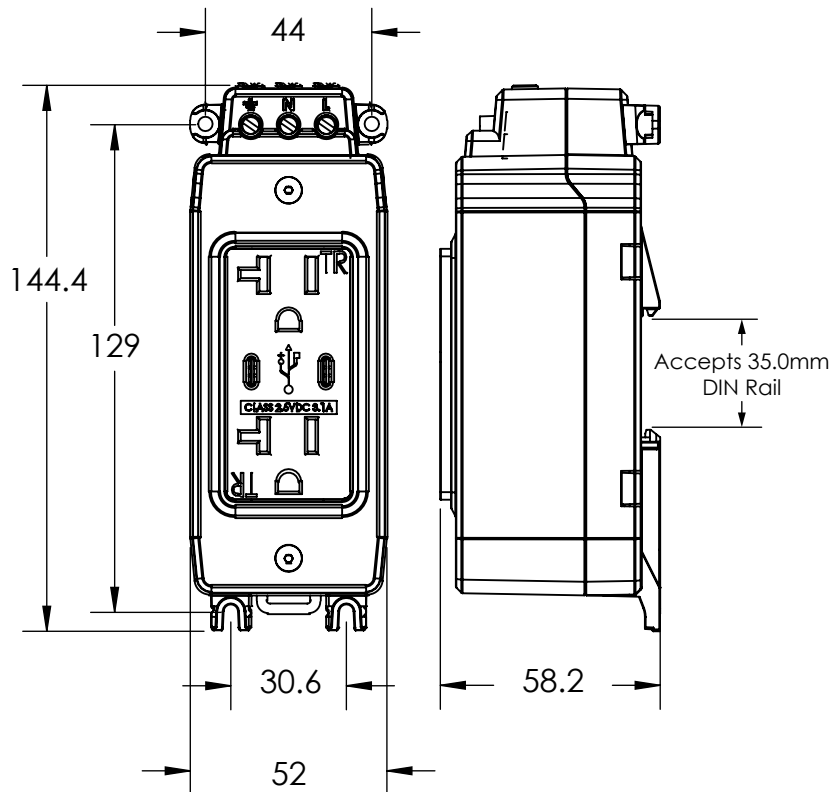

Document Name	Edition/Revision	Date
GR-REC2-USB-2C-DS	1st Edition	2/2/2026

## INSTALLATION

- Hold the device against the DIN rail, parallel to the mounting surface.
- Apply even pressure against the DIN rail until the device is secured to the rail. ①
- You should hear a definite “click” to indicate that the device has locked onto the rail. ②
- Apply pressure by pulling the device away from the mounting surface to ensure that the device is secure. ③

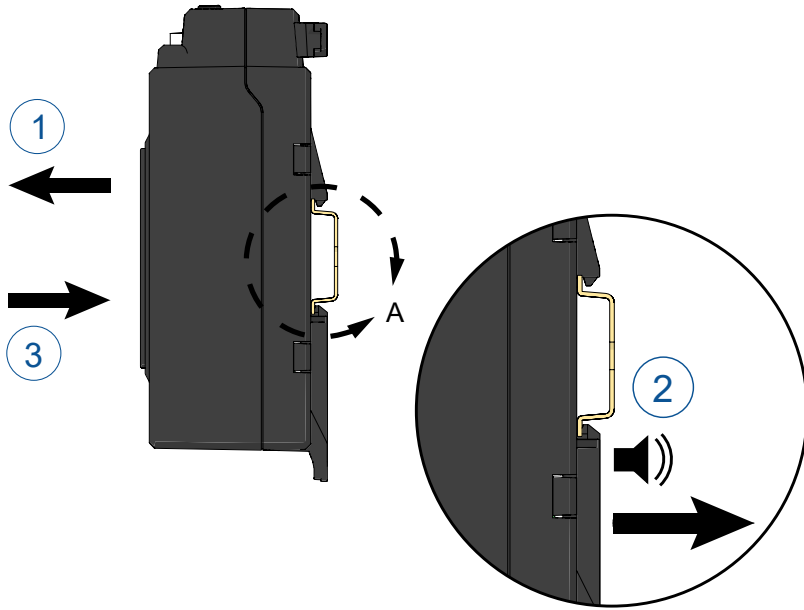

## ALTERNATE INSTALLATION

- Tilt the device slightly to hang the upper clamp onto the DIN rail. ④ Then, apply pressure to the bottom end of the device to snap the bottom clamp onto the rail. ⑤
- You should hear a definite “click” to indicate that the device has locked onto the rail. ②
- Apply pressure by pulling the device away from the mounting surface to ensure that the device is secure. ③

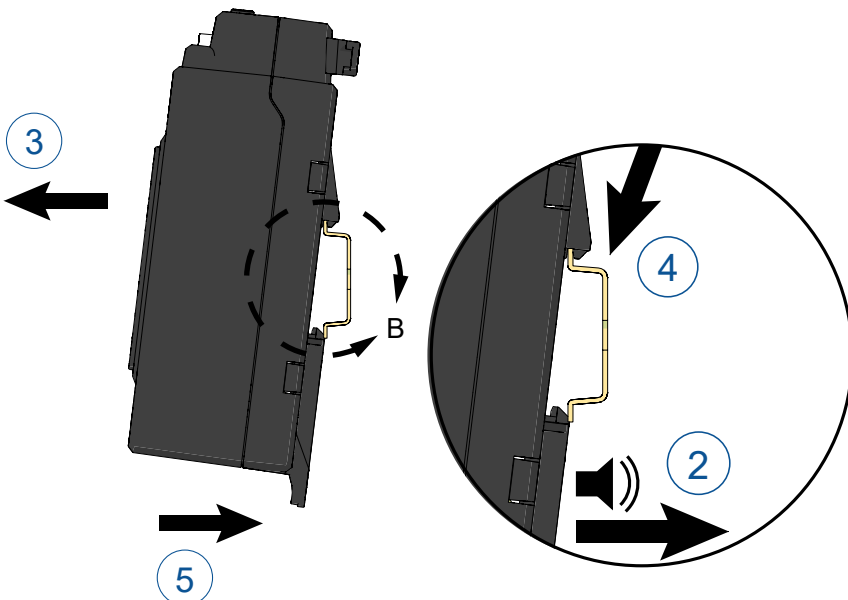

## REMOVAL OF THE DEVICE

- Turn off power to the device and unplug any equipment left connected to the device. ⚠
- Disconnect all power wiring.
- To remove the device from the DIN rail, apply upward pressure to the bottom of the device until the top clamp releases from the rail. ⑥ Then, pull the top away from the mounting surface. The device can then be lowered from the rail and pulled away. ⑦

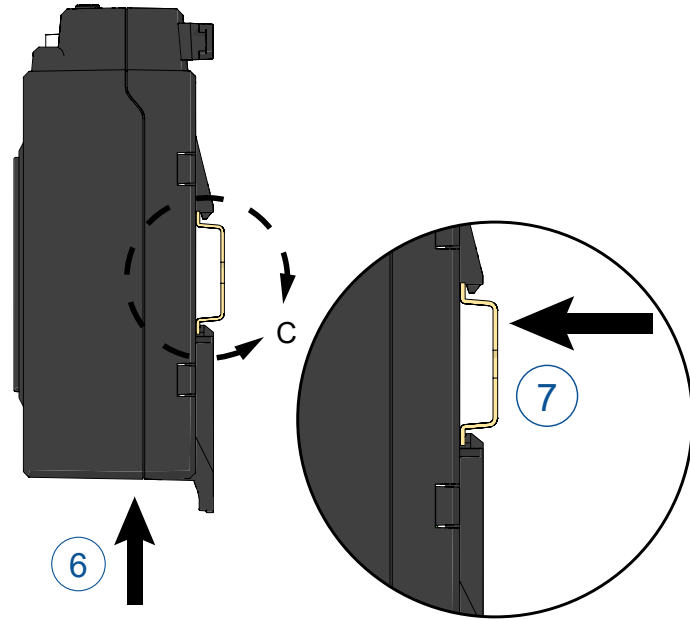

## WIRING INSTRUCTION

1. Check the correct wiring termination below and make sure they match your electrical wiring.
2. Make sure the terminal screws are properly tightened before powering the outlet on.

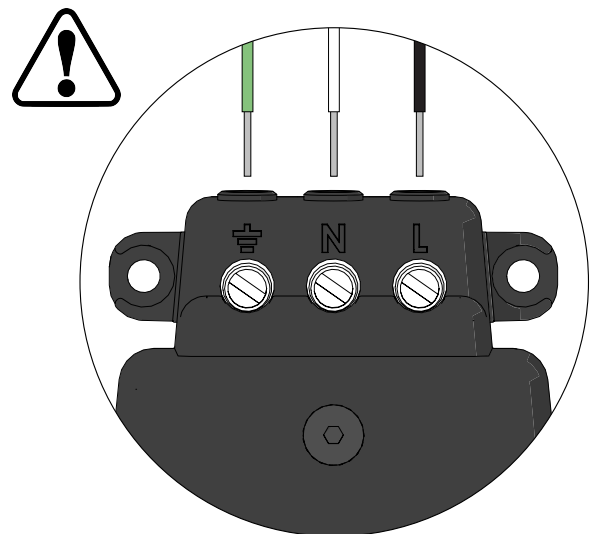

"L" Symbol for **LINE/BLACK** connection  
 "N" Symbol for **NEUTRAL/WHITE** connection  
 "⏏" Symbol for **GROUND/GREEN** connection