

Installation Instructions:

The DPM-BKT1 is used to mount a DPM2 or DPM3 panel meter on DIN rail EN50022 or EN50035 or on a vertical wall.

The DPM-BKT1 also allows desktop mounting in a horizontal position or angled upwards or downwards by 7° or 14°.

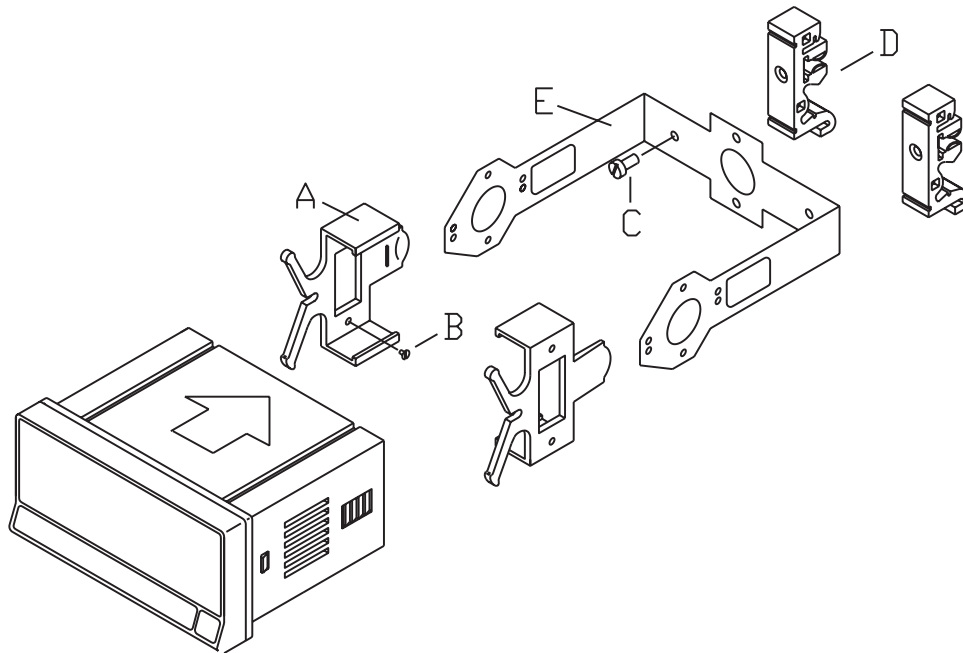

Installation Instructions:

The DPM-BKT1 kit includes:

- A. 2 mounting clips.
- B. 4 screws M3 x 6 DIN 963 to attach the clips to the inside of the arms of part E.
- C. 2 screws M4 x 8 DIN 84 to attach DIN rail clips to part E.
- D. 2 DIN rail clips (DIN rail EN50022 or EN50035).
- E. 1 metal bracket.

After attaching pieces A and D to part E (see figure), insert the panel meter until the clips engage and the meter is held in place.

To disassemble lift the rear tab on the two A clips. Tabs are accessible through the holes in the side of bracket E. While the tabs are lifted, pull forward on the panel meter to slide out and detach.