



XTH Series Head Mounted RTD and TC Temperature Transmitters - Fixed Range



XTH Series - Fixed Range

Installation

- Transmitter comes with installation screw kit for both North American and European installations
- Ambient Temperature: -40 to 185°F (-40 to 85°C)
- Installation area: Field housing; connection head Form B according to DIN 43729
- Installation angle: No limit

Note: Max. torque 3/4 pound-feet (1 Nm)

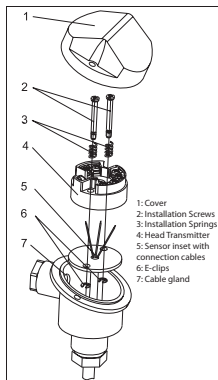

European installation

Dimensions

inches [mm]

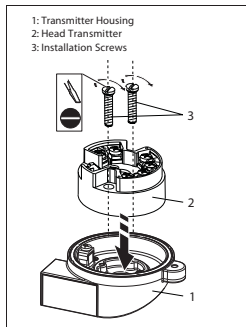
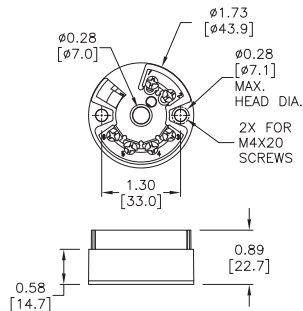

North American installation

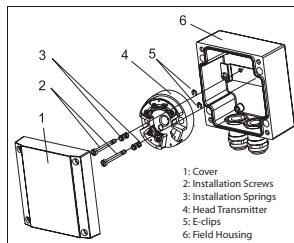

Remote Installation of head transmitter into field housing

Wiring

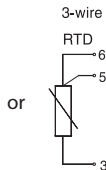
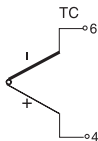
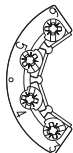
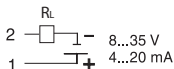
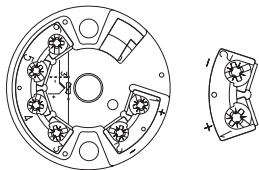

Note: Thermocouple or RTD input depending on model

Safety instructions:

- To comply with UL61010-1 unit must be supplied by class 2 power supply.
- Disconnect power before making connections

Load Impedance

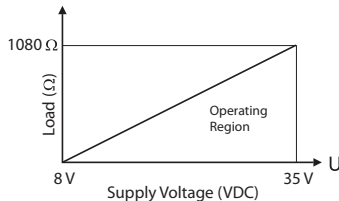

$$RL_{max} = (V_{powersupply} - 8V) / 0.025A \text{ (current output)}$$

$$\text{e.g. } (24V - 8V) / 0.025A = 640 \Omega$$

Shielding

Please take note when installing the head transmitter remotely from the sensor in a field housing: The shield on the 4-20 mA signal output must have the same potential as the shield at the sensor connections. When using grounded thermocouples, shielding of the output 4 to 20 mA cable is recommended. In plants with strong electromagnetic fields, shielding of all cables with a low ohm connection to the transmitter housing is recommended.

Due to the danger of lightning strikes it is recommended that shielded cable be used in installations outside of buildings.



XTH product insert Rev. 1

Please visit www.automationdirect.com for specifications and additional information.