

Recessed Frame

HNFX03 – HNFX04 – HNF05 – HNFX06



MOUNTING

Fig.1 Kit, Parts

- 1 Aluminum Alloy frame No 1 pc.
- 2 Side closing No 2 Pcs
- 3 Screws M6x10 - A2 - TSPEI DIN7991 No. 4 pcs

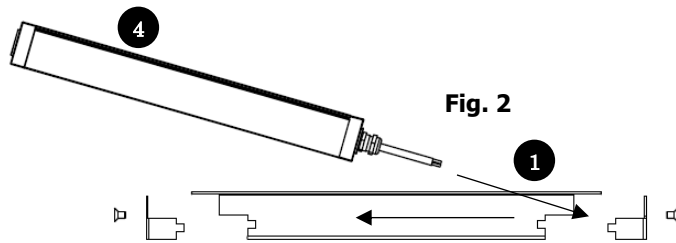
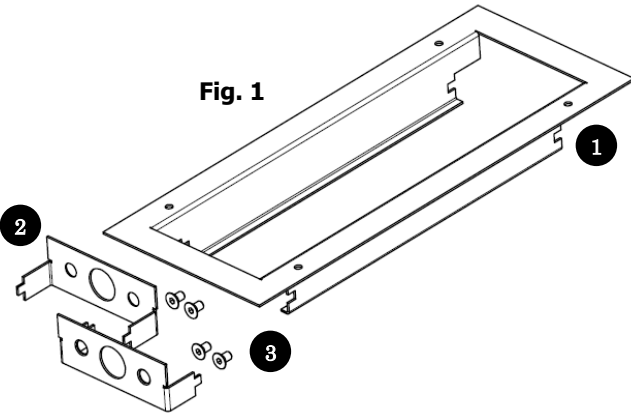

Fig.2 Inset fixture 4 into the frame 1 from front window.

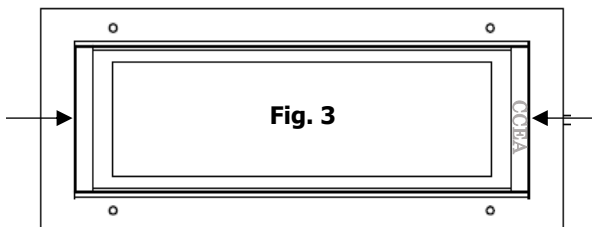

Fig.3 Fixture must be laid down on the frame bottom and centered in the front window frame.

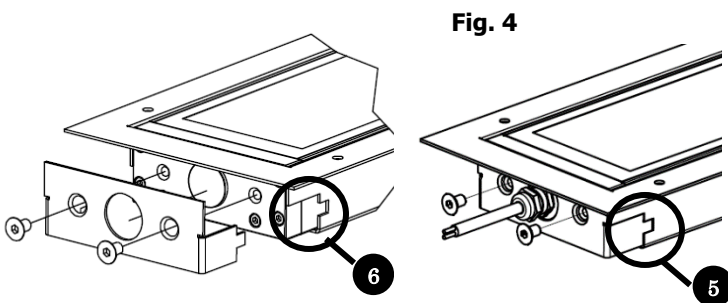

Fig.4 Mount the Two closing part making sure that side pins 5 and 6 have properly inserted into frame slots. Screw M6x10 screws to tighten closing parts to the fixture.