



L82M, L82C - Excelon® Plus Modular System Micro and oil fog lubricator

- > Port size: 1/4" & 3/8" (ISO G/PTF)
- > Excelon® Plus design allows in-line installation or modular installation with other Excelon® Plus products
- > Flow sensor provides a nearly constant oil/air ratio over a wide range of flows
- > Double safety lock bowl
- > Metal bowl with prismatic liquid level indicator lens
- > Light weight Polycarbonate bowl
- > All round (360°) visibility of sightdome for ease of drip rate setting
- > Choice of two oil delivery systems



Technical features

Medium:

Compressed air only
Maximum operating pressure:
Polycarbonate bowl: 145 psi (10 bar)
Metal bowl: 246 psi (17 bar)

Port size:

G1/4, G3/8, 1/4 PTF, 3/8 PTF

Flow:

L82C: 55 scfm (26 dm³/s) at port size 1/4"
L82C: 51 scfm (24 dm³/s) at port size 3/8"
L82M: 46 scfm (22 dm³/s) at port size 1/4"
L82M: 45 scfm (21 dm³/s) at port size 3/8"
operating pressure: 91 psi (6.3 bar)
and a Δp: 7.25 psi (0.5 bar) drop from set.

Start point:

1 scfm (0.5 dm³/s) for Oil Fog
2.5 scfm (1.2 dm³/s) for Micro Fog

Ambient/Media temperature:

Polycarbonate bowl:
14 to +140°F (-10 to +60°C)
Metal bowl:
-4 to +149°F (-20 to +65°C)
Air supply must be dry enough
to avoid ice formation at
temperatures below +35°F (+2°C)

Materials:

Body: Die cast aluminium
Body cover: ABS
Bowl: Transparent PC with PP guard or die cast zinc
Liquid level indicator lens (metal bowl): PA
Sightdome: Transparent PA
Bowl "o"- ring: Chloroprene
Elastomers: NBR

Technical data L82—standard models

Symbol	Port Size (PTF)	Lubricator type	Bowl	Weight lb (kg)	Model
	1/4	Micro fog	Guarded polycarbonate	0.48 (0.22)	L82M-2AP-EPN
	3/8	Micro fog	Guarded polycarbonate	0.48 (0.22)	L82M-3AP-EPN
	1/4	Micro fog	Metal with level indicator	0.88 (0.40)	L82M-2AP-EDN
	3/8	Micro fog	Metal with level indicator	0.88 (0.40)	L82M-3AP-EDN
	1/4	Oil fog	Guarded polycarbonate	0.48 (0.22)	L82C-2AP-EPN
	3/8	Oil fog	Guarded polycarbonate	0.48 (0.22)	L82C-3AP-EPN
	1/4	Oil fog	Metal with level indicator	0.88 (0.40)	L82C-2AP-EDN
	3/8	Oil fog	Metal with level indicator	0.88 (0.40)	L82C-3AP-EDN

Option selector

L82★ - ★★P - E★N

Type	Substitute
Oil fog lubricator	C
Micro fog lubricator	M
Port size	Substitute
1/4"	2
3/8"	3
Thread form	Substitute
PTF	A
ISO G	G

Bowl	Substitute
Metal with liquid level indicator	D
Transparent with guard	P

Flow characteristics

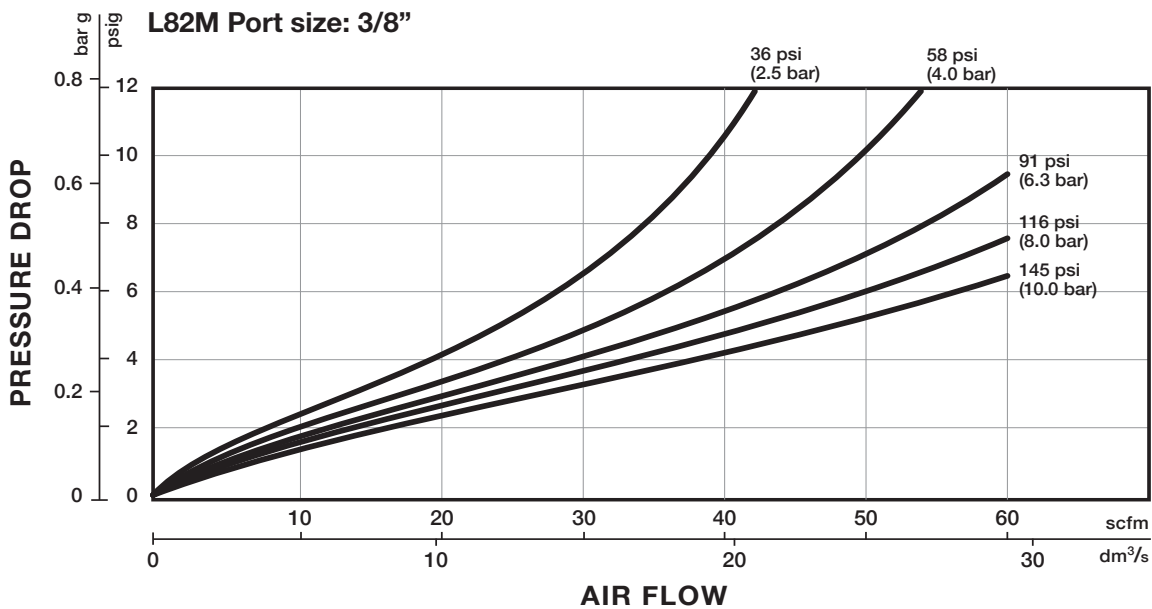
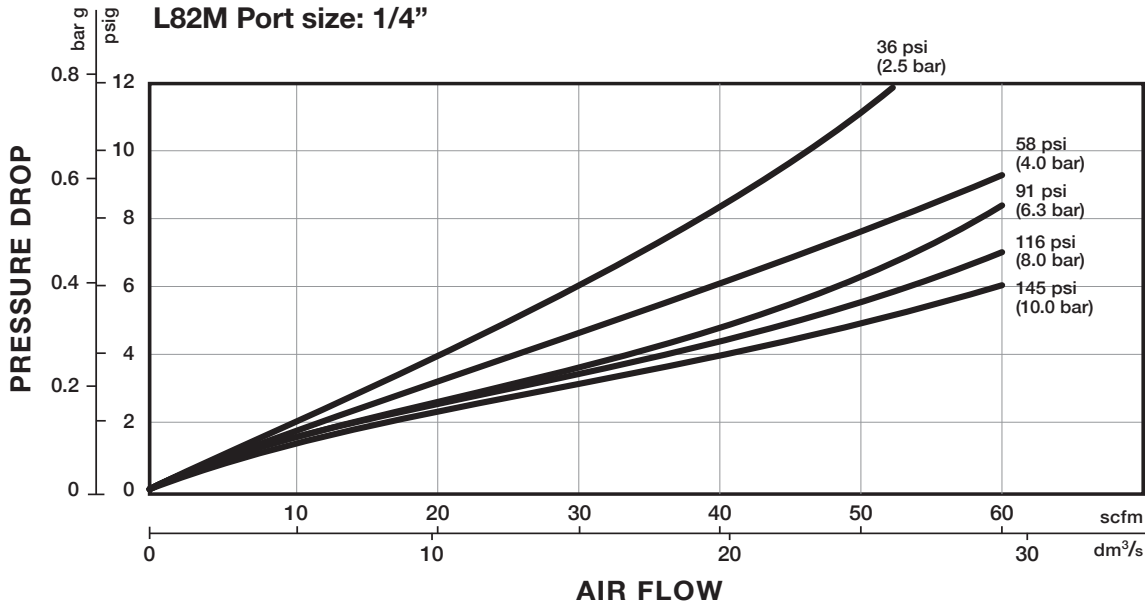

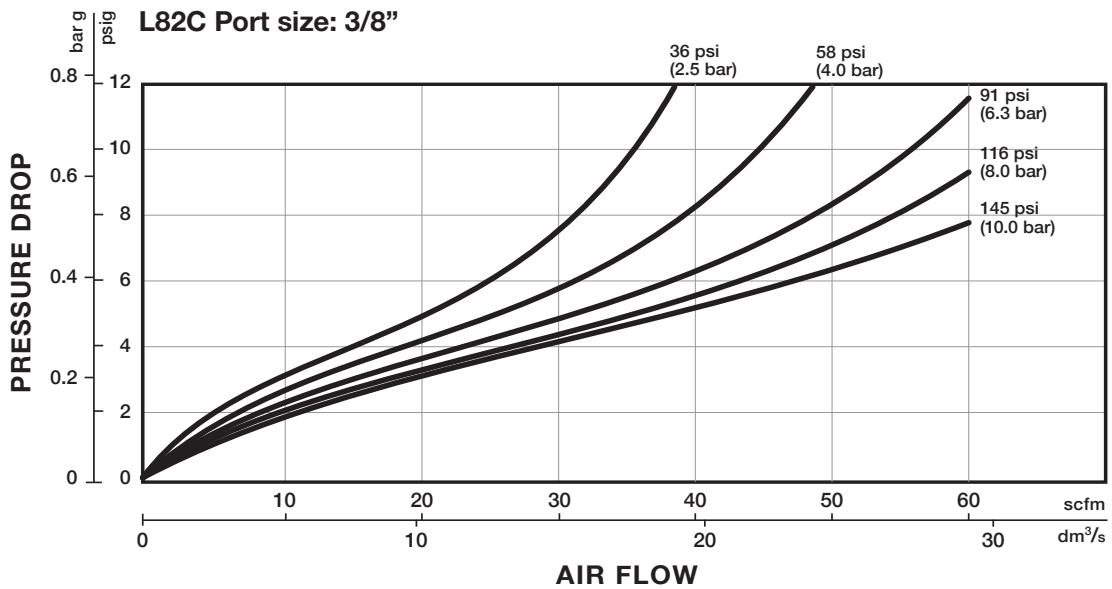
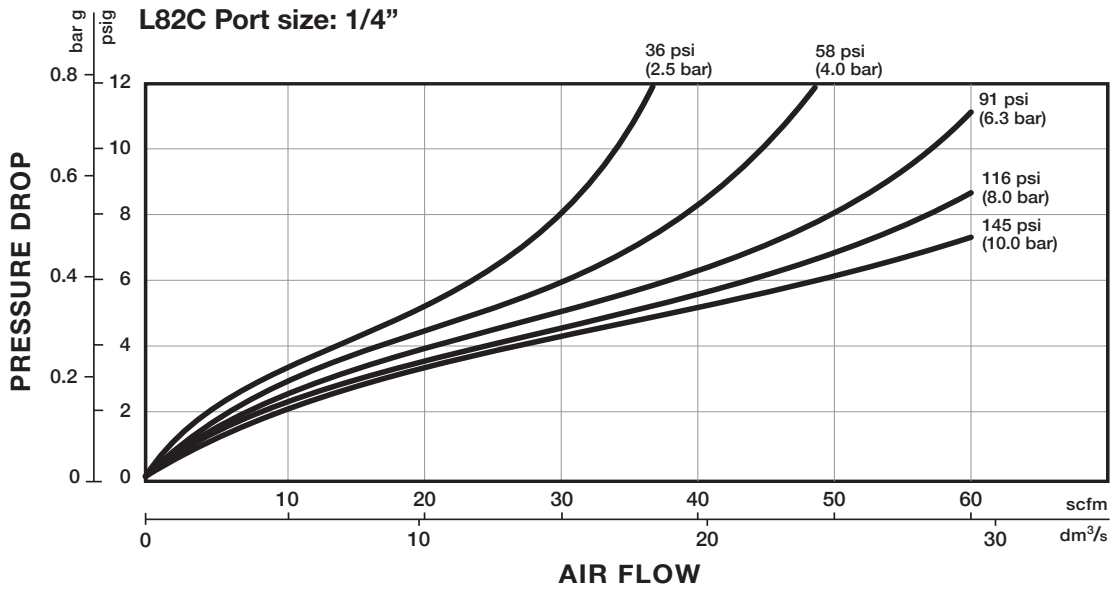



Accessories

Wall mounting bracket  page 4 820024-50KIT	Quikclamp®  page 4 820014-51KIT	Quikclamp® with bracket assembled  page 4 820014-52KIT	Pressure sensing block 1/4 PTF  page 5 820016-50KIT	Pressure sensing block G1/4  page 5 820016-51KIT
Full flow porting block 3/8 PTF  page 4 820028-50KIT	Full flow porting block G3/8  page 4 820028-53KIT	Pressure switch interface block (18D pressure switch)  page 5 0523109000000000	Pneumatic pressure switch 18D (0,5 ... 8 bar) *1)  page 5 0881300000000000	Digital pressure switch 51D(-1 ... 10 bar) *2)  page 6 0860810000000000
Port Adaptors 1/4 PTF  page 5 820015-02KIT	Port Adaptors 3/8 PTF  page 5 820015-03KIT	Port Adaptors G1/4  page 5 820015-08KIT	Port Adaptors G3/8  page 5 820015-09KIT	

Service Kits

Lubricator bowl Guarded Poly  820025-52KIT	Lubricator bowl Metal with sight glass  820003-52KIT	Lubricator sight dome kit  Micro fog (red) 840055-50KIT Oil fog (green) 840055-51KIT
--	--	---

Dimensions

Dimensions in inches (mm)
Projection/Third angle

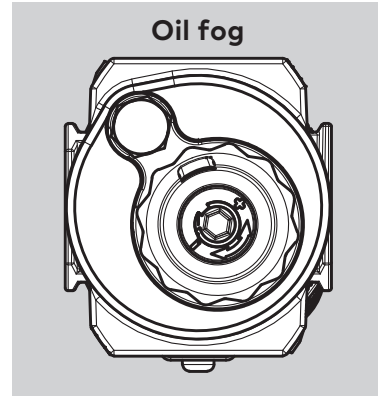
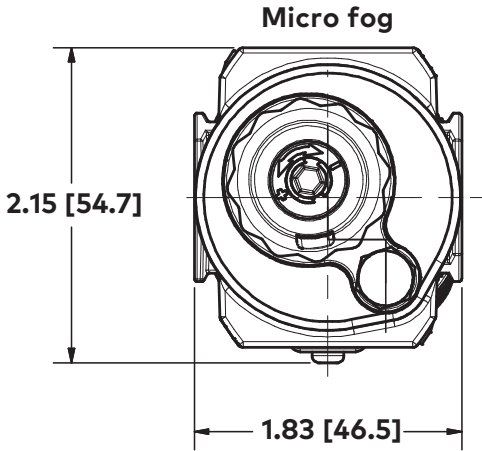

- 1 Main ports 1/4", 3/8" (ISO G/PTF)
- 2 Metal bowl with sight glass

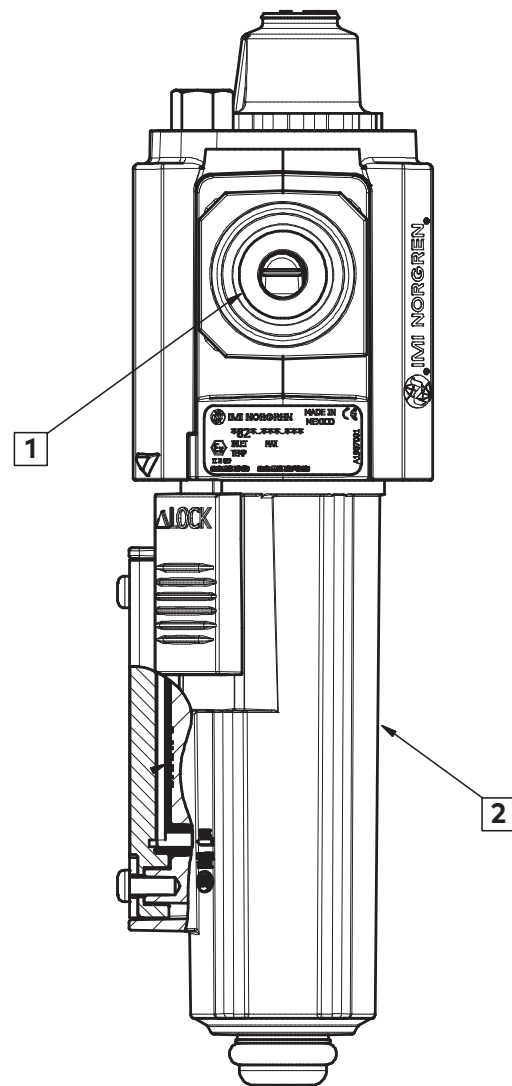
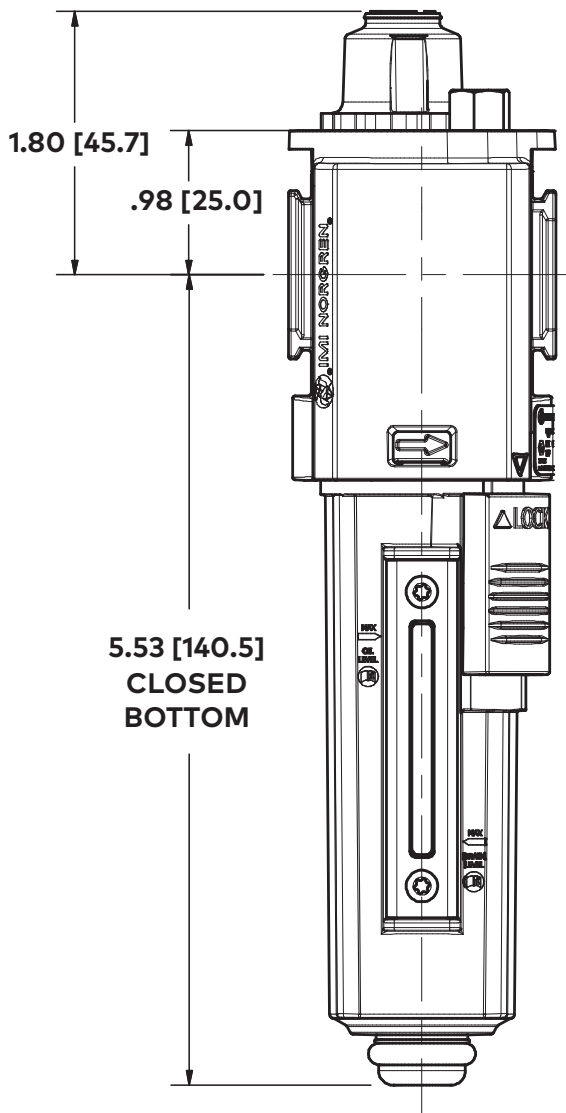

Accessories

Dimensions in inches (mm)
Projection/Third angle

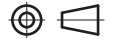

Quikclamp® with wall bracket

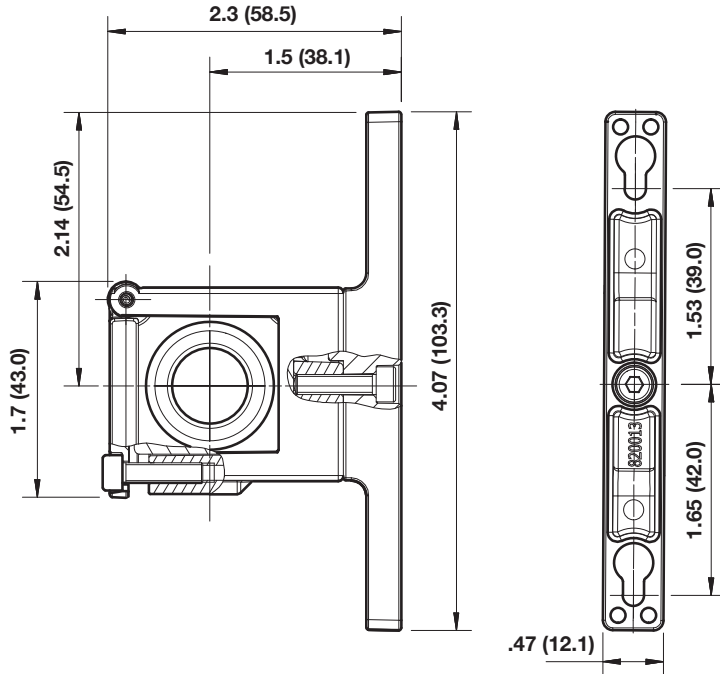

Quikclamp®

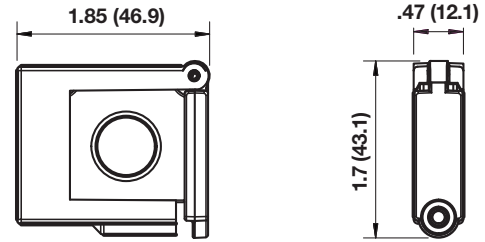

Mounting bracket

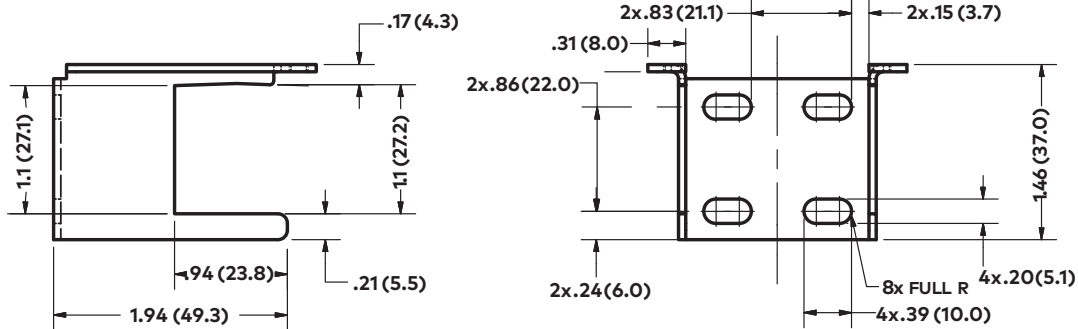
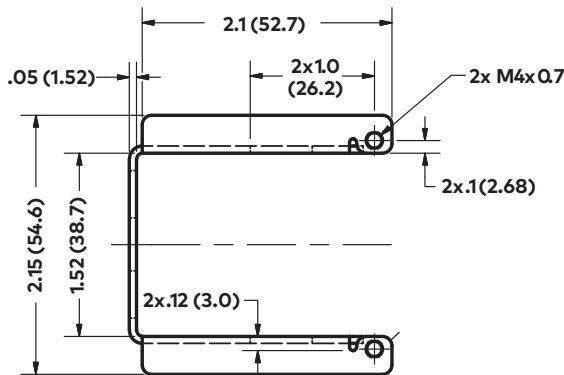

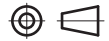
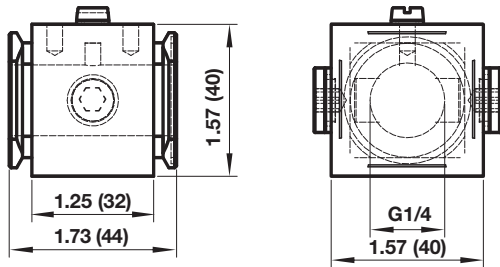
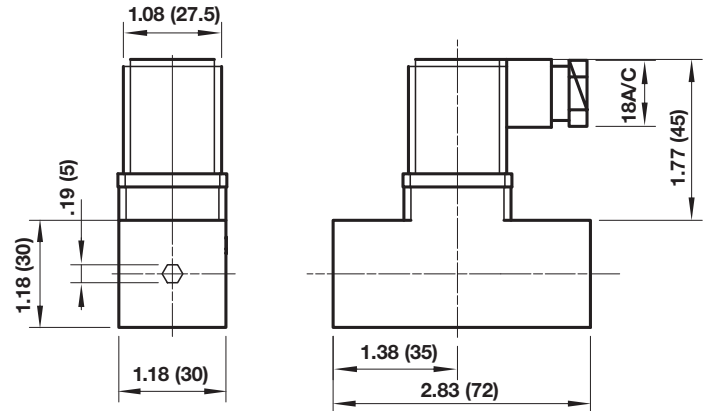
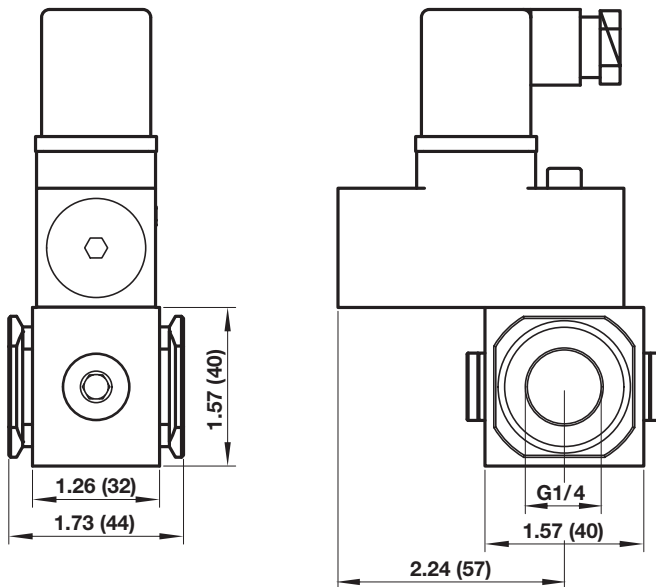
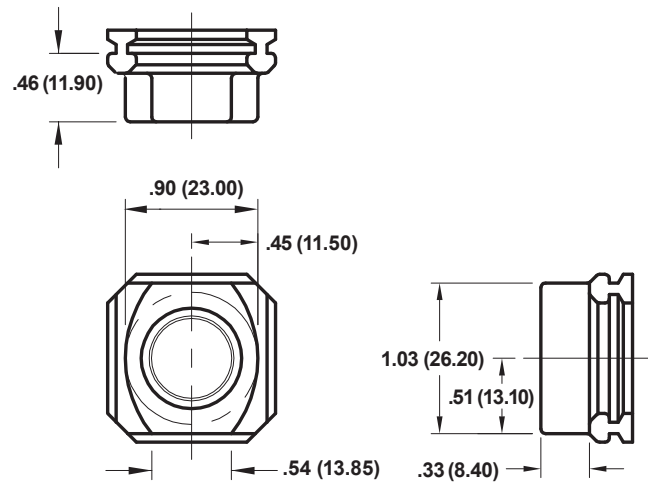
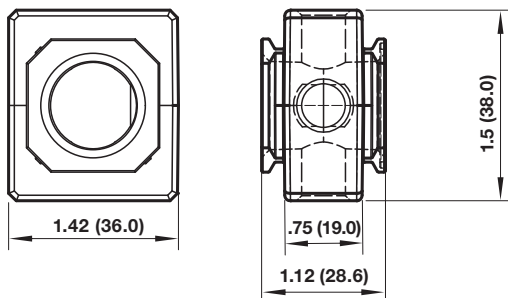
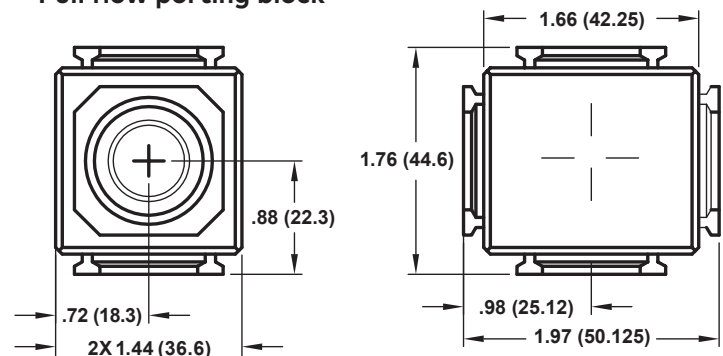
Porting block for 18D pressure switch

18D Pressure switch

18D Porting block and 18D assembled

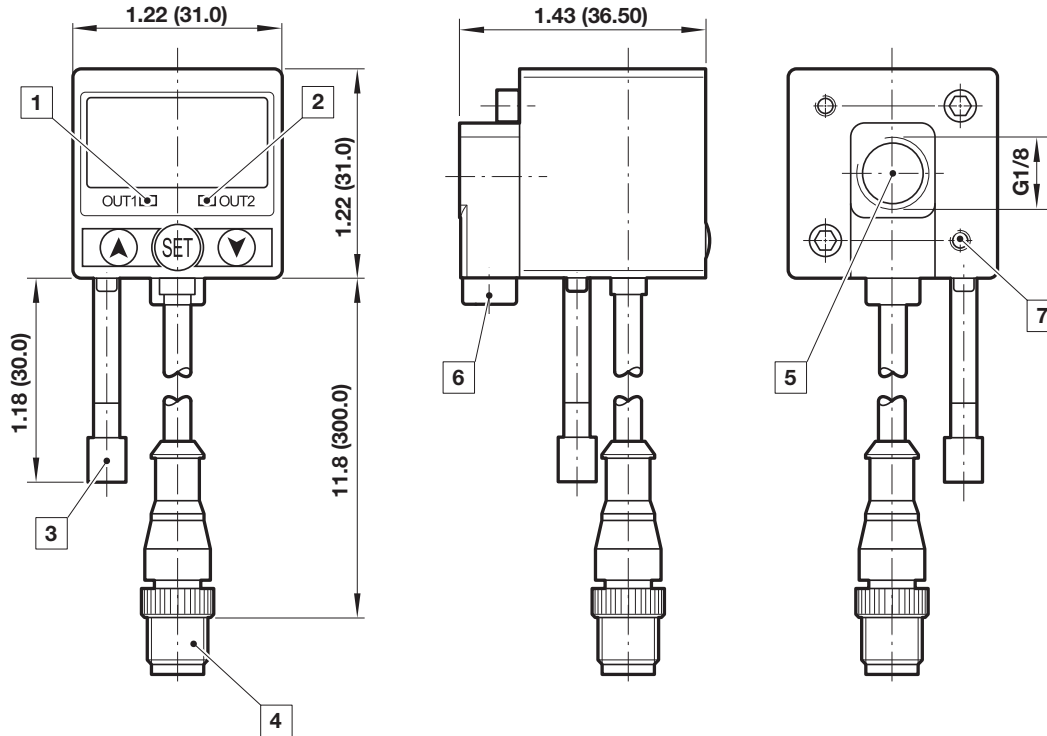
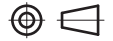
Pipe adaptor

Pressure sensing block

Full flow porting block

51D Pressure switch - digital

Dimensions in inches (mm)
Projection/Third angle



- 1 Switch OUT 1, green LED
- 2 Switch OUT 2, red LED
- 3 Dustproof protector
- 4 Connector M12 x 1
- 5 Inlet port
- 6 Alternative inlet port G1/8 plugged
- 7 Thread for mounting screw

Warning

These products are intended for use in industrial compressed air systems only. Do not use these products where pressures and temperatures can exceed those listed under »Technical features/data«. Before using these products with fluids other than those specified, for non-industrial applications, life-support systems or other applications not within published specifications, consult IMI Precision Engineering, Norgren Ltd.

Through misuse, age, or malfunction, components used in fluid power systems can fail in various modes. The system designer is warned to consider the failure

modes of all component parts used in fluid power systems and to provide adequate safeguards to prevent personal injury or damage to equipment in the event of such failure.

System designers must provide a warning to end users in the system instructional manual if protection against a failure mode cannot be adequately provided. System designers and end users are cautioned to review specific warnings found in instruction sheets packed and shipped with these products.