

REV	ECN	DATE	APPROVED
A	33702	10/01/13	JAF

SPECIFICATIONS:

STANDARD OPERATING CHARACTERISTICS

CODE: INCREMENTAL
 RESOLUTION: 1024 PPR (PULSES/REVOLUTION)
 ACCURACY: (worst case any edge to any other edge): ±2.5 arc-min
 FORMAT: Two channel quadrature (AB) with optional index(z) and complementary outputs
 PHASE SENSE: A leads B for CCW shaft rotation viewing the hub clamp end of the encoder
 QUADRATURE PHASING: 90° ± 22.5° ELECTRICAL
 SYMMETRY: 180° ± 18° electrical
 INDEX: 180° +18°/-135° ELECTRICAL (gated with B low)
 WAVEFORMS: Squarewave with rise and fall times less than 1 microsecond into a load capacitance of 1000 pf

ELECTRICAL

INPUT POWER: 4.5 min to 26VDC max at 100 mA max, not including output loads
 OUTPUTS: 7272 DIFFERENTIAL LINE DRIVER
 FREQUENCY RESPONSE: 100 kHz min
 ELECTRICAL PROTECTION: Overvoltage, reverse voltage and output short circuit protected
 MATING CONNECTOR: 10 PIN Terminal Cover

MECHANICAL

SHAFT BORE TOLERANCE: Nominal +0.0002"/ +0.0008" (+0.005/+0.020 MM)
 MATING SHAFT REQUIREMENTS:
 RUNDOUT: ± 0.005" (±0.13MM) RADIAL, MAX
 ENDPLAY: ± 0.050" (± 1.27MM) AXIAL, MAX
 LENGTH: 0.80" (20 MM),
 MINIMUM STARTING TORQUE: 3.0 oz-in max
 MOMENT OF INERTIA: 5.1 x 10⁻⁴ oz-in-sec²
 WEIGHT: 10 oz max

ENVIRONMENTAL

OPERATING TEMPERATURE: 0° TO +110°C
 STORAGE TEMPERATURE: -40 TO +110°C
 SHOCK: 50g'S FOR 11 ms duration
 VIBRATION: 5 TO 2000 Hz AT 2.5 G's

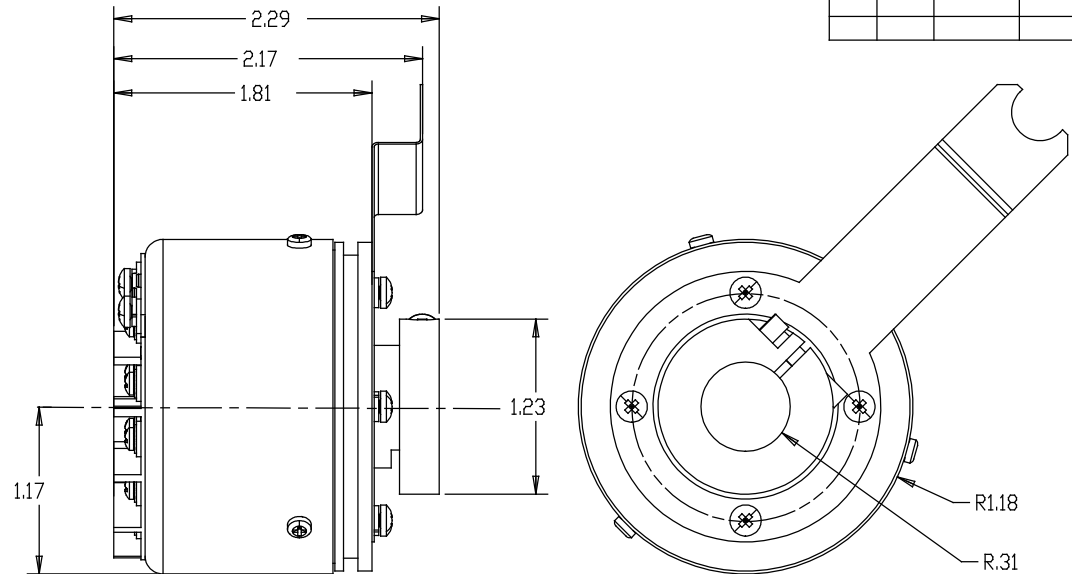

ELECTRICAL CONNECTIONS

ENCODER FUNCTION	CABLE	10 PIN
SIGNAL A	BRN	A
SIGNAL B	DRN	B
SIGNAL Z	YEL	C
POWER SOURCE	RED	D
NO CONN	--	E
COMMON	BLK	F
CASE	GRN	G
SIGNAL A0	BRN/WHT	H
SIGNAL B0	DRN/WHT	I
SIGNAL Z0	YEL/WHT	J

TOLERANCES UNLESS INDICATED:	UNITS: INCHES	TITLE	DWG, OUTLINE AND SPECIFICATION, HS20X11		
.XXX ± /	MATERIAL:	FILE NAME:	SCALE:	COMPLIANCE REQUIRED	
.XX ± /	FINISH:	70271401		<input type="checkbox"/> UL	<input type="checkbox"/> CSA
ANGLES ± /		DRAWN:	DATE:	<input type="checkbox"/> CE	<input type="checkbox"/> TUV
		JRM	05/30/07	<input type="checkbox"/> ECC	<input type="checkbox"/> CCI
		CHECKED:	DATE:	APPLICATION	
		JRM	05/30/07	HS20 x 11	
		RELEASED:	DATE:	DRAWING NUMBER	
		JRM	05/30/07	702714-0001	
				REV	A



©2007 D.T.C. *C*SIZE