

MCJQ3 Compact Actuator Mounting/Repair Guide

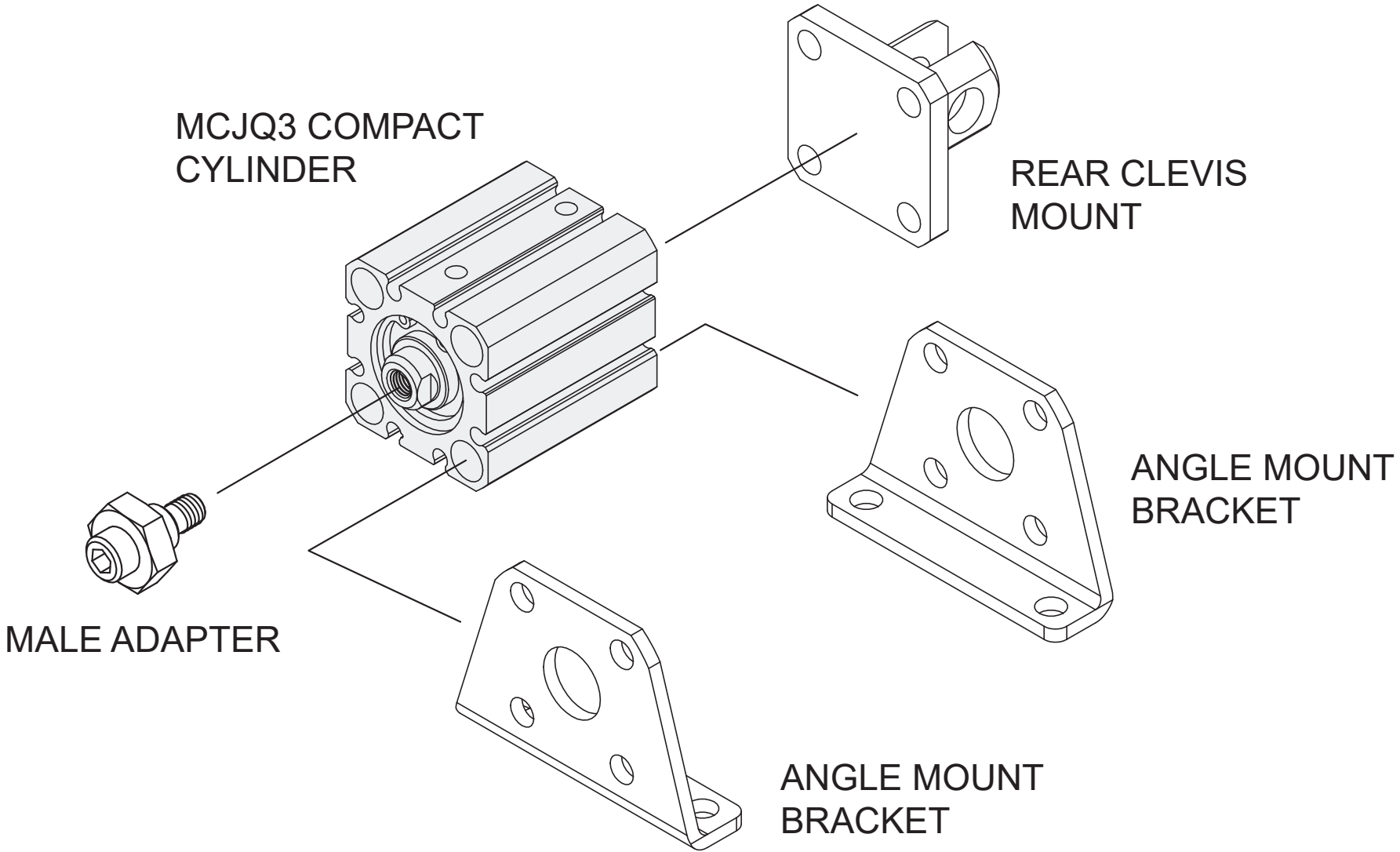

See tables for individual component information

Male Adapters



Part Number	Bore Size	Bolt Size	Torque
<u>HMA-12M</u>	12mm	M5 x 0.8	
<u>HMA-16M</u>	16mm	M6 x 1.0	
<u>HMA-20M</u>	20mm	M8 x 1.25	
<u>HMA-25M</u>	25mm	M10 x 1.25	
<u>HMA-32M</u>	32mm	M14 x 1.5	
<u>HMA-40M</u>	40mm		
<u>HMA-50M</u>	50mm	M18 x 1.5	
<u>HMA-63M</u>	63mm		
<u>HMA-80M</u>	80mm	M22 x 1.5	
<u>HMA-100M</u>	100mm	M26 x 1.5	

Clevis Pins



Part Number	Thread Size	Torque
<u>PINJ1121P</u>		
<u>PINJ1161P</u>		
<u>PINJ1201P</u>		
<u>PINJ1251P</u>		
<u>PINJ1321P</u>		
<u>PINJ1501P</u>		
<u>PINJ1801P</u>		
<u>PINJ11001P</u>		

Angle Mount Bracket



Part Number	Bore Size	Bolt Size	Torque
<u>LBJ112</u>	12mm		
<u>LBJ116</u>	16mm		
<u>LBJ120</u>	20mm		
<u>LBJ125</u>	25mm		
<u>LBJ132</u>	32mm		
<u>LBJ140</u>	40mm		
<u>LBJ150</u>	50mm		
<u>LBJ163</u>	63mm		
<u>LBJ180</u>	80mm		
<u>LBJ1100</u>	100mm		

Seal Kits



Part Number	Bore Size	Max. Stroke
<u>PSMCJQ12</u>	12mm	30mm
<u>PSMCJQ16</u>	16mm	30mm
<u>PSMCJQ20</u>	20mm	50mm
<u>PSMCJQ25</u>	25mm	50mm
<u>PSMCJQ32</u>	32mm	Full
<u>PSMCJQ40</u>	40mm	Full
<u>PSMCJQ50</u>	50mm	Full
<u>PSMCJQ63</u>	63mm	Full
<u>PSMCJQ80</u>	80mm	Full
<u>PSMCJQ100</u>	100mm	Full

Rear Clevis Mount



Part Number	Bore Size	Bolt Size	Torque
<u>CBJ112</u>	12mm		
<u>CBJ116</u>	16mm		
<u>CBJ120</u>	20mm		
<u>CBJ125</u>	25mm		
<u>CBJ132</u>	32mm		
<u>CBJ140</u>	40mm		
<u>CBJ150</u>	50mm		
<u>CBJ163</u>	63mm		
<u>CBJ180</u>	80mm		
<u>CBJ1100</u>	100mm		

Note: Pin not included

Seal Kits Extended



Part Number	Bore Size	Max. Stroke
<u>PSLMCJQ12</u>	12mm	35mm and up
<u>PSLMCJQ16</u>	16mm	35mm and up
<u>PSLMCJQ20</u>	20mm	75mm and up
<u>PSLMCJQ25</u>	25mm	75mm and up

MCJQ3 Standard Stroke - Material

Number	Tube I.D.	12	16	20	25	32	40	50	63	80	100	Qty.	Repair Kits (Inclusion)
	Part Name												
1	Body	Aluminum alloy										1	
2	Rod cover	Aluminum alloy										1	
3	End cover	Aluminum alloy										1	
4	Piston rod	Carbon steel										1	
5	Piston	Aluminum alloy										1	
6	Rod packing	NBR										1	•
7	Snap ring	Stainless steel					Spring steel					1	
8	Cover ring	NBR										1	•
9	Piston belt	Stainless steel					Spring steel					1	
10	Piston packing	NBR										1	•
11	Piston gasket	NBR										1	•
12	Cushion packing	NBR										2	•
13	Magnet	Magnet										1	
14	Wear ring	-					Resin					1	
15	Bushing	-					Bearing alloy					1	

NOTES:

- Items 1 through 6 are included in the seal kit
- During disassembly, pay close attention to orientation of the seals so the new seals can be installed correctly
- Apply a coat of lithium soap based grease to the newly-installed seals to prevent damage while re-assembling the cylinder and to provide lubrication to the cylinder
- Alternate tightening tie-rods to evenly torque to the provided torque guidelines.

Tie Rod Torque	
Bore	Torque
12mm	
16mm	
20mm	
25mm	
32mm	
40mm	
50mm	
63mm	
80mm	
100mm	

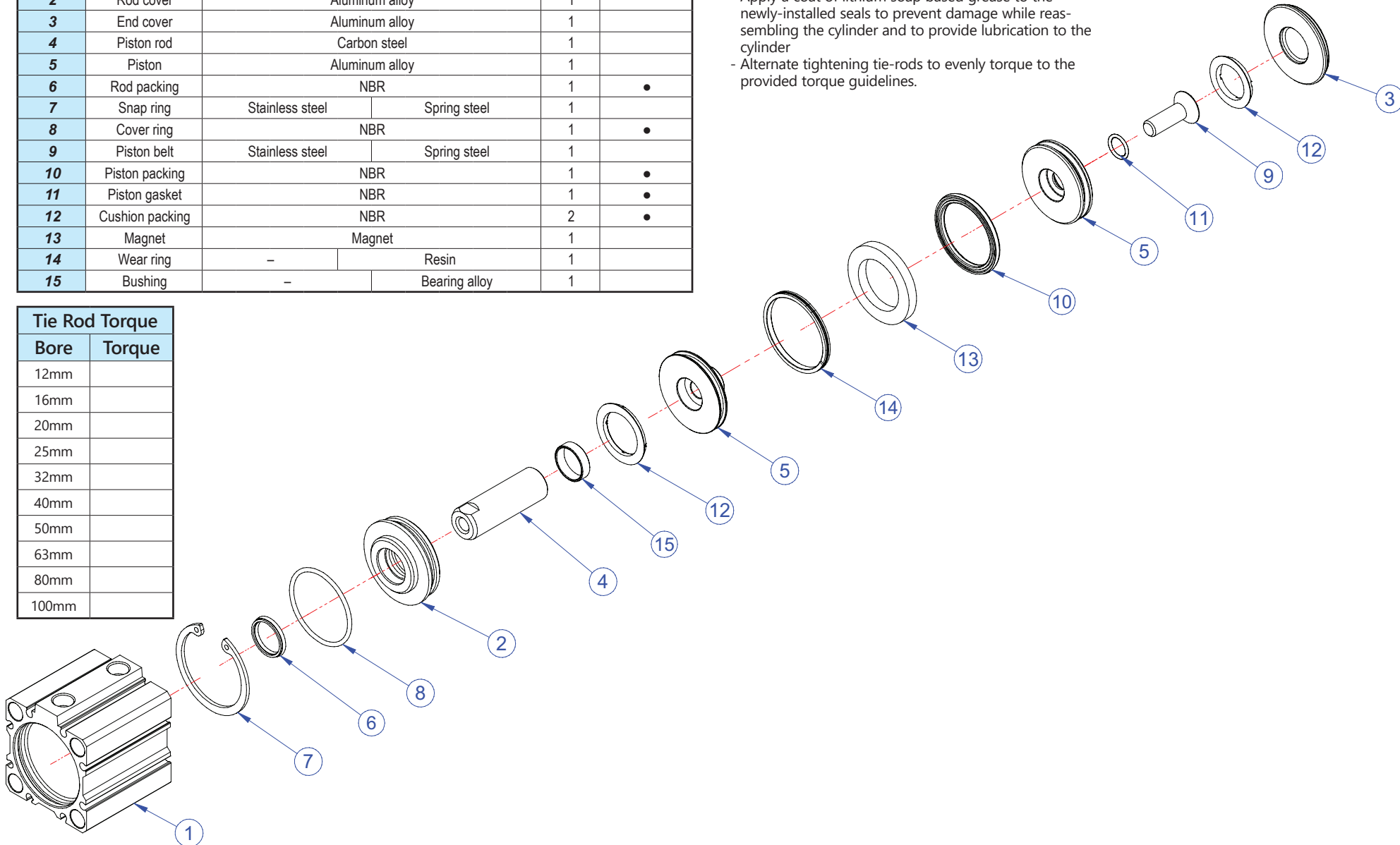

MCJQ3 Long Stroke - Material

Number	Tube I.D.	12	16	20	25	32	40	50	63	80	Qty.	Repair Kits (Inclusion)
	Part Name											
1	Body										1	
2	Rod cover										1	
3	End cover										1	
4	Piston rod										1	
5	Piston										1	
6	Rod packing										1	•
7	Snap ring										2	
8	Cover ring										2	•
9	Piston belt										1	
10	Piston packing										1	•
11	Piston gasket										1	•
12	Cushion packing										2	•
13	Magnet										1	
14	Wear ring										1	
15	Bushing										1	

Tie Rod Torque	
Bore	Torque
12mm	
16mm	
20mm	
25mm	
32mm	
40mm	
50mm	
63mm	
80mm	

NOTES:

- Items 1 through 6 are included in the seal kit
- During disassembly, pay close attention to orientation of the seals so the new seals can be installed correctly
- Apply a coat of lithium soap based grease to the newly-installed seals to prevent damage while reassembling the cylinder and to provide lubrication to the cylinder
- Alternate tightening tie-rods to evenly torque to the provided torque guidelines.

