

ACCESSORIES



In This Chapter...

Capacitors and Centrifugal Switches4-2
C-Flange Kits4-3
STABLE Slide Bases4-4

Capacitors and Centrifugal Switches

Single phase motors use capacitors to provide starting torque when power is first applied to the motor. When the motor begins to turn, the start capacitor is no longer needed and is taken out of the circuit by a centrifugal switch. In addition to the start capacitor, 1-1/2 hp IronHorse motors have run capacitors to allow the motor to develop higher running torque and greater efficiency. Run capacitors also help improve the motor power factor.

Single Phase Motor Accessories							
Part Number	Accessory Type	Capacitance (µF)	Rated Voltage	Dimension Height x Ø (in[mm])	Applicable Motor Number	Motor HP	Motor Phase
MTA-CAP-01	start capacitor	200	125	3.15 x 1.65 [80.0 x 41.9]	MTR-P33-1AB18	1/3	1
MTA-CAP-02		250	125		MTR-P50-1AB18 MTR-P75-1AB18	1/2 3/4	1
MTA-CAP-03		300	125		MTR-001-1AB18	1	1
MTA-CAP-04		250	165		MTR-1P5-1AB18	1-1/2	1
MTA-CAP-06	run capacitor	40	450	4.02 x 1.75 [102.1 x 44.5]	MTR-1P5-1AB18	1-1/2	1
MTA-CSW-01	centrifugal switch	n/a	250	n/a	all IronHorse single phase	all	1



C-Flange Kits

Any IronHorse T-frame cast iron motor from 1–300hp can be converted to C-face mount by using a cast iron C-flange kit. These kits are field installable and include the C-faces and mounting bolts. (TC-frame C-face motors are available from 1–100hp with the C-flange kits already installed.)

Three Phase T-Frame Motor C-Flange Kits				
Part Number	Fits Frame	Fits Motor Number	Motor HP	Shipping Weight (lb)
MTA-CFACE-140TC	143T & 145T	MTC-001-3BD12	1	6
		MTC-001-3BD18	1	
		MTC-1P5-3BD18	1-1/2	
		MTC-1P5-3BD36	1-1/2	
		MTC-002-3BD18	2	
		MTC-002-3BD36	2	
MTA-CFACE-180TC	182T & 184T	MTC-1P5-3BD12	1-1/2	12
		MTC-002-3BD12	2	
		MTC-003-3BD18	3	
		MTC-003-3BD36	3	
		MTC-003-3BD36	5	
		MTC-005-3BD36	5	
MTA-CFACE-210TC	213T & 215T	MTC-003-3BD12	3	12
		MTC-005-3BD12	5	
		MTC-7P5-3BD18	7-1/2	
		MTC-7P5-3BD36	7-1/2	
		MTC-010-3BD18	10	
		MTC-010-3BD36	10	
MTA-CFACE-250TC	254T & 256T	MTC-7P5-3BD12	7-1/2	32
		MTC-010-3BD12	10	
		MTC-015-3BD18	15	
		MTC-020-3BD18	20	
MTA-CFACE-280TC	284T & 286T	MTC-25-3BD18	25	38
		MTC-30-3BD18	30	
MTA-CFACE-320TC	324T & 326T	MTC-40-3BD18	40	60
		MTC-50-3BD18	50	
MTA-CFACE-360TC	364T & 365T	MTC-60-3BD18	60	62
		MTC-75-3BD18	75	
MTA-CFACE-400TC	405T	MTC-100-3BD18	100	144
MTA-CFACE-444TC	444T & 445T	MTC-125-3BD18	125	156
		MTC-150-3BD18	150	
MTA-CFACE-447TC	445/7T	MTC-200-3BD18	200	154
MTA-CFACE-449TC	449T	MTC-250-3D18	250	168
		MTC-300-3D18	300	



Authorized EASA service centers are equipped with the necessary equipment to quickly and inexpensively install C-Face kits. Visit the EASA website at www.easa.com to find the nearest authorized service center.

C-Flange Kits (continued)

C-Flange Dimensions

C-flange dimensions are shown in Chapter 2 (Mounting & Initial Startup) along with TC-frame motor dimensions.



T-Frame C-Flange Kit

STABLE Slide Bases

AutomationDirect offers STABLE AC motor slide bases for mounting most AC motor brands with frame sizes from 56 to 449. These heavy duty steel bases are primed with an oven-baked primer ready for painting. The motor mounting bolts are welded to the exact motor foot pattern to prevent the bolts from spinning.



Slide Base Selection

Motor Slide Bases			
Part Number	Fits Frame Type	Shipping Weight (lb)	IronHorse Model
MTA-BASE-W56	56	3.5	MTR-xxx-1AB18 MTR-xxx-3BD18 MTR-xxx-3BD36
MTA-BASE-W143T	143T/TC	5.0	MTC-001-3BD18(CK) MTC-1P5-3BD36
MTA-BASE-W145T	145T/TC	5.6	MTC-001-3BD12 MTC-1P5-3BD18(CK) MTC-002-3BD18(CK) MTC-002-3BD36
MTA-BASE-W182T	182T/TC	10	MTC-1P5-3BD12 MTC-003-3BD18(CK) MTC-003-3BD36
MTA-BASE-W184T	184T/TC	10	MTC-002-3BD12 MTC-005-3BD18(CK) MTC-005-3BD36
MTA-BASE-W213T	213T/TC	15	MTC-003-3BD12 MTC-7P5-3BD18(CK) MTC-7P5-3BD36
MTA-BASE-W215T	215T/TC	16	MTC-005-3BD12 MTC-010-3BD18(CK) MTC-010-3BD36
MTA-BASE-W254T	254T/TC	20	MTC-7P5-3BD12 MTC-015-3BD18(CK)
MTA-BASE-W256T	256T/TC	21	MTC-010-3BD12 MTC-020-3BD18(CK)
MTA-BASE-W284T	284T/TC	23	MTC-025-3BD18(CK)
MTA-BASE-W286T	286T/TC	24	MTC-030-3BD18(CK)
MTA-BASE-W324T	324T/TC	33	MTC-040-3BD18(CK)
MTA-BASE-W326T	326T/TC	35	MTC-050-3BD18(CK)
MTA-BASE-W364T	364T/TC	46	MTC-060-3BD18(CK)
MTA-BASE-W365T	365T/TC	47	MTC-075-3BD18(CK)
MTA-BASE-W404T	404T/TC	64	-
MTA-BASE-W405T	405T/TC	65	MTC-100-3BD18(CK)
MTA-BASE-W444T	444T	69	MTC-125-3BD18
MTA-BASE-W445T	445T	70	MTC-150-3BD18
MTA-BASE-W447T	445/7T 447T	92	MTC-200-3BD18
MTA-BASE-W449T	449T	98	MTC-250-3D18 MTC-300-3D18

Slide Base Dimensions

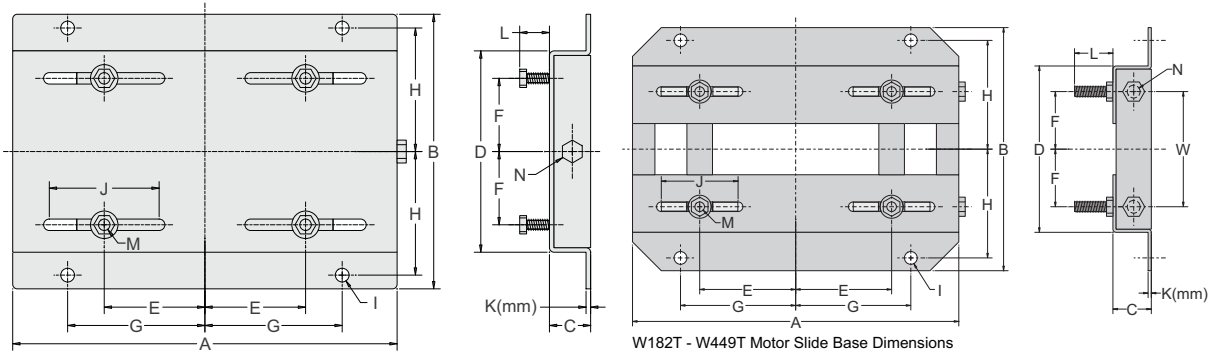

W56 - W145T Motor Slide Base Dimensions

W182T - W449T Motor Slide Base Dimensions
(W182T-W215T bases have one-piece top plates, similar to W56-W145T)

Dimensions [inches, except as noted] - STABLE Motor Slide Bases							
MTA-BASE-Wxxxx	A	B	C	D	E	F	G
56	10-5/8	6-1/2	1-1/8	4-1/2	2-7/16	1-1/2	3-13/16
143T	10-1/2	7-1/2	1-1/8	5-1/2	2-3/4	2	3-3/4
145T	10-1/2	8-1/2	1-1/8	6-1/2	2-3/4	2-1/2	3-3/4
182T	12-3/4	9-1/2	1-1/2	6-1/2	3-3/4	2-1/4	4-1/2
184T	12-3/4	10-1/2	1-1/2	7-1/2	3-3/4	2-3/4	4-1/2
213T	15	11	1-3/4	7-1/2	4-1/4	2-3/4	5-1/4
215T	15	12-1/2	1-3/4	9	4-1/4	3-1/2	5-1/4
254T	17-3/4	15-1/8	2	10-3/4	5	4-1/8	6-1/4
256T	17-3/4	16-7/8	2	12-1/2	5	5	6-1/4
284T	19-3/4	16-7/8	2	12-1/2	5-1/2	4-3/4	7
286T	19-3/4	18-3/8	2	14	5-1/2	5-1/2	7
324T	22-3/4	19-1/4	2-1/2	14	6-1/4	5-1/4	8
326T	22-3/4	20-3/4	2-1/2	15-1/2	6-1/4	6	8
364T	25-1/2	20-1/2	2-1/2	15-1/2	7	5-5/8	9
365T	25-1/2	21-1/2	2-1/2	16-1/2	7	6-1/8	9
404T	28-3/4	22-3/8	3	16-1/2	8	6-1/8	10
405T	28-3/4	23-7/8	3	18	8	6-7/8	10
444T	31-1/4	24-5/8	3	19-1/4	9	7-1/4	11
445T	31-1/4	26-5/8	3	21-1/4	9	8-1/4	11
447T	31-1/4	30-1/8	3	24-3/4	9	10	11
449T	31-1/4	35-1/8	3	29-3/4	9	12-1/2	11

**** Table Continued Next Page for Dimensions H-W ****

Slide Base Dimensions (continued)

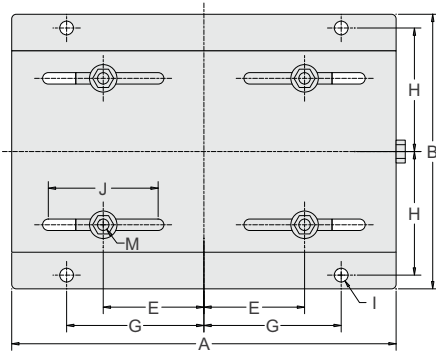

W56 - W145T Motor Slide Base Dimensions

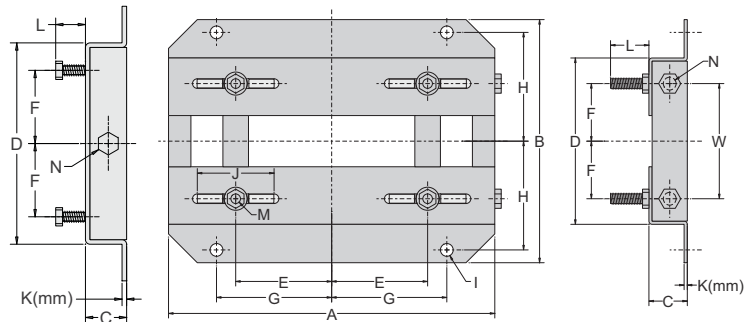

W182T - W449T Motor Slide Base Dimensions
(W182T-W215T bases have one-piece top plates, similar to W56-W145T)

**** Table Continued from Previous Page for Dimensions A-G ****

Dimensions [inches, except as noted] - STABLE Motor Slide Bases (continued)

MTA-BASE-Wxxxx	H	I	J	K(mm)	L	M	N	W
56	2-7/8	3/8	3	2 mm	7/8	5/16 x 1	3/8 x 4	n/a
143T	3-3/8	3/8	3	3 mm	13/16	5/16 x 1	3/8 x 4	n/a
145T	3-7/8	3/8	3	3 mm	13/16	5/16 x 1	3/8 x 4	n/a
182T	4-1/4	1/2	3	3.5 mm	1-1/2	3/8 x 1-3/4	1/2 x 6	4-1/2
184T	4-3/4	1/2	3	3.5 mm	1-1/2	3/8 x 1-3/4	1/2 x 6	5-1/2
213T	4-3/4	1/2	3-1/2	3.8 mm	1-1/2	3/8 x 1-3/4	1/2 x 6	5-1/2
215T	5-1/2	1/2	3-1/2	3.8 mm	1-1/2	3/8 x 1-3/4	1/2 x 6	7
254T	6-5/8	5/8	4	4.6 mm	1-7/16	1/2 x 1-3/4	5/8 x 6	5-5/16
256T	7-1/2	5/8	4	4.6 mm	1-7/16	1/2 x 1-3/4	5/8 x 6	7
284T	7-1/2	5/8	4-1/2	4.6 mm	1-11/16	1/2 x 2	5/8 x 6	7
286T	8-1/4	5/8	4-1/2	4.6 mm	1-11/16	1/2 x 2	5/8 x 6	8
324T	8-1/2	3/4	5-1/4	4.6 mm	2-3/16	5/8 x 2-1/2	3/4 x 9	7
326T	9-1/4	3/4	5-1/4	4.6 mm	2-3/16	5/8 x 2-1/2	3/4 x 9	8-1/2
364T	9-1/8	3/4	6	5.8 mm	2-1/16	5/8 x 2-1/2	3/4 x 9	7-3/4
365T	9-5/8	3/4	6	5.8 mm	2-1/16	5/8 x 2-1/2	3/4 x 9	8-3/4
404T	9-7/8	7/8	7	5.8 mm	2-1/2	3/4 x 3	3/4 x 11	8-3/4
405T	10-5/8	7/8	7	5.8 mm	2-1/2	3/4 x 3	3/4 x 11	10-1/4
444T	11	7/8	7-1/2	5.8 mm	2-1/2	3/4 x 3	3/4 x 11	11
445T	12	7/8	7-1/2	5.8 mm	2-1/2	3/4 x 3	3/4 x 11	13
447T	13-3/4	7/8	7-1/2	8 mm	3	3/4 x 3-1/2	3/4 x 11	16-1/2
449T	16-1/4	7/8	7-1/2	8 mm	3	3/4 x 3-1/2	3/4 x 11	21-1/2