

DATA SHEET

Premium Efficiency Motor: **MTSP-P33-3BD36**

60 Hz

Document Generated: 9-Nov-2020
Document ID:

Customer:

MOTOR INFORMATION

| | |
|-------------------------|--------------------------------|
| HP | 1/3 |
| RPM | 3600 |
| Phase | 3 |
| Frequency | 60 |
| Voltage | 230/460 |
| Frame Size | 56C |
| Enclosure | TEFC |
| Degree of Protection | IP69 |
| Service Factor | 1.15 |
| Poles | 2 |
| Full Load Speed | 3500 |
| Insulation Class | F |
| Temp Rise | 80°C |
| NEMA Code Letter | R |
| Duty Cycle | S1 |
| Slip | 2.78% |
| NEMA Design | B |
| Moment of Inertia | 0.027 lb.ft.^2 |
| Locked Rotor Time (Hot) | 12 seconds |
| Sound Pressure Level | 75 dB(A) |
| Number of Starts | 12 |
| Max Ambient Temperature | 40° C |
| Max Elevation | 1000 m.a.s.l (3300 f.a.s.l) |
| Mounting | F1 |
| Rotation | Bidirectional |
| Area of Classification | Div.2 Class I, Gr. A,B,C&D T2B |
| Inverter Rating | 10:1 CT/20:1 VT |
| Standard | NEMA MG1, UL1004 |
| Approvals | CSA,UL,CE |

EFFICIENCY/POWER FACTOR

| LOAD | EFF | P. F. |
|------|--------|-------|
| 100% | 72.0 % | 0.85 |
| 75% | 64.0 % | 0.72 |
| 50% | 59.0 % | 0.62 |

TORQUE

| FULL LOAD | LRT | BDT |
|------------|-------|-------|
| 0.5 lb.ft. | 285 % | 300 % |

AMPERAGE INFORMATION

| | 230V | 460V |
|-------------------|-------|-------|
| Full Load Amps | 1.1A | 0.55 |
| Locked Rotor Amps | 13A | 6.5A |
| No Load Current | 0.74A | 0.37A |
| Usable at 208V | 1.2 A | |

BEARING INFORMATION

| | |
|-------------------------|------------------|
| DE Bearing | 6205 2RS |
| ODE Bearing | 6205 2RS |
| Grease Type | Mobil Polyrex EM |
| DE Regreasing Interval | -- Hours |
| ODE Regreasing Interval | -- Hours |
| Grease Quantity | -- |

ADDITIONAL DATA

| | |
|--------------------|---------------------|
| F2 Suitable | No |
| Shaft Material | 304 Stainless Steel |
| Connection Diagram | 9 Lead 2Y/Y |
| Approximate Weight | 26 lbs. |

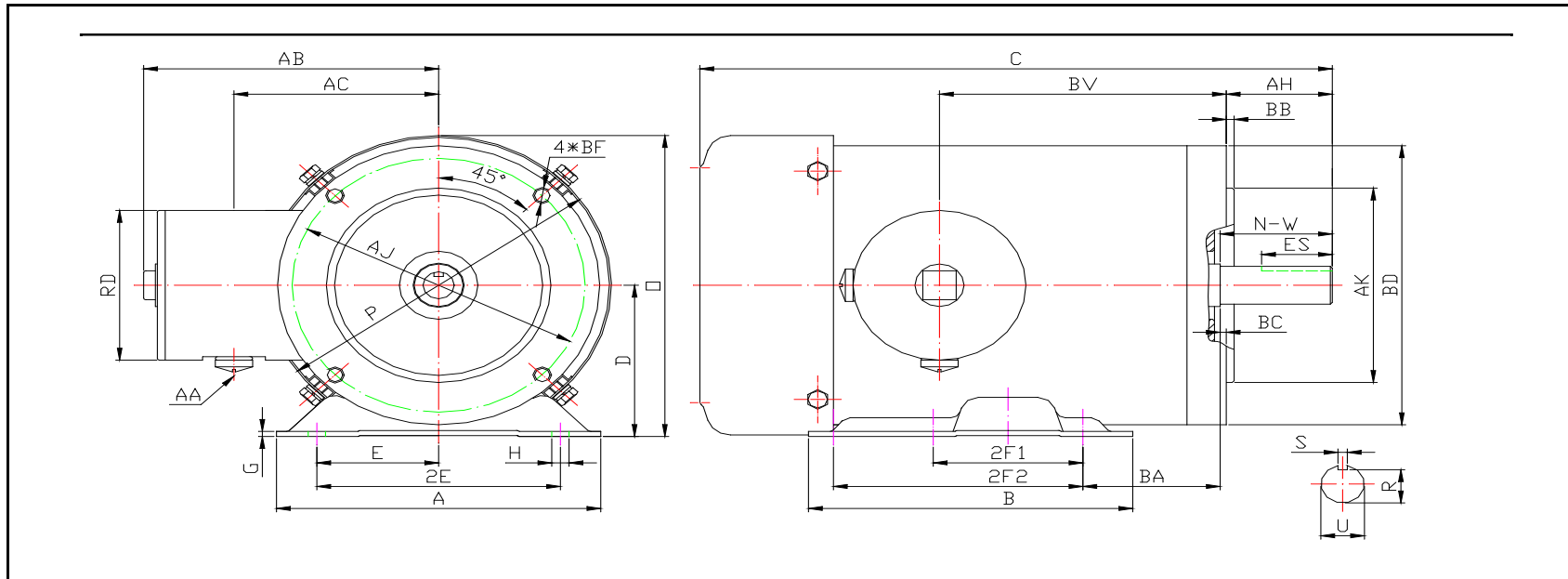

DIMENSION - INCHES

| MOUNTING | | | | | | A | B | C | D | G | P | O | T |
|----------|------|-----|-----|-----------|------|-----|---|-------|-----|-------|------|------|-----|
| E | 2E | 2F1 | 2F2 | H | BA | | | | | | | | |
| 2.44 | 4.88 | 3 | N/A | 1.22*0.34 | 2.75 | 6.5 | 5 | 11.59 | 3.5 | 0.118 | 6.95 | 6.98 | N/A |

| AB | BC | KEY | | KEYSET | SHAFT | | | TERMINAL BOX | | | | |
|------|-------|-------|------|--------|-------|------|-------|--------------|------|-----|------|------|
| | | S | ES | R | AH | N-W | U | AA | AB | AC | RD | BV |
| 5.95 | -0.19 | 0.188 | 1.41 | 0.517 | 2.06 | 1.88 | 0.625 | 1/2 | 5.95 | 4.5 | 3.45 | 4.75 |

| FLANGE | | | | |
|--------|-----|------|------|----------|
| AJ | AK | BB | BD | BF |
| 5.875 | 4.5 | 0.16 | 6.45 | 4*3/8-16 |

| REV. | SUMMARY OF MODIFICATIONS | DATE |
|------|--------------------------|------------|
| 0 | | 10/21/2020 |
| | | |

PERFORMANCE CURVES

Premium Efficiency Motor: **MTSP-P33-3BD36**

Document Generated: 9-Nov-2020
 Document ID:

Customer:

| | | | | | |
|-----------------------|-------|--------------------|------------|------|-------------------|
| Motor Type | MTS | | FL Speed | 3500 | |
| Output Rating (HP) | 1/3 | | LRT (%FLT) | 285 | 460 volt FLA 0.55 |
| Full Load Torque | 0.5 | lb.ft | BDT (%FLT) | 300 | 230 volt FLA 1.1A |
| Rotor Wk ² | 0.027 | lb-ft ² | | | |

SPEED VS TORQUE & CURRENT CURVE

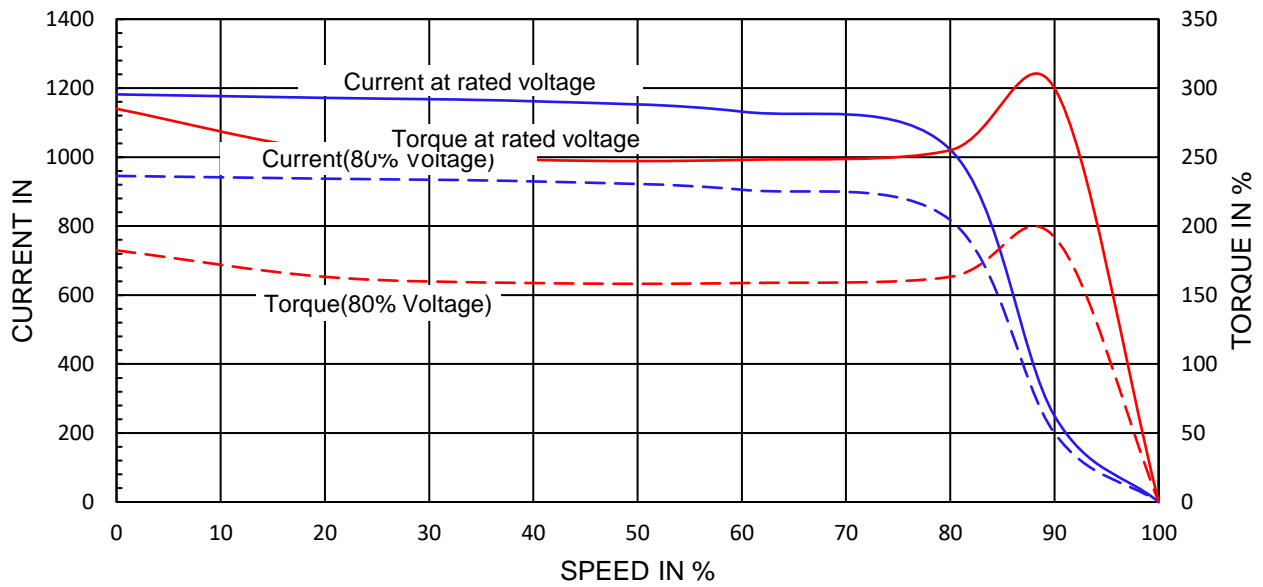

OUTPUT VS EFF., P.F. & CURRENT CURVE

