

# DATA SHEET

Premium Efficiency Motor: **MTSP-001-3BD12**

**60 Hz**

Document Generated: 22-Sep-2021

Document ID:

Customer:

## MOTOR INFORMATION

HP	1
RPM	1200
Phase	3
Frequency	60
Voltage	230/460
Frame Size	145TC
Enclosure	TEFC
Degree of Protection	IP69K
Service Factor	1.15
Poles	6
Full Load Speed	1165
Insulation Class	F
Temp Rise	80°C
NEMA Code Letter	N
Duty Cycle	S1
Slip	2.92%
NEMA Design	B
Moment of Inertia	0.143 lb.ft.^2
Locked Rotor Time (Hot)	12 seconds
Sound Pressure Level	55 dB(A)
Number of Starts	12
Max Ambient Temperature	40° C
Max Elevation	1000 m.a.s.l (3300 f.a.s.l)
Mounting	F1
Rotation	Bidirectional
Area of Classification	Div.2 Class I, Gr. A,B,C&D T2B
Inverter Rating	10:1 CT/20:1 VT
Standard	NEMA MG1, UL1004
Approvals	CSA,UL,CE

## EFFICIENCY/POWER FACTOR

LOAD	EFF	P. F.
100%	82.5 %	0.68
75%	76.0 %	0.59
50%	72.0 %	0.5

## TORQUE

FULL LOAD	LRT	BDT
4.4 lb.ft.	255 %	270 %

## AMPERAGE INFORMATION

	230V	460V
Full Load Amps	4	2
Locked Rotor Amps	30	15
No Load Current	3	1.5
Usable at 208V	4	

## BEARING INFORMATION

DE Bearing	6205 2RS
ODE Bearing	6205 2RS
Grease Type	Mobil Polyrex EM
DE Regreasing Interval	-- Hours
ODE Regreasing Interval	-- Hours
Grease Quantity	--

## ADDITIONAL DATA

F2 Suitable	No
Shaft Material	304 Stainless Steel
Connection Diagram	9 Lead 2Y/Y
Approximate Weight	42 lbs.

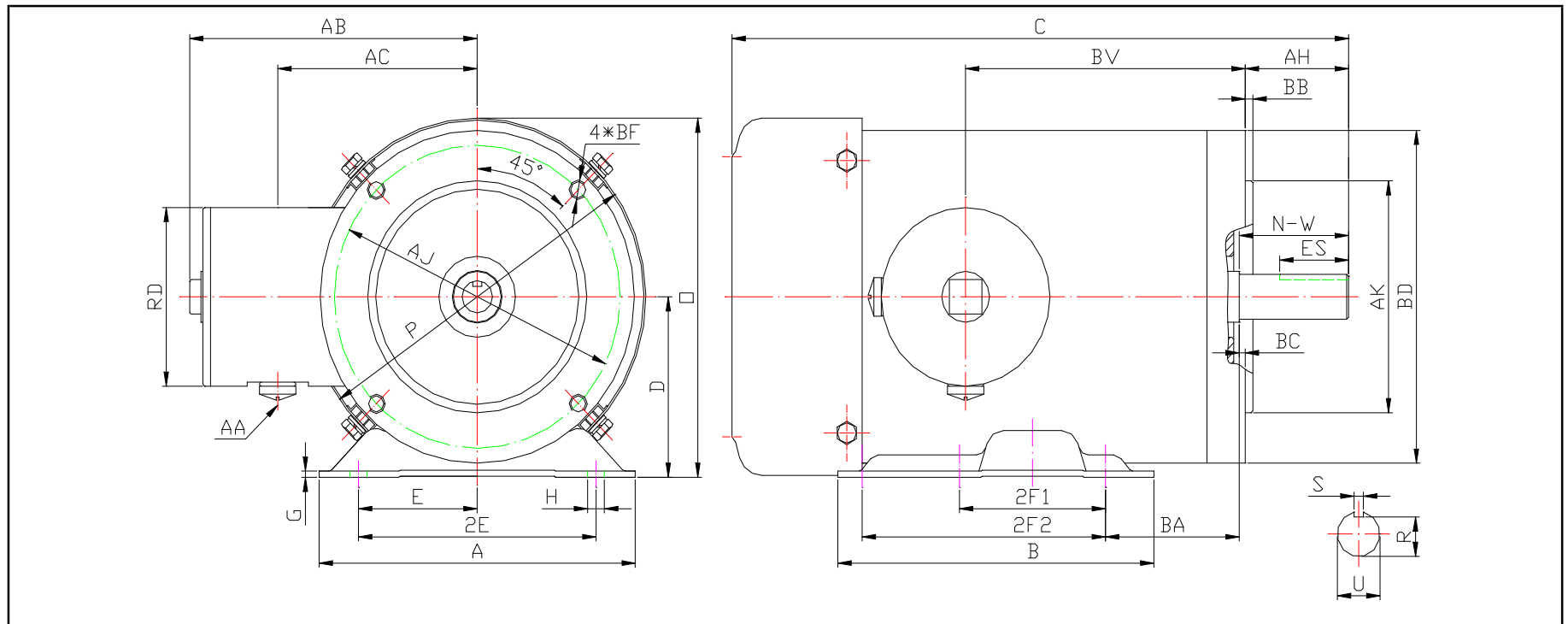

**DIMENSIONS - INCHES**

MOUNTING					A	B	C	D	G	T	P	O	BC	AB
E	2F1	2F2	H	BA										
2.75	3	5	1.22*0.34	2.75	6.5	6.5	12.63	3.5	0.118	--	6.95	6.98	0.12	5.95

SHAFT & KEY					
S	ES	R	N-W	U	AH
0.188	1.41	0.771	2.25	0.875	2.12

TERMINAL BOX				
AA	AB	AC	RD	BV
1/2	5.95	4.5	3.45	5.75

FLANGE				
AK	BD	AJ	BF	BB
4.5	6.45	5.875	(4)3/8-16	0.16

# PERFORMANCE CURVES

Premium Efficiency Motor: **MTSP-001-3BD12**

Document Generated: 22-Sep-2021	Customer:
Document ID:	

Motor Type	MTS		FL Speed	1165	
Output Rating (HP)	1		LRT (%FLT)	255	460 volt FLA 2
Full Load Torque	4.4	lb.ft	BDT (%FLT)	270	230 volt FLA 4
Rotor Wk <sup>2</sup>	0.143	lb-ft <sup>2</sup>			

SPEED VS TORQUE & CURRENT CURVE

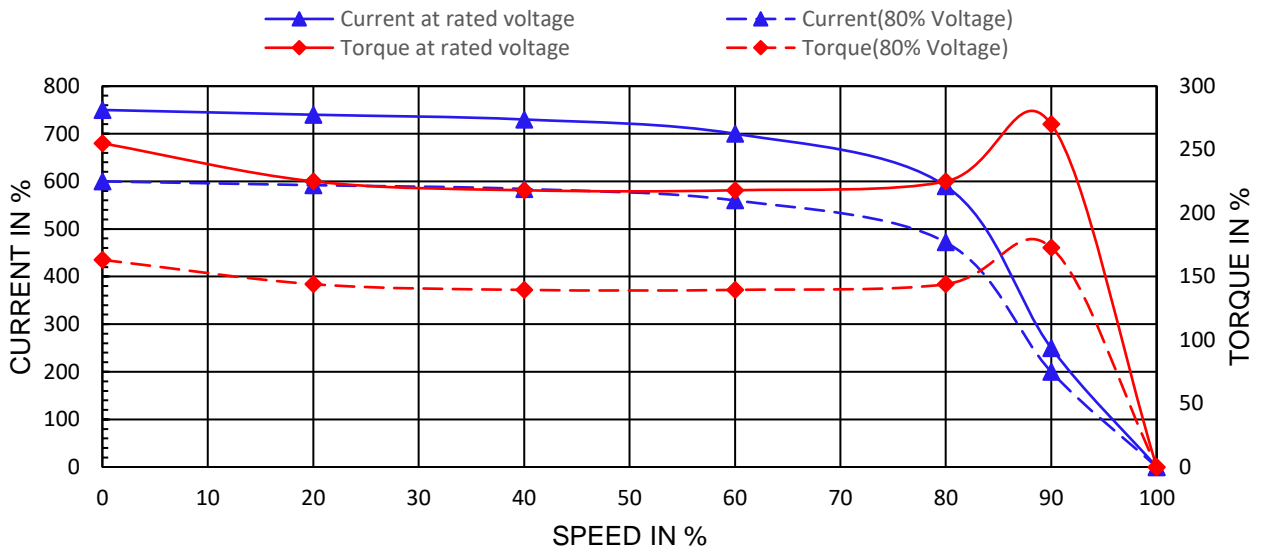

OUTPUT VS EFF., P.F. & CURRENT CURVE

