

PARTS LIST

LISTE DES PIÈCES

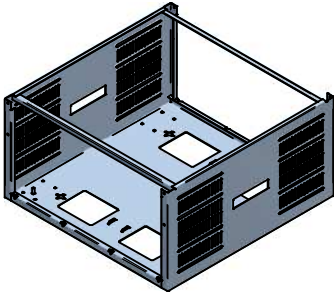

ITEM 1
SDC BODY
QTY 1

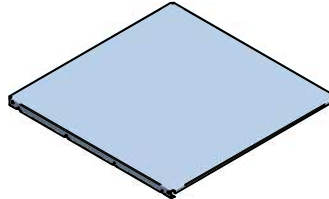

ITEM 2
SDC COVER
QTY 1



ITEM 1
COVER SCREW (PHILLIPS)
QTY 4

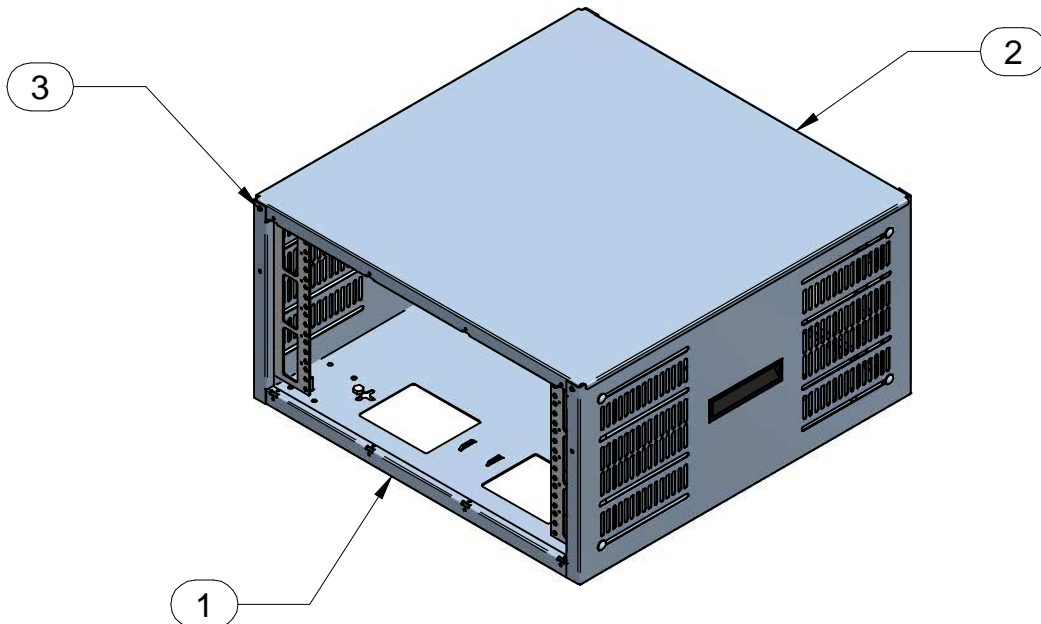

TOOL BOX



BOÎTE À OUTILS



visit our website: www.hammondmfg.com
visitez notre site Web:

1

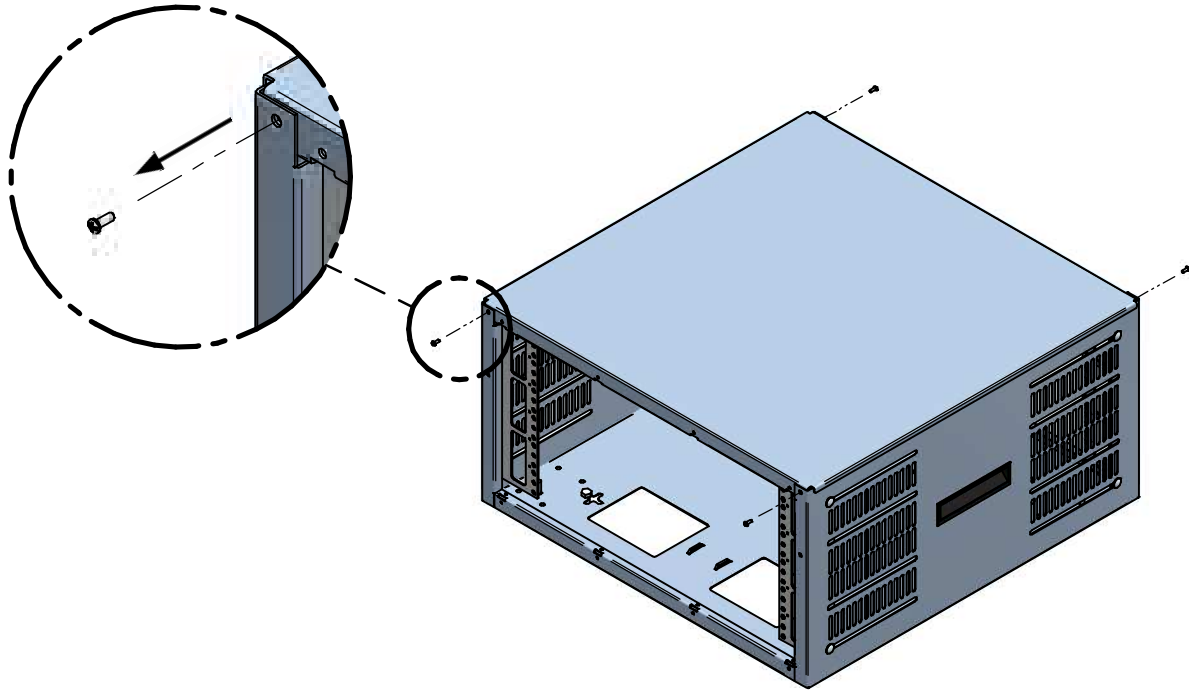

2

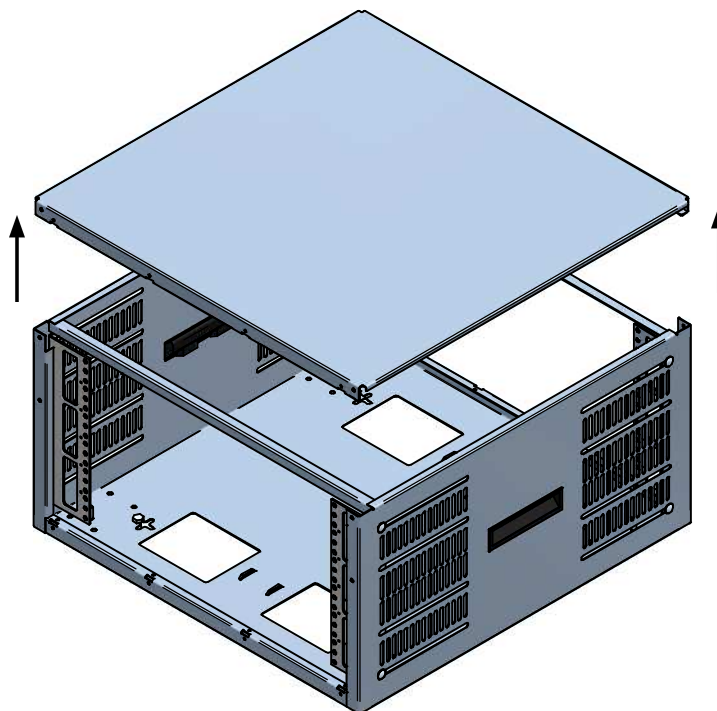

IMPORTANT SAFETY CAUTIONS

NOTE: Read all instructions before installing and using the product.



Installation and assembly must be performed by qualified personnel.



Ensure that the floor/wall structure is able to withstand the weight of the cabinet while fully loaded.



Route all chords and cables away from moving parts and all possible pinch points.



Ensure unit is plumb and level for proper operation.



Always fully mount and secure enclosure or rack system before loading equipment.



Evenly distribute all mounted loads and equipment to ensure stability within the system.



To reduce risk of personal injury and product damage always ensure a sufficient amount of personnel are present when loading, unloading, and moving the enclosure or rack system.



The following parts are not effectively bonded to the Protective Earth Terminal (PET): Mounting rails, Cover, Panels, and Door. If any part needs to be bonded to the PET it shall be done in accordance with Article 250 of the National Electric Code.



Suitable for mounting on concrete or other noncombustible surface only.

LOADING RACK SYSTEM

NOTE: When loading equipment into the enclosure or rack system ensure weight is distributed so that heavier loads are placed towards the bottom of the rack to avoid unstable conditions.

Wall (Rack-Mounted)	Maximum Weight Capacity: 150 lb
---------------------	---------------------------------

Wall (Rails Removed)	Maximum Weight Capacity: 50 lb
----------------------	--------------------------------

Ceiling/Under Desk	Maximum Weight Capacity: 150 lb
--------------------	---------------------------------

Freestanding	Maximum Weight Capacity: 800 lb
--------------	---------------------------------



WALLMOUNT INSTRUCTIONS

1

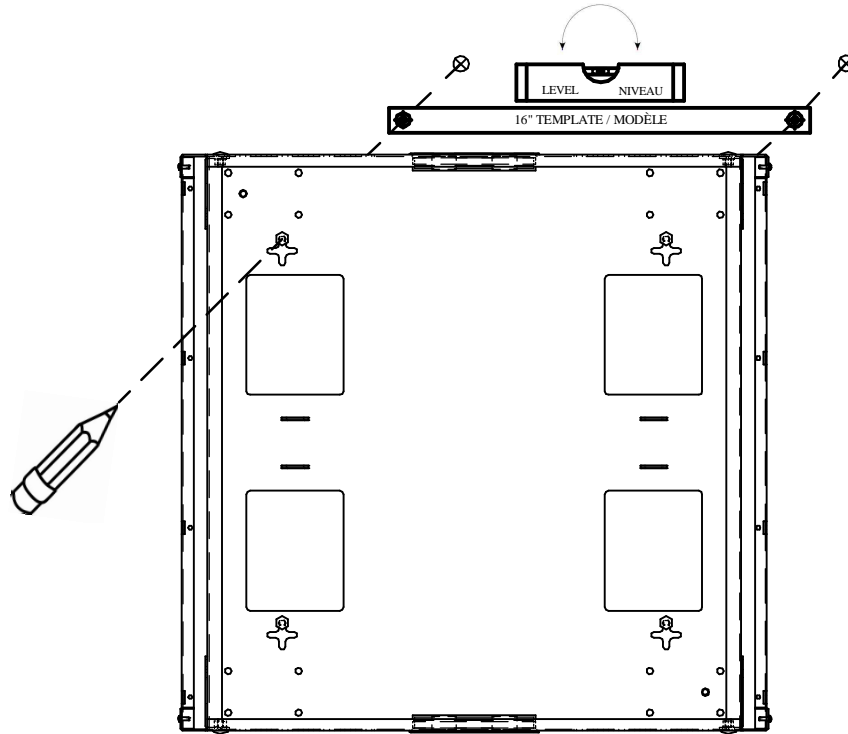

2

ENGLISH
Different wall materials require different types of screws. Choose screws that are suitable for use in your wall.

FRANÇAIS
Différents matériaux de mur requièrent différents types de vis. Choisir les vis appropriées à votre mur.

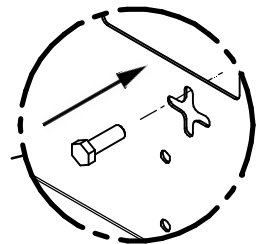
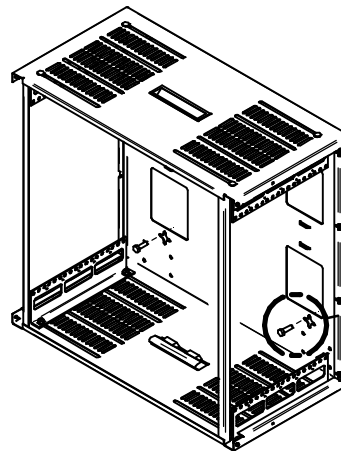

GROUNDING AND BONDING INSTRUCTIONS

1 Included within optional grounding kit (GRDKIT01):



4 x 1/4-20
Locking Nut



4 x 1/4-20
Slotted Screw
Pan Head



4 x 1/4"
Flat Washer



4 x 10-32
Locking Nut



4 x 10-32
Phillips Screw
Pan Head



4 x #10
Flat Washer



4 x 1/4"
Tooth Lock
Washer



4 x #10
Tooth Lock
Washer

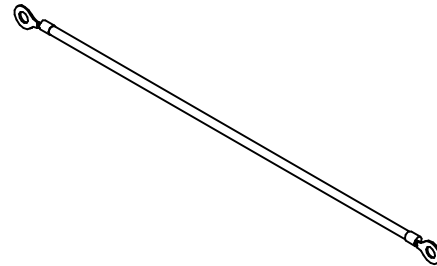

2 x Bonding Wire
10 Gauge
1/4" Ring Terminals

NOTE: PROTECTIVE EARTH TERMINALS (PET) ARE LABELLED WITH THE PROPER SYMBOL SHOWN IN FIGURE 1 AND ARE THE ONLY TERMINALS TO WHICH THE PROTECTIVE EARTH GROUND CONNECTION SHALL BE ATTACHED TO.



FIGURE 1

NOTE: ALL PROTECTIVE EARTH AND BONDING CONNECTIONS SHALL BE IN ACCORDANCE WITH ARTICLE 250 OF THE NATIONAL ELECTRIC CODE.



2

Main Protective Grounding

When grounding the rack system or enclosure it is essential that the main protective ground is connected and secured first with its own nut before any bonding connections are made on top. (Figure 2)

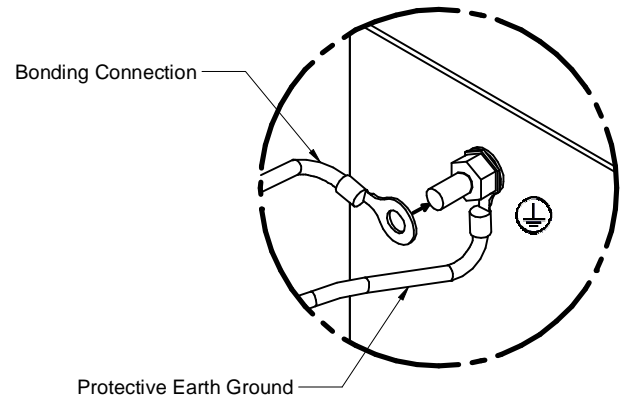
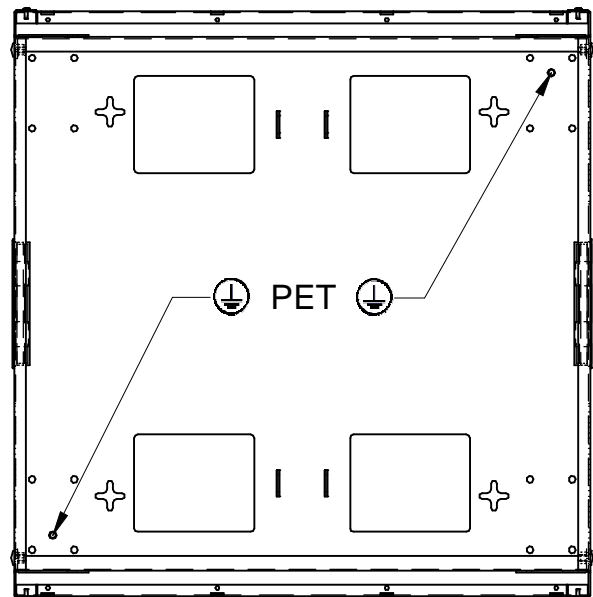

Figure 2

3

Bonding Connections

Accessories: To bond doors, panels, and rails to the SDC unit follow the method from above and connect the accessory bonding stud to one (1) of the Permanent Earth Terminals (PET) on the main body of the SDC



TOP VIEW

