

1481L3R- LOUVER KIT

BUL86422

REV. C

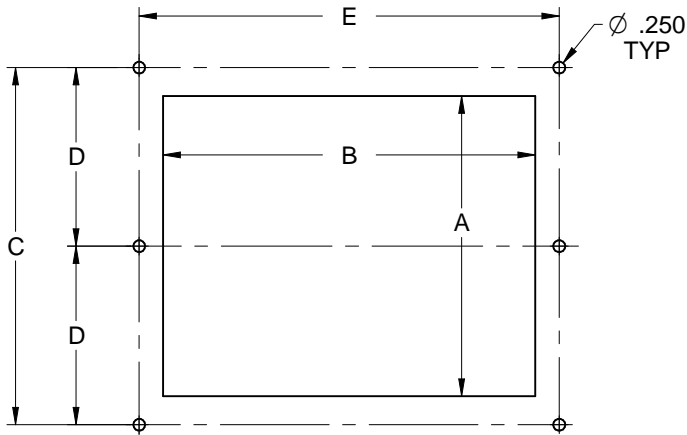

STEP # 1
(CUTOUT DETAIL)

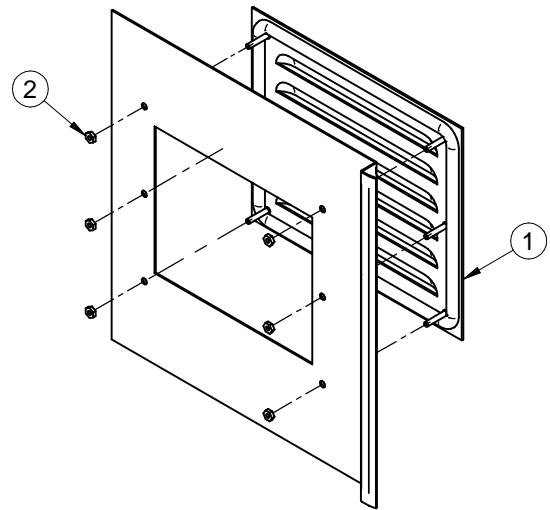

STEP # 2
(LOUVER PLATE INSTALLATION)

PART #	A	B	C	D	E
1481L3R55GY	3.00	2.75	4.00	N/A	3.75
1481L3R55SS	3.00	2.75	4.00	N/A	3.75
1481L3R56GY	2.88	3.75	3.75	N/A	4.75
1481L3R56SS	2.88	3.75	3.75	N/A	4.75
1481L3R66GY	4.00	3.75	4.87	N/A	4.75
1481L3R66SS	4.00	3.75	4.87	N/A	4.75
1481L3R68GY	3.50	5.75	4.87	N/A	6.75
1481L3R88GY	5.75	5.75	7.13	3.56	6.75
1481L3R610GY	3.75	7.75	5.06	N/A	8.75
1481L3R810GY	6.25	7.75	7.44	3.72	8.75
1481L3R1110GY	8.50	7.75	9.81	4.90	8.75
1481L3R1510GY	13.25	7.75	14.56	7.28	8.75

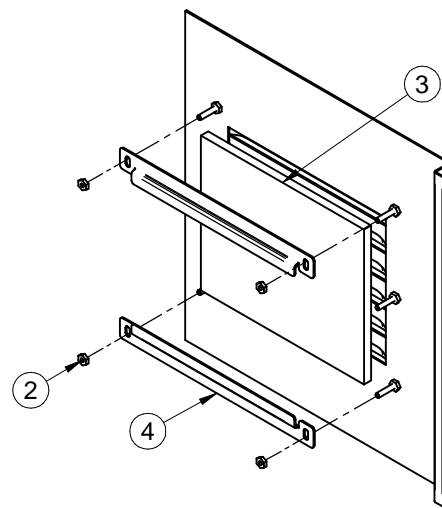

STEP # 3
(FILTER/BRACKET INSTALLATION)

ASSEMBLY INSTRUCTIONS:

- A) Create cutout pattern as per STEP # 1.
- B) Assemble the louver plate using the supplied hardware as shown in STEP # 2.
- C) Install the filter and brackets using the supplied hardware as shown in STEP # 3.
- D) Place UL/CSA label next to louver kit.

ITEM #	QTY	DESCRIPTION
1	1	LOUVER PLATE
2	8 or 10	10-32 KEp NUTS
3	1	FILTER
4	2	FILTER BRACKETS
5	1	UL/CSA LABEL (not shown)

