

GMCBU-AUX11/GMCBU-ALM11 INSTRUCTION MANUAL(UL489)

⚠ Before installation, wiring, operation, maintenance and inspection of the device, be sure to read the operating instructions carefully to ensure proper operations.

Customer Center-Quick Responsive, Excellent technical support
TEL, 1-800-633-0405 | Home page, <http://www.AutomationDirect.com>

Specifications in this catalog are subject to change without notice due to continuous product development and improvement.

1. Ratings

Type	GMCBU-AUX11 GMCBU-ALM11	
Rated Control Current	AC	6A @240V 3A @415V
	DC	6A @24V 2A @48V 1A @125V
Electrical Endurance	10,000 operations	
Terminal Wire Capacity	14 AWG (Use copper wire rated for 65°C)	
Normal Ambient Temperature	-5 to 40°C	

	OFF	TRIP	ON
MCB			
GMCBU-AUX11			

	OFF	TRIP	ON
MCB			
GMCBU-ALM11			

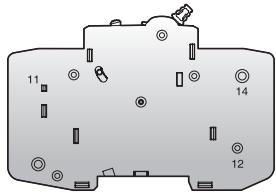

[GMCBU-AUX11]

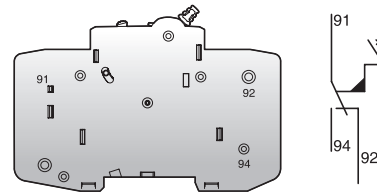

[GMCBU-ALM11]



2. Installation

- ※ GMCBU-AUX11/GMCBU-ALM11 can be attached to applicable products up to two regardless of the type and order of attachment
- ※ Applicable: GMCBU

- 1) Remove Aux cover from MCB
- 2) Turn handles of Accessory and MCB to OFF position
- 3) Adjust the accessory hole so it can be connected to the pin with the accessory, and adjust the location to insert the handle

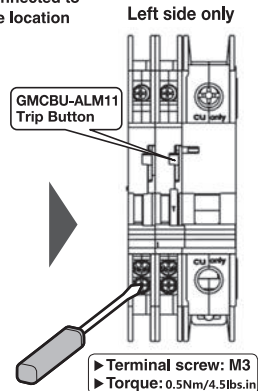
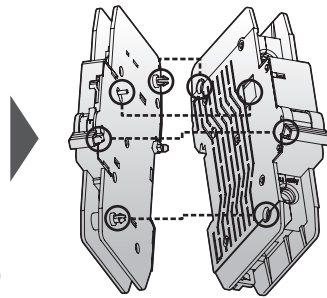
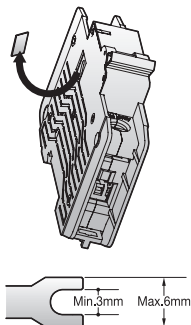

3. Safety Precaution

- ⚠ **DANGER:** Not following instructions could result in death or serious injury.
- ⚠ **CAUTION:** Not following instructions could result in minor injury or physical damage.

⚠ DANGER

- 1) Turn off the upstream circuit breaker before installing or service to prevent electric shocks and burns due to short circuit.
- 2) Do not touch any live naked terminals. It makes an electric shock.
- 3) Do not touch two live lines simultaneously. The circuit breaker does not operate even if an electric shock occurs.

⚠ CAUTION

- 1) Installation by qualified electrician only, per NEC.
- 2) Do not install the circuit breaker in place of environment with shock, high temperature, humidity, dust, corrosive gases, excessive vibration, etc. to prevent fire accidents and malfunction of the device.
- 3) Use the breaker in a range of the rated voltage and current shown on the name plate. Or it may cause malfunction.

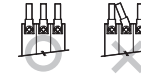

- 4) Each terminal or conductor pole should be connected in parallel as shown below.
- 5) Be sure to ground the ground terminals of electrical devices.
- 6) When the circuit breaker trips, remove the fault and turn the handle "ON". Or else, it may lead to the fire accident.
- 7) Do not modify the device unless it is permitted.
- 8) When the device become useless, it should be dispose of them as an industrial waste.
- 9) In order to fix MCB in DIN-Rail, install end bracket on the both MCB side, After wiring.

4. Dimension

