

**⚠ DANGER / DANGER / PELIGRO**

**HAZARDOUS VOLTAGE**

- This equipment must be installed and serviced only by qualified electrical personnel.
- Turn off all power supplying this equipment before working on or inside equipment.
- Always use a properly rated voltage sensing device to confirm power is off.
- Replace all devices, doors, and covers before turning on power to this equipment.

**Failure to follow these instructions will result in death or serious injury.**

**TENSION DANGEREUSE**

- L'installation et l'entretien de cet appareil ne doivent être effectués que par du personnel qualifié.
- Coupez l'alimentation de cet appareil avant d'y travailler.
- Utilisez toujours un dispositif de détection de tension à valeur nominale approprié pour confirmer que toute alimentation est coupée.
- Remplacez tous les dispositifs, les portes et les couvercles avant de mettre cet appareil sous tension.

**Si ces précautions ne sont pas respectées, cela entraînera la mort ou des blessures graves**

**TENSION PELIGROSA**

- Solamente el personal de mantenimiento eléctrico especializado deberá instalar y prestar servicios de mantenimiento a este equipo.
- Desenergice el equipo antes de realizar cualquier trabajo en él.
- Siempre utilice un dispositivo detector de tensión adecuado para confirmar la desenergización del equipo.
- Vuelva a colocar todos los dispositivos, las puertas y las cubiertas antes de energizar este equipo.

**El incumplimiento de estas precauciones podrá causar la muerte o lesiones serias.**

Dual dimensions in/mm  
Double dimensions in/mm  
Doble dimensiones in/mm

USED WITH

- FS HADB6
- FBCC30CDT / FBCC30SNCDDT / FBCC30PNCDDT
- FBJ30CDT / FBJ30SNCDDT / FBJ30PNCDDT
- SCV30 / SCV30SN / SCV30PN

SWITCHES

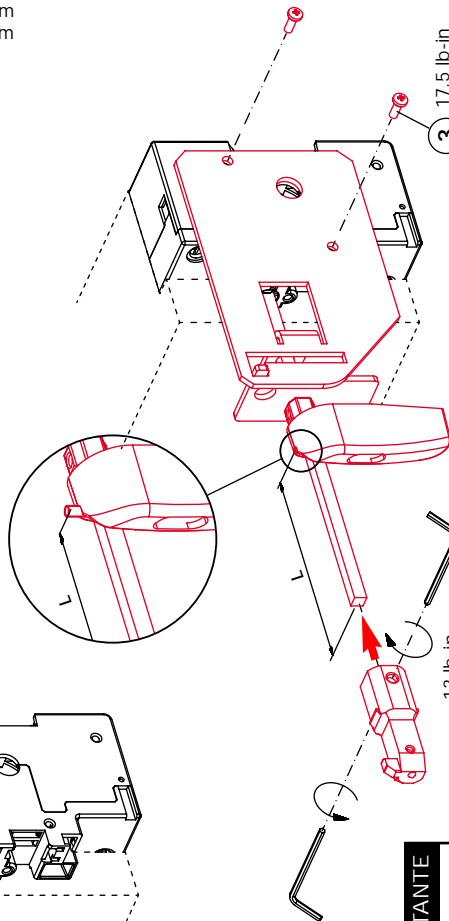
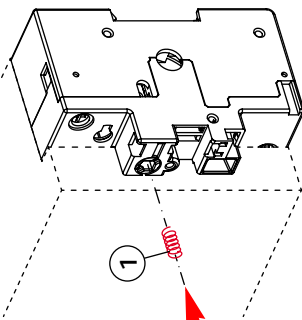

- 17.5 lb-in / 2 Nm
- 13 lb-in / 1.5 Nm
- Allen key size 2 / 6 pans de 2

Padlocking  
Cadenassage  
Bloqueable

max. Ø 0.31 in / Ø 8 mm  
min. Ø 0.19 in / Ø 5 mm

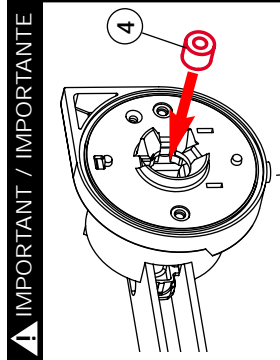
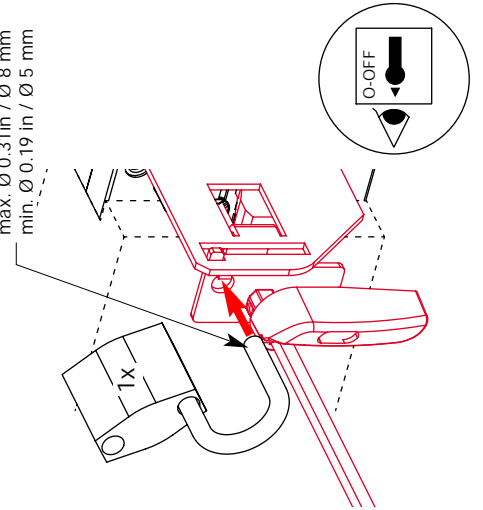

**⚠ IMPORTANT / IMPORTANTE**

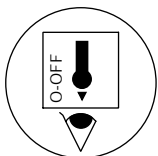
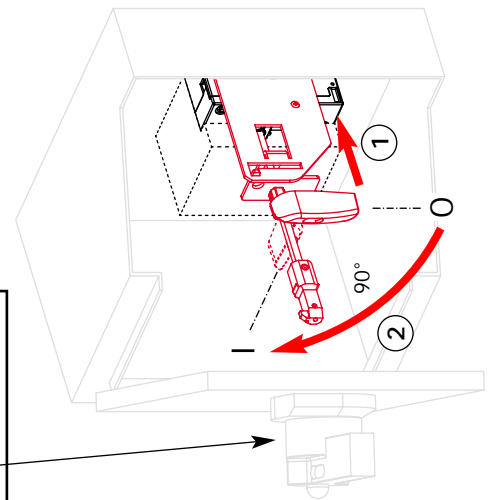

**⚠ min. 1 in / 25,5 mm  
max. 1.12 in / 28,5 mm**

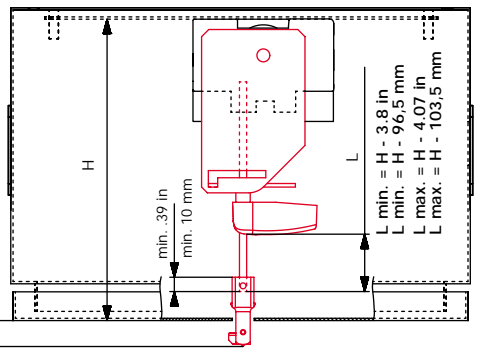

**SWITCHES**

**USED WITH**

For these references, see IS 531802

FBCC30T / FBCC304T	FBCC30 / FBCC304
FBJ30T / FBJ304T	FBJ30 / FBJ304
FBJ60T / FBJ604T	FBJ60 / FBJ604
FBJ100T / FBJ1004T	FBJ100 / FBJ1004
FBJ200T / FBJ2004T	FBJ200 / FBJ2004
FBJ400T / FBJ4004T	FBJ400 / FBJ4004

SCV60 / SCV604  
 SCV100 / SCV1004  
 SCV200 / SCV2004  
 SCV400 / SCV4004

FS HADB8

**!** Remove the screw before mounting the kit.  
 Oter la vis avant le montage du kit.  
 Quitar el tornillo antes el montaje del kit.

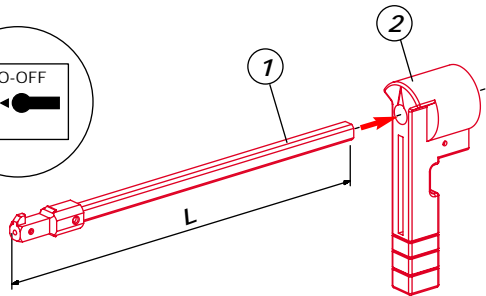
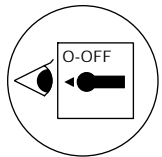

**min. 1.02 in / 26 mm**  
**max. 1.14 in / 29 mm**

H

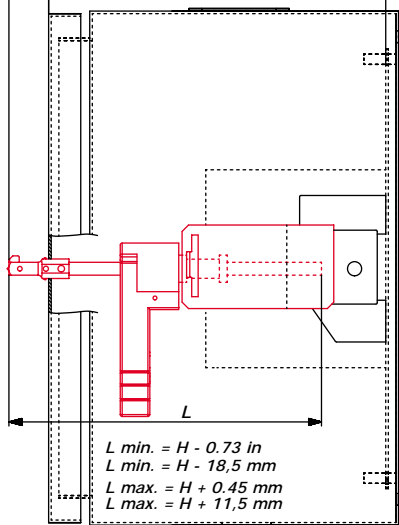

**!** IMPORTANT / IMPORTANTE

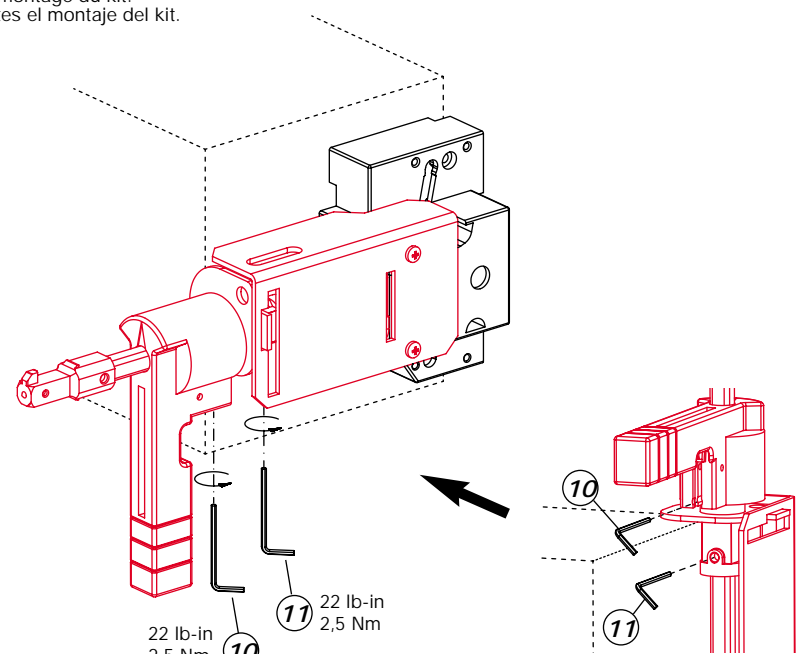
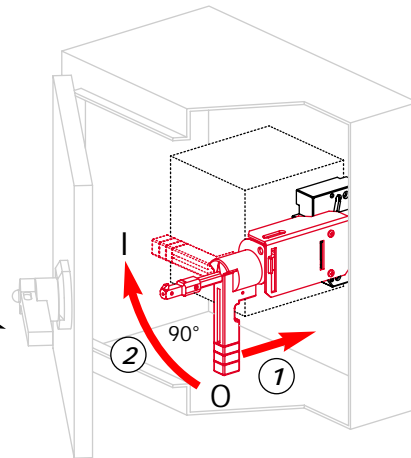
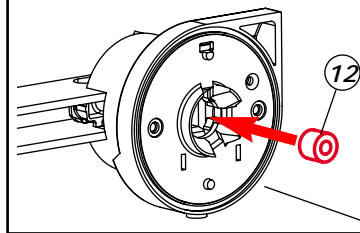

Padlocking  
 Cadenassage  
 Bloqueable

max. Ø 0.31 in / Ø 8 mm  
 min. Ø 0.19 in / Ø 5 mm

