

⚠ DANGER / DANGER / PELIGRO

HAZARDOUS VOLTAGE

- This equipment must be installed and serviced only by qualified electrical personnel.
 - Turn off all power supplying this equipment before working on or inside equipment.
 - Always use a properly rated voltage sensing device to confirm power is off.
 - Replace all devices, doors, and covers before turning on power to this equipment.
- Failure to follow these instructions will result in death or serious injury.

TENSION DANGEREUSE

- L'installation et l'entretien de cet appareil ne doivent être effectués que par du personnel qualifié.
 - Coupez l'alimentation de cet appareil avant d'y travailler.
 - Utilisez toujours un dispositif de détection de tension à valeur nominale approprié pour confirmer que toute alimentation est coupée.
 - Remplacez tous les dispositifs, les portes et les couvercles avant de mettre cet appareil sous tension.
- Si ces précautions ne sont pas respectées, cela entraînera la mort ou des blessures graves

TENSION PELIGROSA

- Solamente el personal de mantenimiento eléctrico especializado deberá instalar y prestar servicios de mantenimiento a este equipo.
 - Desenergice el equipo antes de realizar cualquier trabajo en él.
 - Siempre utilice un dispositivo detector de tensión adecuado para confirmar la desenergización del equipo.
 - Vuelva a colocar todos los dispositivos, las puertas y las cubiertas antes de energizar este equipo.
- El incumplimiento de estas precauciones podrá causar la muerte o lesiones serias.

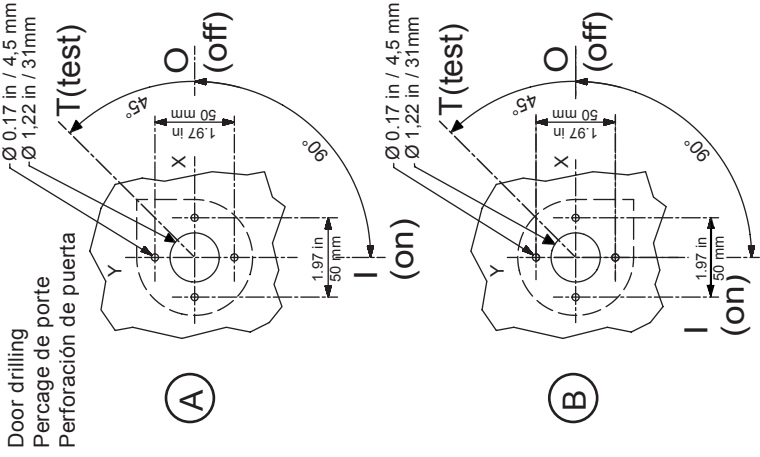

Dual dimensions in/mm
Double dimensions in/mm
Doble dimensiones in/mm

FBCC30CDT / FBCC30PNCDT / FBCC30SNCDT
FBJ30CDT / FBJ30PNCDT / FBJ30SNCDT
SCV30 / SCV30PN / SCV30SN

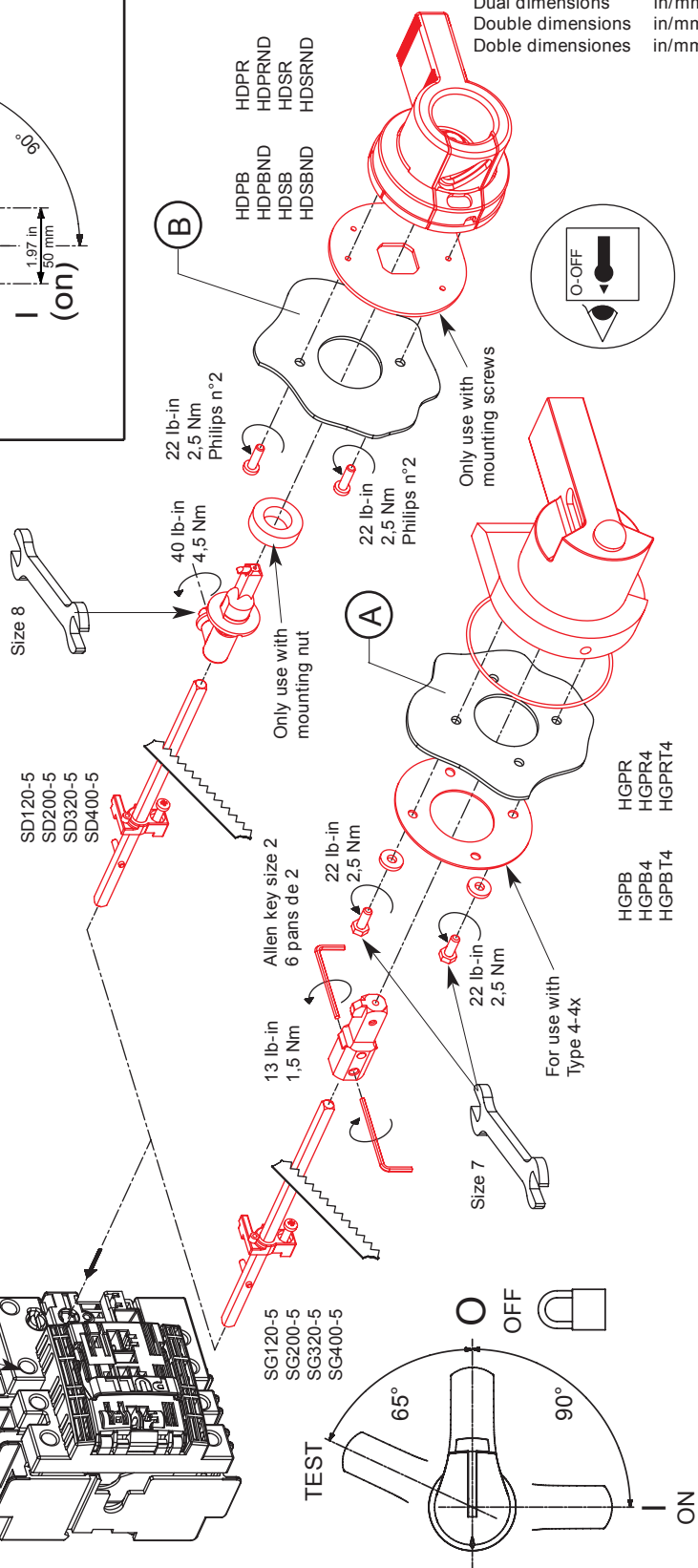
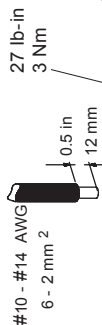
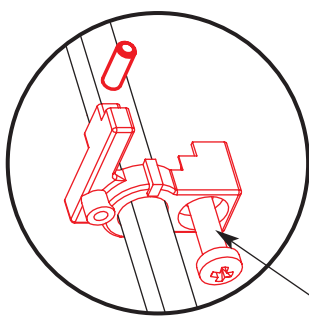
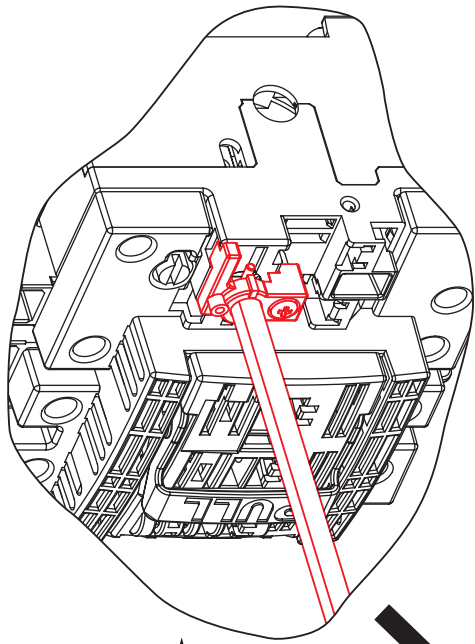

RECTO-VERSO / S blanc offset 100g/m² / I Noire pantone black C - Rouge pantone 485U / F 210x297 / P 105x74.25

Shaft length
Longueur d'axe
Longitud del eje

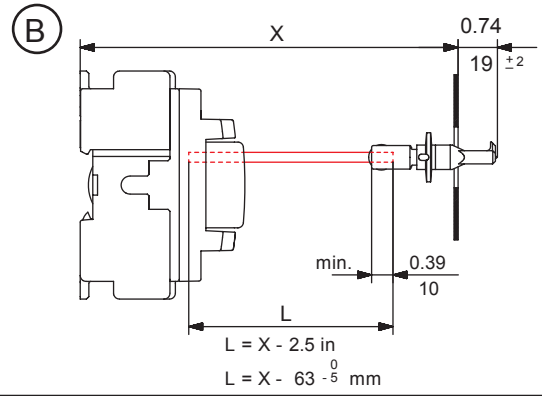
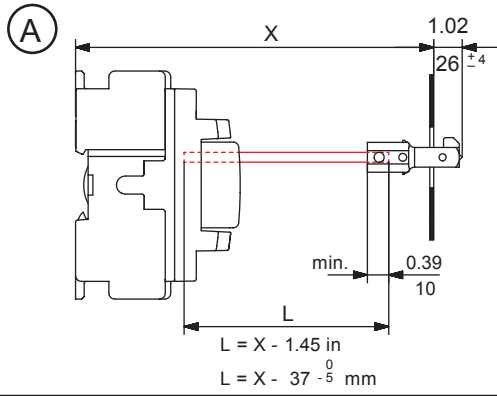

FBCC30CDT / FBCC30PNCDT / FBCC30SNCDT
 FBJ30CDT / FBJ30PNCDT / FBJ30SNCDT (Max : 2 Auxiliary contacts / 2 CA / 2 contactos)
 SCV30 / SCV30PN / SCV30SN

Max : 4 Auxiliary contacts
 Max : 4 CA
 Max : 4 contactos
 auxiliares

1 NO (F) : AC3
 1 NC (O) : AC4

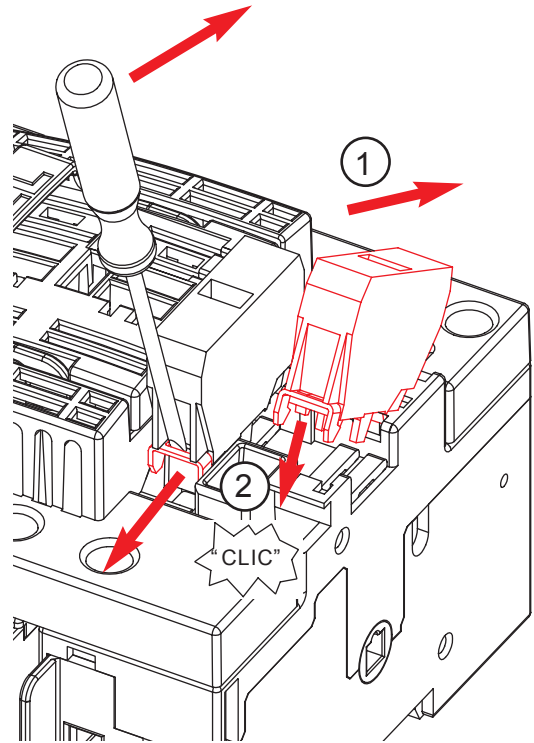
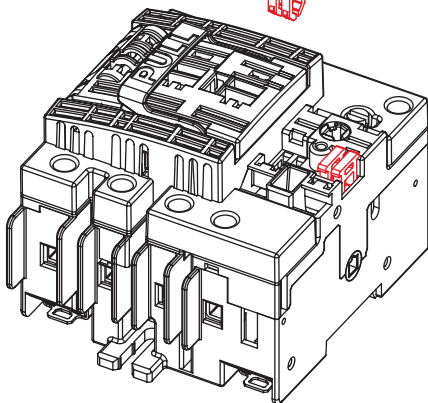
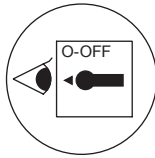

Max : 4 Auxiliary contacts
 Max : 4 CA
 Max : 4 contactos
 auxiliares

1 NO (F) : AC3
 1 NC (O) : AC4

■ Peg
 ■ Pousoir
 ■ Leva
 □ No peg
 □ Pas de pousoir
 □ No leva

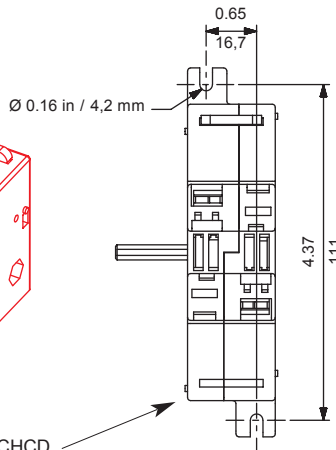
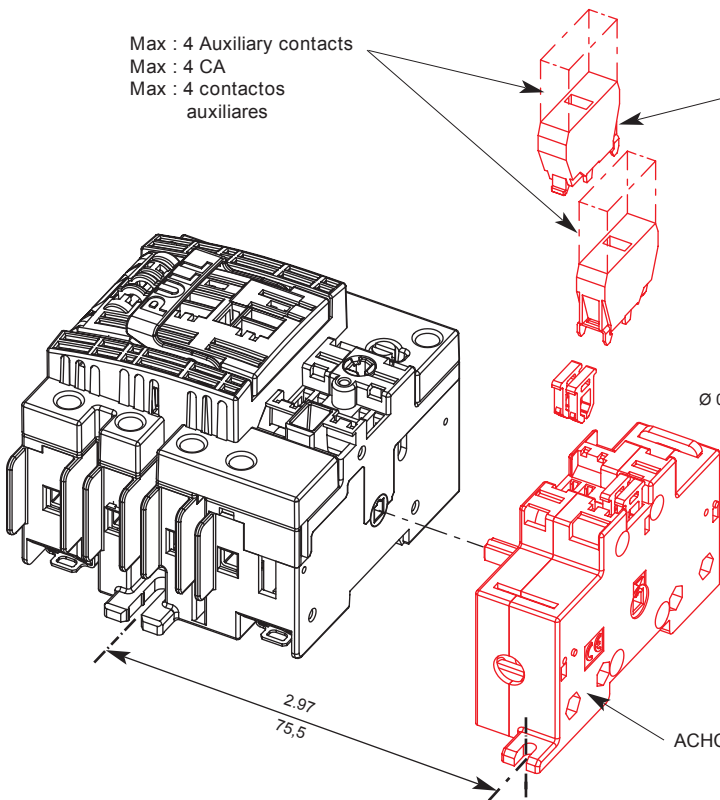

TEST

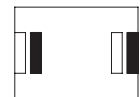

ON



ON + TEST

