

Installation Instructions for E & G-Frame 3-Wire Terminal Connector Kit Catalog No. 3TA100G3K

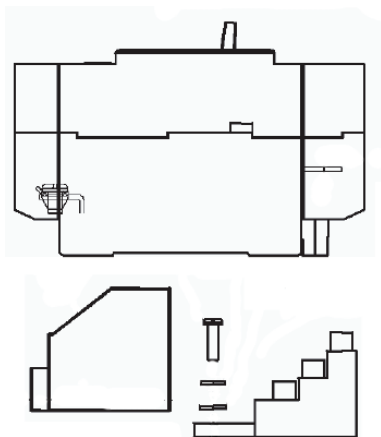

Contents

Description	Page
Introduction	2
Installation	2
Field Wiring	3



WARNING

DO NOT ATTEMPT TO INSTALL OR PERFORM MAINTENANCE ON EQUIPMENT WHILE IT IS ENERGIZED. SEVERE PERSONAL INJURY, DEATH, OR SUBSTANTIAL PROPERTY DAMAGE CAN RESULT FROM CONTACT WITH ENERGIZED EQUIPMENT. ALWAYS VERIFY THAT NO VOLTAGE IS PRESENT BEFORE PROCEEDING WITH THE TASK, AND ALWAYS FOLLOW GENERALLY ACCEPTED SAFETY PROCEDURES.

EATON IS NOT LIABLE FOR THE MISAPPLICATION OR MISINSTALLATION OF ITS PRODUCTS.

The user is cautioned to observe all recommendations, warnings, and cautions relating to the safety of personnel and equipment, as well as, all general and local health and safety laws, codes, and procedures.

The recommendations and information contained herein are based on Eaton experience and judgement, but should not be considered to be all-inclusive or covering every application or circumstance which may arise. If any questions arise, contact Eaton.

1. INTRODUCTION

For use on Eaton E & G-Frame Circuit Breakers, Molded Case Switches and Motor Circuit Protectors. This kit is U.L. Listed for field installation on the "LOAD END" terminals.

Table 1-1.
E & G-Frame 3-Wire 1 Terminal Connector Kit Contents:
3 – Multi-Wire Connectors
3 – Molded Insulators
3 – #10-32 Mounting Screws
3 – #10 Flat Washers
3 – #10 Lock Washers
1 – Torque Label
3 – #10 Nut

① Wire Range #14-#2 AWG (Maximum 3) Copper or Aluminum Wires



CAUTION

THE PURPOSE OF THESE CONNECTORS IS TO DISTRIBUTE POWER TO MORE THAN ONE LOAD AND ARE TO BE INSTALLED ONLY ON THE "LOAD END" OF THE CIRCUIT BREAKER.



WARNING

CONDUCTORS SIZED FOR LOAD CURRENTS LOWER THAN THE CIRCUIT BREAKER RATING WILL NOT BE PROTECTED BY THE CIRCUIT BREAKER. EACH LOAD CONDUCTOR MUST BE PROTECTED BY AN INDIVIDUAL OVERCURRENT DEVICE, AND MEET ANY ADDITIONAL REQUIREMENTS OF THE NATIONAL ELECTRIC CODE.

2. INSTALLATION

If circuit breaker is installed in equipment, it MUST be removed for installation of this kit. This kit is intended for use ONLY on the LOAD END of the circuit breaker. G breaker must be either a "Special Purpose Only Breaker" with tapped terminals or be supplied with aluminum single wire connectors.



CAUTION

SUPPLIED MOLDED INSULATORS MUST BE INSTALLED TO MAINTAIN ELECTRICAL SPACINGS.

2-1. For breakers equipped with:

a. Tapped Terminals (Refer to Fig. 2-1):

- 1a. Remove and discard existing LOAD END wire connectors (saddle clamp and screw) from breaker.
- 2a. Place Kit Multi-Wire Connector into Molded Insulator as shown.
- 3a. Place Molded Insulator and Multi-Wire Connector on top of breaker terminal.

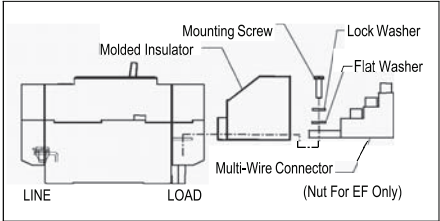

Fig. 2-1. Multi-Wire Terminal Connector Kit
Installation Layout



CAUTION

USE ONLY MOUNTING SCREWS PROVIDED WITH KIT. DO NOT SUBSTITUTE OR ELECTRICAL SPACINGS MAY NOT BE MET.

- 4a. Install provided mounting screw, lock washer and flat washer as shown. Torque mounting screw to 35 in-lbs.
- 5a. Repeat steps 2a through 4a for the remaining poles.
- 6a. Apply Torque Label to side of breaker.

b. E Collar Assemblies (Refer to Fig. 2-1):

- 1b. Gently pry off the existing steel collar and discard.
- 2b. Place Kit Multi-Wire Connector into Molded Insulator as shown.
- 3b. Place Molded Insulator and Multi-Wire Connector on top of breaker terminal.
- 4b. Install provided mounting screw, lock washer and nut as shown. Torque to 35 in-lbs.
- 5b. Repeat steps 2b through 4b for the remaining poles.
- 6b. Apply Torque label to side of breaker.

- c. G Frame Breaker with Installed Aluminum Single Wire Connectors (Refer to Fig. 2-1):
 - 1c. The mounting screw, nut, and washers are not used.
 - 2c. Place Kit Multi-Wire Connector into Molded Insulator as shown.
 - 3c. Loosen the aluminum single wire connector clamping screw sufficiently to permit the tang of the multi-wire connector to fit into the opening.
 - 4c. Insert the tang of the multi-wire connector into the aluminum single wire connector.
 - 5c. Tighten the aluminum single wire connector clamping screw to a torque value of 50 in-lb.

- 2. 2. The circuit breaker may now be installed into equipment

3. FIELD WIRING

Note: It may not be possible to install the largest conductors in adjacent holes due to the wire insulation thickness. Use only connections which allow insertion of wires without undue insulation interference between wires at the connector. When fully inserted into the connector the insulation should be within 1/8 inch of the connector.

Strip wires to lengths shown in Table 2-1.

Table 2-1. Wire strip lengths for connector hole locations	
HOLE POSITION	WIRE STRIP LENGTH
Upper	3/8 to 1/2 inch
Middle	3/4 to 7/8 inch
Lower	1 1/4 to 1 3/8 inch

The instructions for installation, testing, maintenance, or repair herein are provided for the use of the product in general commercial applications and may not be appropriate for use in nuclear applications. Additional instructions may be available upon specific request to replace, amend, or supplement these instructions to qualify them for use with the product in safety-related applications in a nuclear facility.

The information, recommendations, descriptions, and safety notations in this document are based on Eaton's experience and judgment with respect to Retrofitting of Power Breakers. This instructional literature is published solely for information purposes and should not be considered all-inclusive. If further information is required, you should consult an authorized Eaton sales representative.

The sale of the product shown in this literature is subject to the terms and conditions outlined in appropriate Eaton selling policies or other contractual agreement between the parties. This literature is not intended to and does not enlarge or add to any such contract. The sole source governing the rights and remedies of any purchaser of this equipment is the contract between the purchaser and Eaton.

NO WARRANTIES, EXPRESSED OR IMPLIED, INCLUDING WARRANTIES OF FITNESS FOR A PARTICULAR PURPOSE OR MERCHANTABILITY, OR WARRANTIES ARISING FROM COURSE OF DEALING OR USAGE OF TRADE, ARE MADE REGARDING THE INFORMATION, RECOMMENDATIONS, AND DESCRIPTIONS CONTAINED HEREIN.

In no event will Eaton be responsible to the purchaser or user in contract, in tort (including negligence), strict liability or otherwise for any special, indirect, incidental or consequential damage or loss whatsoever, including but not limited to damage or loss of use of equipment, plant or power system, cost of capital, loss of power, additional expenses in the use of existing power facilities, or claims against the purchaser or user by its customers resulting from the use of the information, recommendations and description contained herein.

EATON

Qty. 1 3TA100G3K

**3-Wire Terminal Connector Kit
for E & G-Frame Circuit Breaker**



1 07 86679 09667 0

Eaton Corporation
Electrical Group
1000 Cherrington Parkway
Moon Township, PA 15108
United States
877-ETN-CARE (877-386-2273)
Eaton.com

© 2013 Eaton Corporation
All Rights Reserved
Printed in Dominican Republic
Publication No. IL 29C135F / TBG000475
Part No. 8698CASH06
Effective April 2014