

EA-ECOM

ETHERNET COMMUNICATIONS MODULE

AUTOMATIONDIRECT.com

3505 HUTCHINSON ROAD
CUMMING, GA 30040-5860, USA

The EA-ECOM *C-more* Micro communication module is compatible with all EA3 series *C-more* Micro panels. It adds an Ethernet (RJ45) port for programming and PLC communications at 10/100 Mbps.



Warning: This procedure should only be performed by qualified personnel who are experienced in working with electronic equipment. Take the necessary steps to prevent damage that may be caused by static electric discharge. Disconnect input power to the touch panel before proceeding.



NOTE: SOFTWARE AND FIRMWARE VERSION 4.0 OR LATER IS REQUIRED WITH THE OPTIONAL EA-ECOM ETHERNET MODULE. AVAILABLE FOR DOWNLOAD FREE AT WWW.AUTOMATIONDIRECT.COM



1
Disconnect power from the panel by unplugging the AC power connector. Remove the Expansion Port cover from the rear of the EA3 series panel.

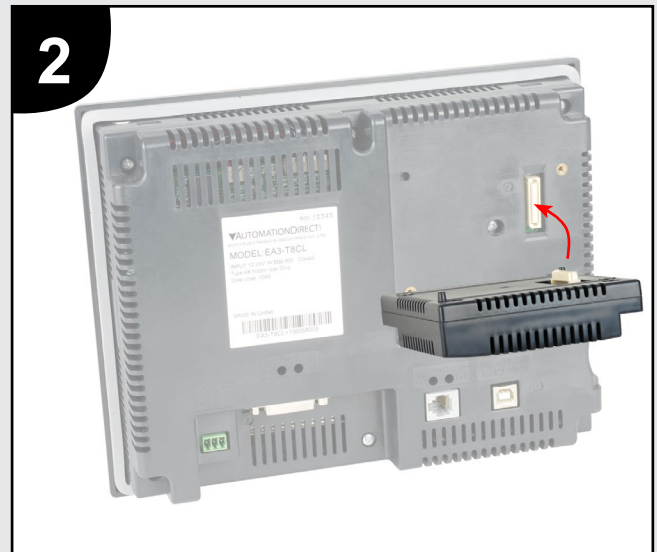

2
Align the EA-ECOM Ethernet module with the Expansion Port and firmly press the EA-ECOM in place.



3
Secure the EA-ECOM by tightening the two captive mounting screws to a torque of 50 oz-in [0.35 N-m].

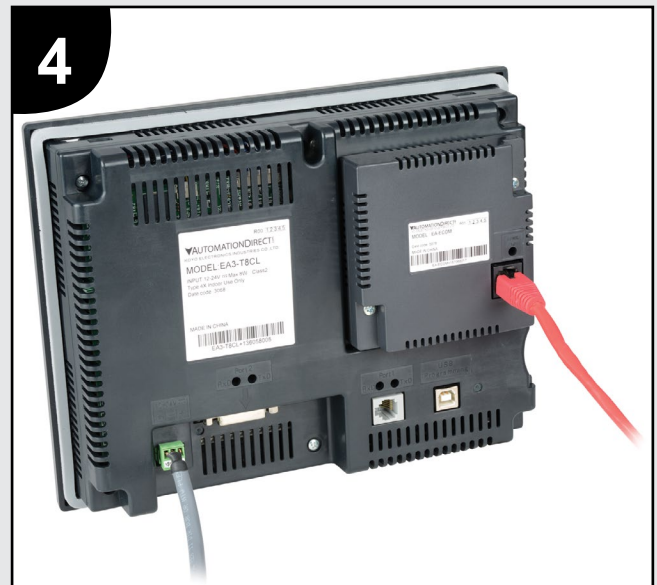

4
Plug in an Ethernet communications cable and reconnect the AC power connector to the EA3 series panel.

EA-ECOM Specifications	
Part Number	EA-ECOM
Operating Temperature	0 to 50 °C (32 to 122 °F) Maximum surrounding air temperature rating: 50 °C
Storage Temperature	-20 to +60 °C (-4 to +140 °F)
Humidity	5–95% RH (non-condensing)
Environmental Air	For use in pollution degree 2 environment
Vibration	IEC60068-2-6 (Test Fc), 5-9 Hz: 3.5 mm amplitude, 9-150 Hz: 1.0G, sweeping, at a rate of 1 octave/min. (±10%), 10 sweep cycles per axis on each of 3 mutually perpendicular axes
Shock	IEC60068-2-27 (Test Ea), 15 G peak, 11ms duration, three shocks in each direction per axis, on 3 mutually perpendicular axes (total of 18 shocks)
Noise Immunity	NEMA ICS3-304 RFI, (145 MHz, 440 MHz 10 W @ 10 cm) Impulse 1000 V @ 1 µs pulse
Emission	EN55011 Class A (Radiated RF emission)
Enclosure (panel door installation)	NEMA 250 type 4/4X indoor use only UL50 type 4X indoor use only IP-65 indoor use only (When mounted correctly)
Agency Approvals	CE (EN61131-2), UL508, CUL Canadian C22.2 To obtain the most current agency approval information, see the Agency Approval Checklist section on the specific part number's web page
UL508 Requirements	All interface ports are intended to be connected to an isolated secondary circuit.
Power Consumption	Max 0.66W (200mA 3.3 VDC)
Input Voltage	3.3 VDC (from panel expansion connector)
Fuse	None
Supply Connector	Panel expansion connector
Mounting Torque	50 oz-in [0.35 N-m]
Weight	0.23 lb [105g]

Ethernet Communication Interface Specifications				
Standard Specification	Conforms to IEEE802.3			
Communication Speed	10/100 Base-T (Automatic Negotiation)			
Cable Specification	Category 5			
Auto MDI / MDI-X	Yes			
Connector Type	RJ45			
Status Lamp	LINK / ACT			
	Color	ON	OFF	Blink
	Green	LINK (Always ON) Properly connected to network	- Not connected to network	ACT Active Network Data

PLC Drivers
<i>AutomationDirect Productivity Series Ethernet</i>
<i>AutomationDirect Do-more / BRX Ethernet</i>
<i>AutomationDirect CLICK Ethernet</i>
<i>AutomationDirect ECOM Ethernet</i>
<i>Modbus TCP/IP</i>
<i>Allen-Bradley EtherNet/IP (Client) SLC5/05</i>
<i>Allen-Bradley EtherNet/IP (Client) ENI Adapter</i>
<i>Allen-Bradley EtherNet/IP (Client) MicroLogix 1100/1400</i>