

cod. 5807470

GH15GT,-HT,-JT

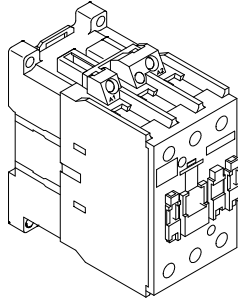

RATINGS ACCORDING TO cULus

Contactor type		GH15GT	GH15HT	GH15JT
Insulation voltage	AC V	600		
General Use	A	60	70	80
Max. power of three-phase motors 60Hz	200V HP	10	15	15
	230V HP	10	15	20
	460V HP	25	30	40
Max. power of single-phase motors 60Hz	575V HP	30	40	50
	115V HP	3	3	5
	230V HP	5	7.5	10
Auxiliary contacts	Rated voltage: 600V AC Switching capacity: A600			

For starter combination use only with overload relay type RTD65

**3-pole contactors
GH15GT,-HT,-JT**

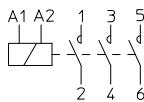

RATINGS ACCORDING TO IEC

Contactor type		GH15GT	GH15HT	GH15JT
Insulation voltage	AC V	690		
Resistive loads AC-1 cat. (open)	A	63	80	100
Max. power of 50-60Hz three-phase motors	230V kW	11	12.5	18.5
	400V kW	18.5	22	30
AC-3 category	440V kW	21	25	33
	500V kW	18.5	22	30
	690V kW	18.5	22	30

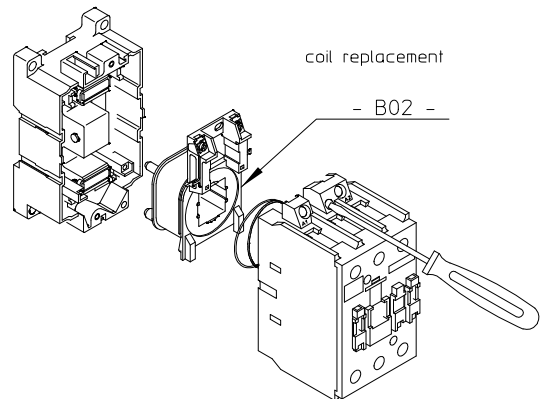
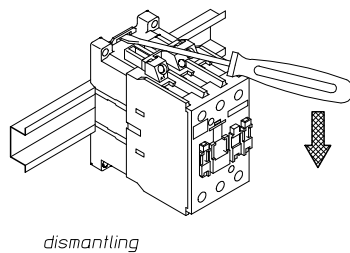
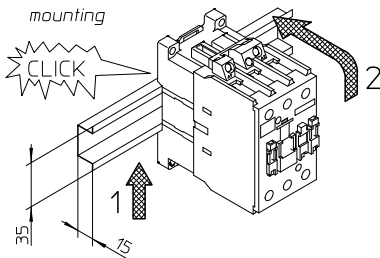

Connections	Size of cable (AWG)		Tightening torque
	Stranded	Solid	
Main circuit <i>Use 75°C copper wire only</i>	12 - 3	-	45 IN. LB.
Auxiliary circuit	16 - 12	14 - 12	7 IN. LB.

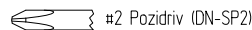
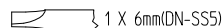

Tighten the screws of unused terminals

		<p>WARNING: Electrical Shock Hazard Installation and maintenance by qualified personnel only. Remove power before servicing. Follow the operating instructions.</p>
--	--	--

MOUNTING

- Do not mount or remove contactor with power connected.
- Provide adequate circuit protection (fuses, circuit breakers) on the supply side of the contactor.
- Working position in the vertical plane: As shown in the drawings.
- Minimum spacing between contactors mounted in a row: 5mm.
- Installation: Check for unrestricted make/break action by manually actuating contactor (POWER OFF) after installation.
- Ensure that control voltage remains within 85%-110% of rated coil voltage.
- Ensure that components driving the coil (switches, control relays, output modules) do not cause unsteady operation of the coil resulting in erratic make/break action of the contactor.

MAINTENANCE

- Noise from the coil indicates that debris has entered the contactor coil area. (Pieces of wire, insulation, iron filings, etc.), to remove debris, disconnect and disassemble the contactor, clean the actuator surfaces.
- Periodically check for contact wear. Contactors can be disassembled down to the contacts.
- If light contact welding occurs, separate the contacts with a screwdriver.
CONTACT WELDING OCCURS WITH HIGH CURRENT CONDITIONS. INVESTIGATE THE CAUSE OF CONTACT WELDING.

ACCESSORIES

**SIDE MOUNTING
 AUXILIARY CONTACT
 BLOCKS**
 (maximum 2 per contactor)

catalog n. GH15S11 contact types 1NO-1NC

**TOP MOUNTING
 AUXILIARY CONTACT
 BLOCKS**

catalog n. GH15T10 GH15T01 contact types 1NO 1NC

catalog n. GH15T40 GH15T31 GH15T22 GH15T11 contact types 4NO 3NO-1NC 2NO-2NC 1NO-1NC

**MECHANICAL
 INTERLOCK**

catalog n. BM0H

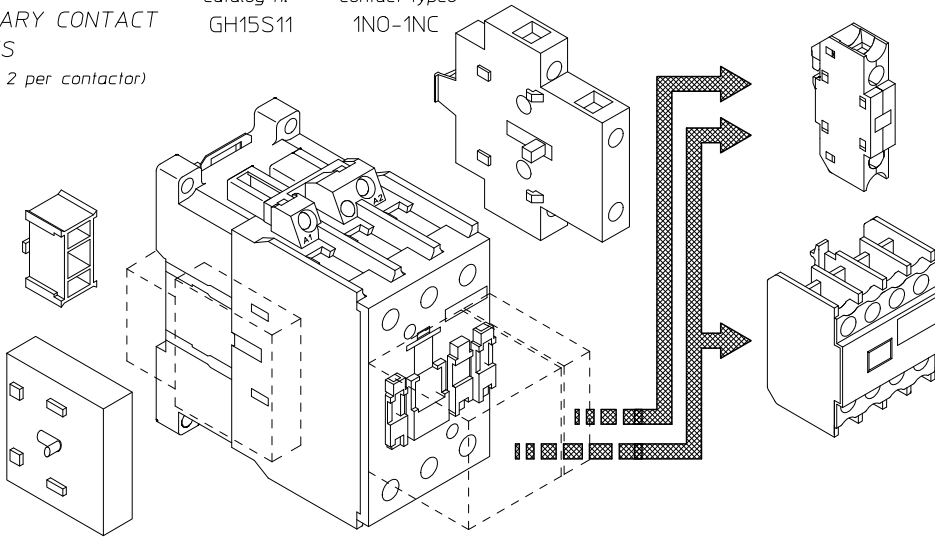

BM0H mechanical interlock assembly instructions

1. Fit the mechanical interlock 1 on one side of the contactor, as shown, by inserting the driving pin into the notch of the movable part of the contactor
 2. Connect the second contactor by repeating the above
 3. Join the contactors by inserting the block 2
 4. Check the interlock by driving the contactors manually
- * This procedure requires a "feel" for the process. **PRATICE & PATIENCE** is the key.

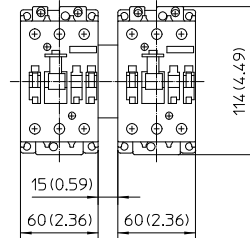
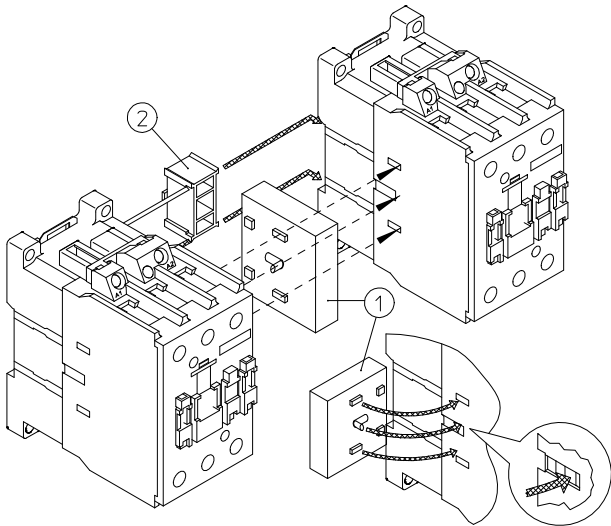

Overall dimensions and mounting specifications in mm (inches)

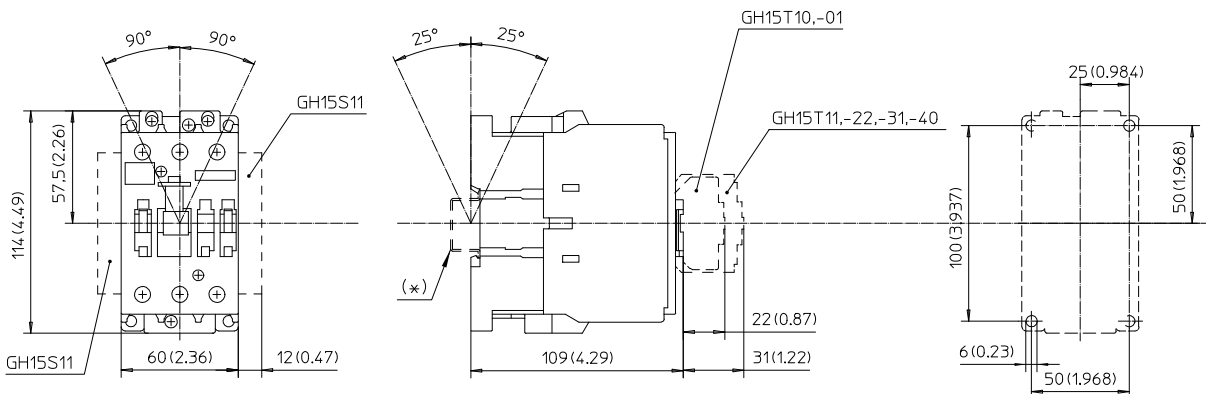

(*)when DIN rail is not mounted horizontally, use an End Bracket (DN-EB35) or equivalent to secure contactor(s).