

PRODUCT DESCRIPTION:

FEP_KP1_M

PRODUCT CODE:

fep5kp1fa8-024m

DYNAMIC 3D VIEW:

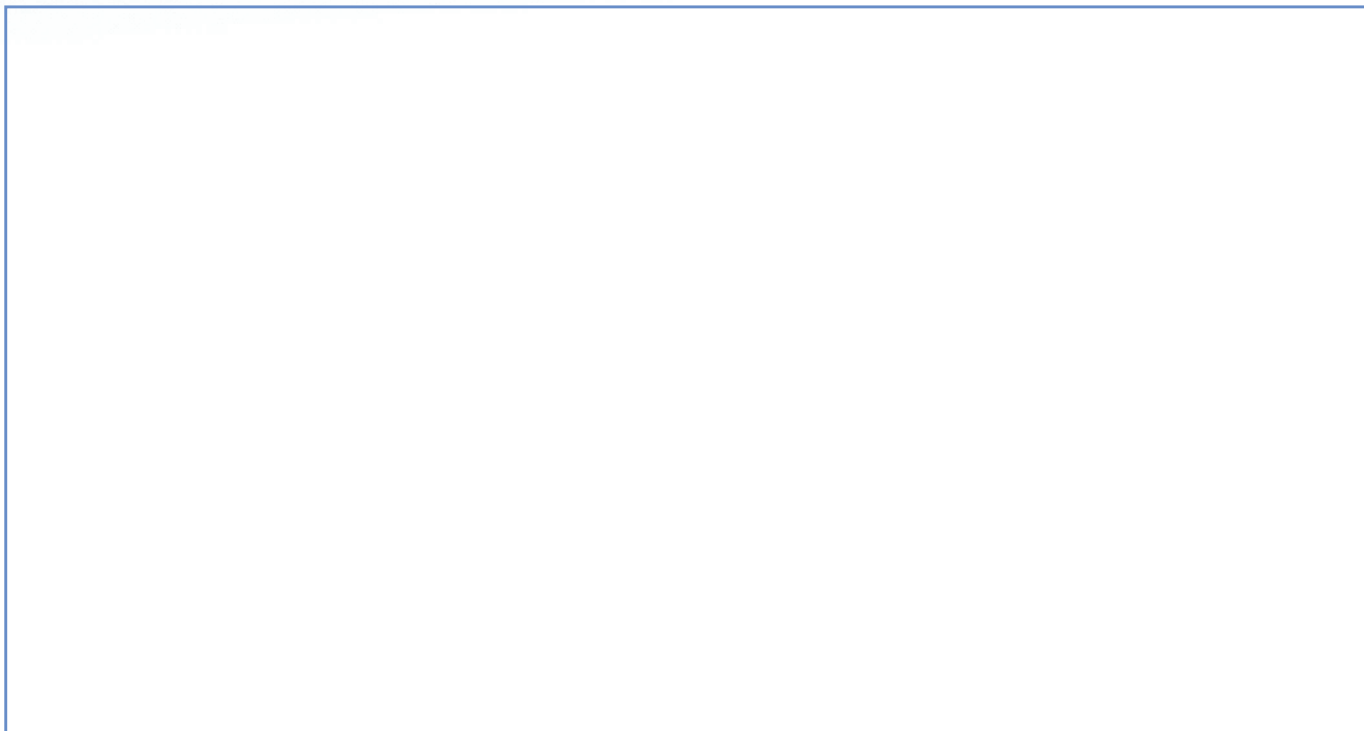

STATIC 3D VIEW:

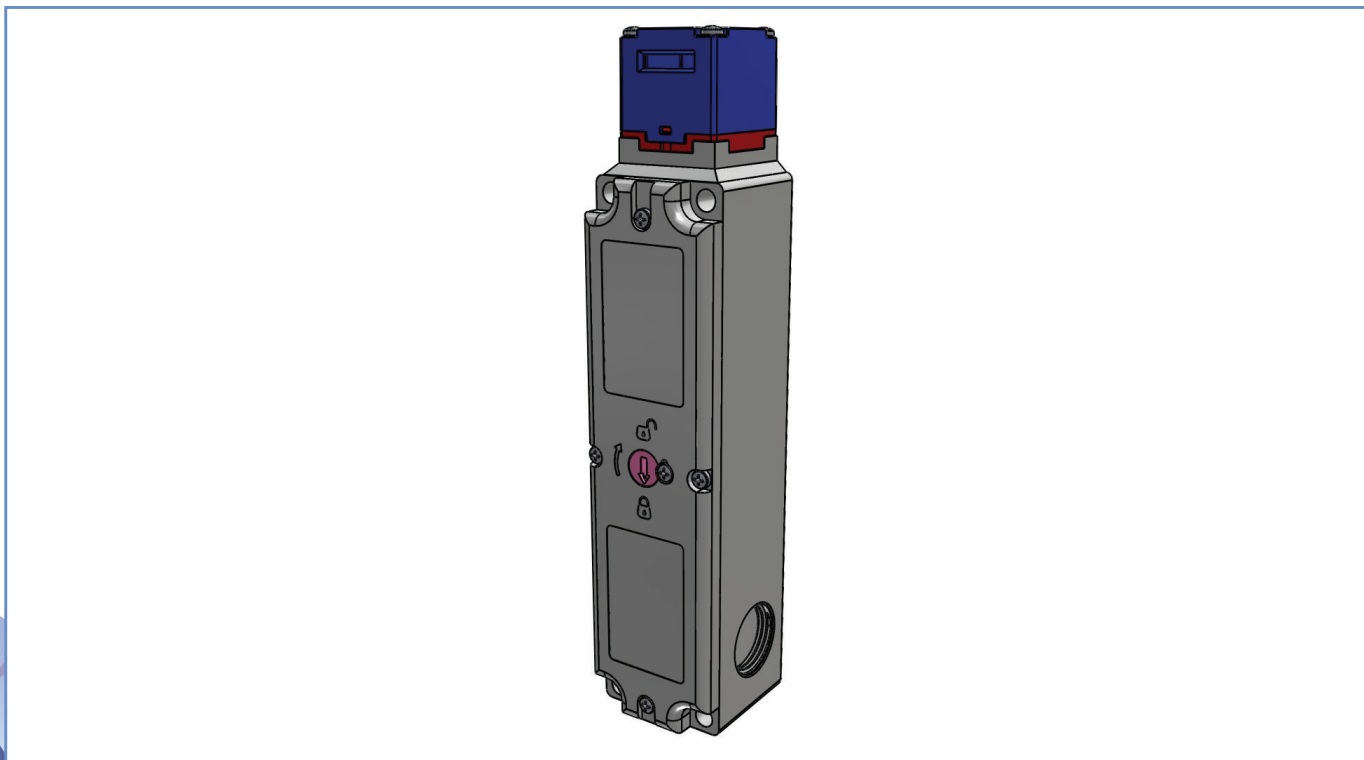

TECHNICAL VIEW:

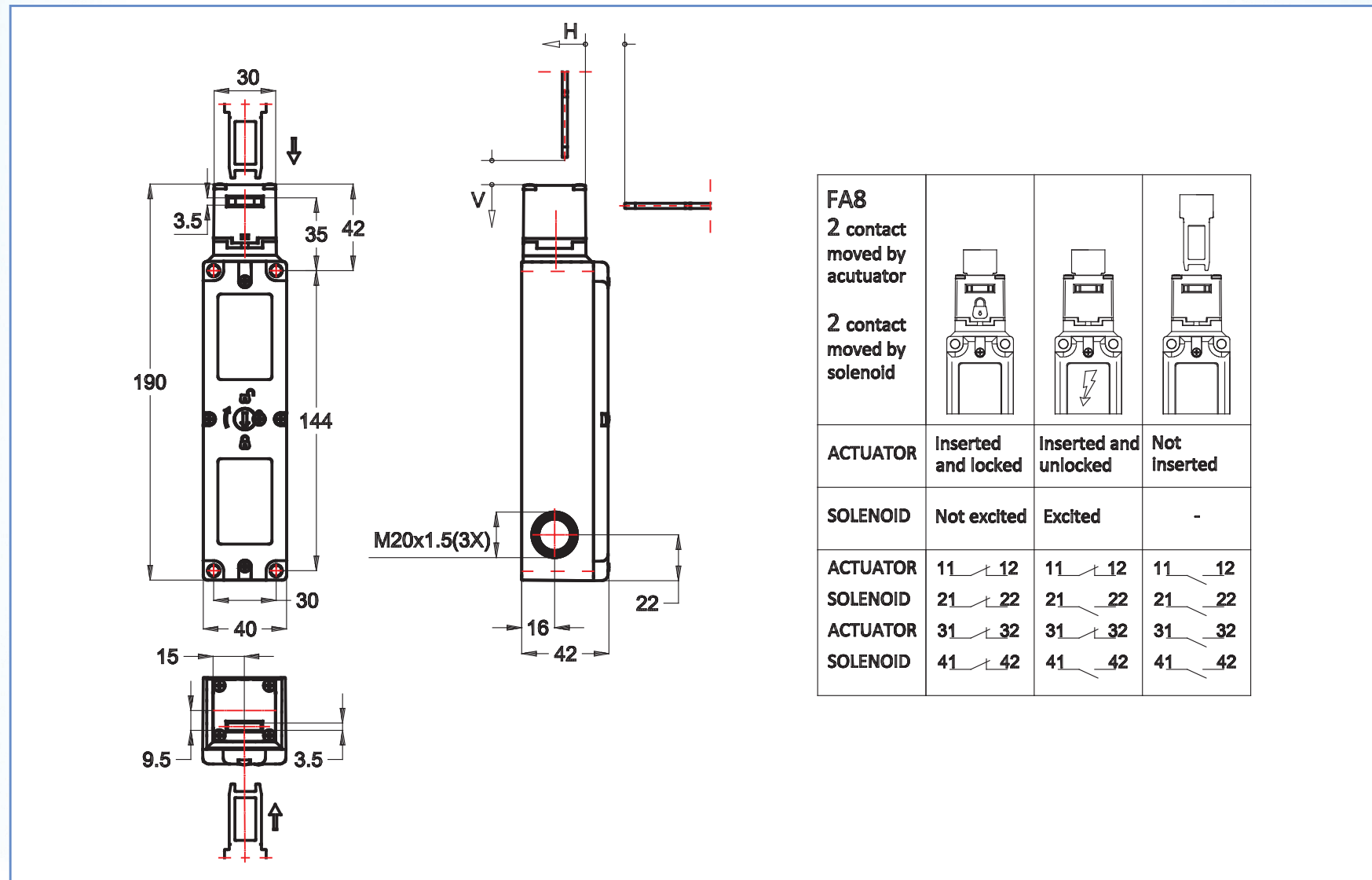

DETAILS:

Part Number	fep5kp1fa8-024m
Casing Material	Reinforced thermoplastic
Width [mm]	40
Electrical connections	Three threaded cable inlets for M20x1.5 cable glands
IP Degree of Protection	IP65
Actuating Head	Separated actuator
Head Material	Thermoplastic head
Head orientation	Standard 0°
Principle of operation	Mechanical interlock
Unlock	With screw release
Solenoid power supply [V]	24V AC/DC
Microswitch	(4NC)
Contacts controlled by solenoid	(2NC)
Contacts controlled by an actuator	(2NC)
Approvals	cULus
Reference Directives	2014/35/UE - 2006/42/CE
Reference Standards	IEC 60947-5-1 / EN 60947-5-1 / EN ISO 14119
Interlock type according to EN ISO 14119	Type 2
Encoding level according to EN ISO 14119	Low
Operating Temperatures [°C]	-25°C ... +55°C
Stock Temperatures [°C]	-30°C ... +80°C

PRODUCT DRAWING RELEASE:

Datasheet creation date: 23/01/2023 14:16

Last Modification (geometry): 23/02/2022 08:19



DETAILS:

Protection against electric shocks (according to IEC 60536) [Class]	Class II - Double insulation
Rated Insulating Voltage U_i [V]	250
Pollution Degree	3
Contact rating secondo UL50	A300 - Q300
Rated Impulsive Voltage U_{imp} [kV]	2.5
Conventional thermal current in free air I_{th} (θ min 40 ° C) [A]	10
Short circuit protection (EU min 500Vac - fuses type gG (gl))	10
Operating currents I_e - AC-15 (50-60 Hz) according to IEC 60947-5-3	24V - 10A / 230V - 4A
DC-13 operating currents according to IEC 60947-5-1	24V - 4A
Switching Frequency [cycles/hour]	600
Maximum switching speed [m/min]	20
Resistance Between Contacts [mO]	25
Connecting Terminals	M3 screw with cable clamp (+,-) pozidriv 1
Connecting Cables Dimensions [mm ²]	0.34 ... 1.5
Marking Terminals	According to IEC 60947-5-1
Retention force [N]	1200
Mechanical Durability [Millions of Operations]	1
B10d [Millions of Operations]	4

PRODUCT DRAWING RELEASE:

Datasheet creation date: 23/01/2023 14:16

Last Modification (geometry): 23/02/2022 08:19

