

# COMMUNICATION CARD INSTALLATION INSTRUCTIONS



# IRONHORSE

## ACG AC DRIVE

The following steps illustrate how to install the ACG-ET2 Communication Card on the Ironhorse ACG series drive.



**NOTE:** Ensure all power and control cables are terminated BEFORE installing the communication card. Once the card is installed, there is NO access to the control terminals.



**WARNING;** ENSURE ALL POWER IS REMOVED FROM THE DRIVE BEFORE INSTALLING OR REMOVING THE COMMUNICATION CARD. FAILURE TO COMPLY WILL DAMAGE THE DRIVE.

1) Remove the small cover from the front of the ACG drive.



3) Attach the ACG-ET2 communication card to the front of the ACG drive. Ensure the connector cable fits inside the open space on the inside of the communication card. The card should snap loosely into place.

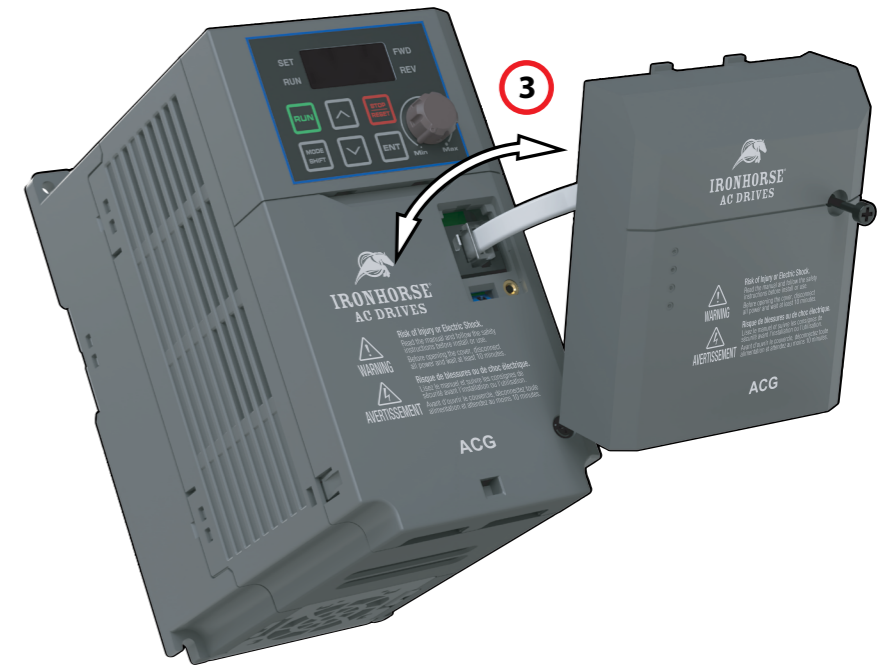

2) Connect the included cable to the ACG-ET2 and the ACG AC drive.

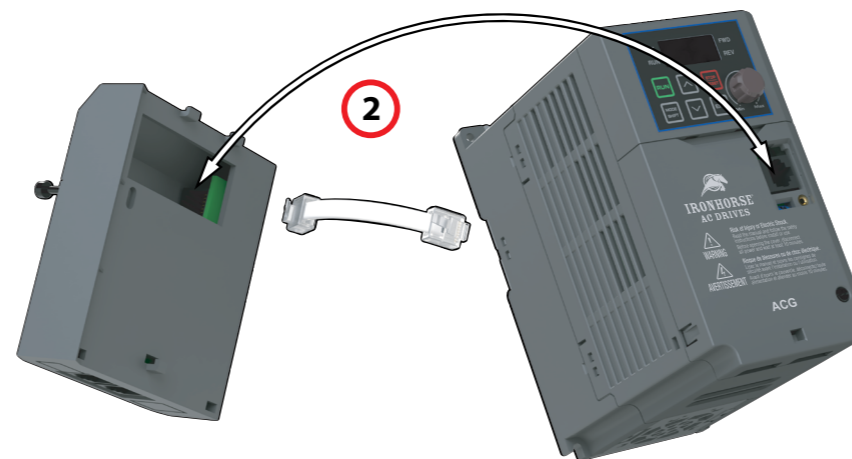

4) Tighten the screw on the front of the communication card to secure the ACG-ET2 to the ACG drive.

