

CONDUIT BOX INSTALLATION INSTRUCTIONS



IRONHORSE®

ACG AC DRIVE

NEMA 1/UL Type 1 compliant conduit boxes are available for all frame sizes (A–F). The following steps illustrate how to install a conduit box on the IronHorse ACG series drive.



WARNING; ENSURE ALL POWER IS REMOVED FROM THE DRIVE BEFORE INSTALLING OR REMOVING THE CONDUIT. FAILURE TO COMPLY WILL DAMAGE THE DRIVE.

1) Install the ACG drive into the conduit as shown in the diagrams below.

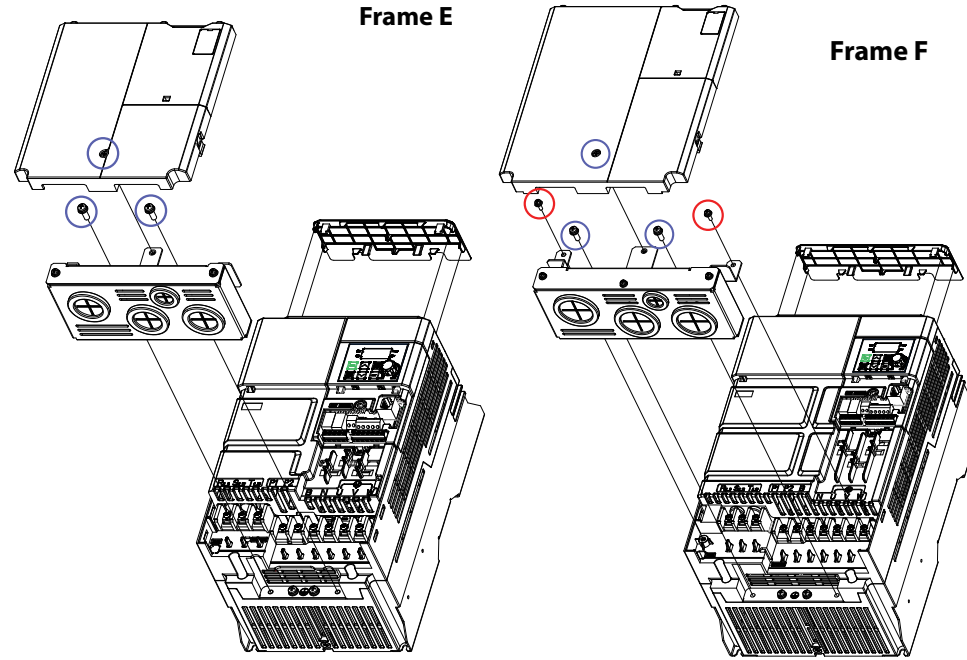
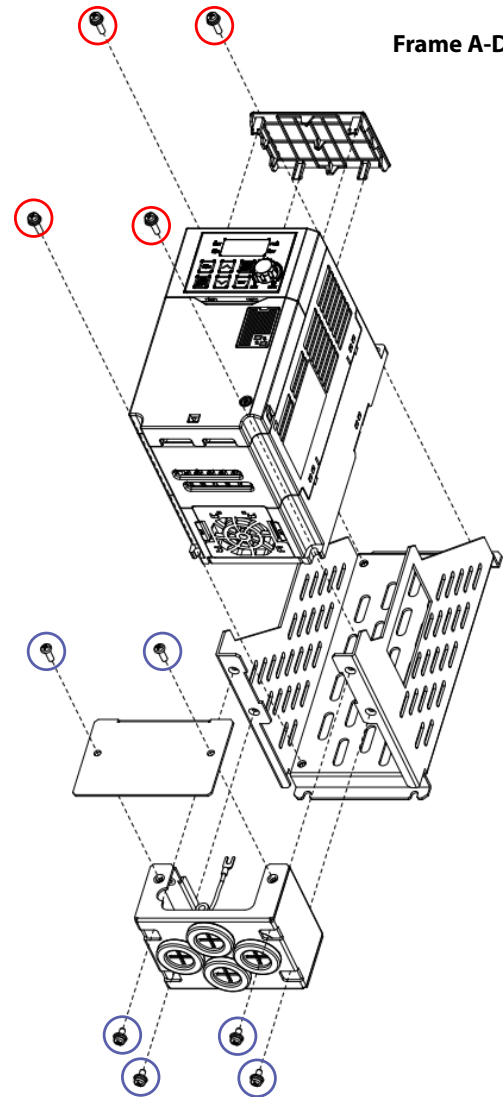

2) Fasten all of the screws circled in the diagram for your frame size.

Frame Size	Diagram Screw Color	Number	Screw Size	Torque Value
A	Red	4	M4	10 kgf-cm
	Blue	6	M4	18 kgf-cm
B	Red	4	M4	10 kgf-cm
	Blue	6	M4	18 kgf-cm
C	Red	4	M4	10 kgf-cm
	Blue	6	M4	18 kgf-cm
D	Red	4	M4	10 kgf-cm
	Blue	6	M4	18 kgf-cm
E	Blue	3	M5	35 kgf-cm
F	Red	2	M4	13 kgf-cm
	Blue	2	M5	35 kgf-cm

3) Remove the I/O cover plate from the ACG drive.

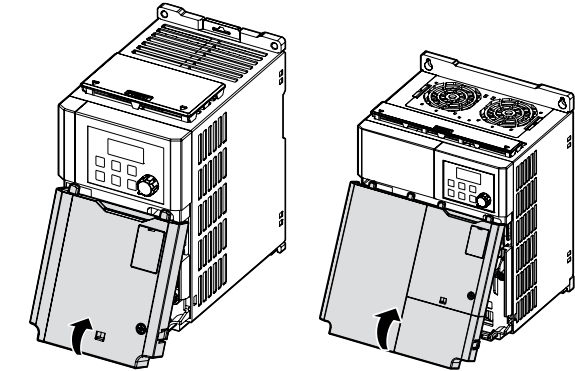

4) Connect the conduit ground wire to the ACG drive ground terminal as shown below.

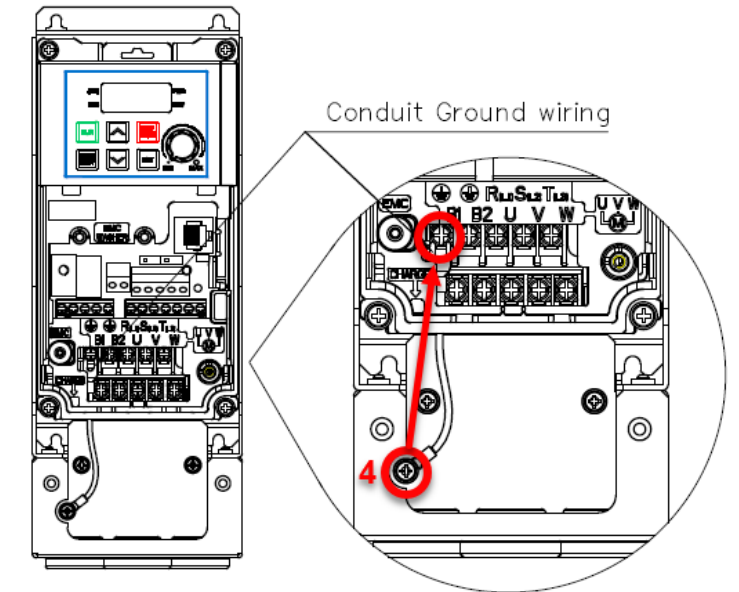

5) Replace the the I/O cover plate on the ACG drive and re-fasten.

