

Ø0.17  
[4.2]  
TUBING X2

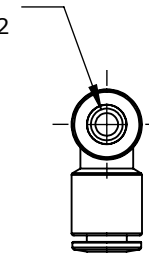

Ø0.17  
[4.2]  
TUBING

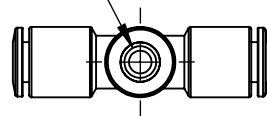

UNION TEE, NICKEL PLATED BRASS BODY, (3) 5/32IN (4MM) PUSH-TO-CONNECT.  
PACKAGE OF 5.

NITRA AIR OR INERT GAS PUSH-TO-CONNECT FITTING

UT532-B

AutomationDirect.com  
1-800-633-0405



3rd  
ANGLE

NOT TO  
SCALE

PART DIMENSIONS MAY DIFFER SLIGHTLY  
DUE TO MANUFACTURER'S VARIANCES

INCH UNITS USED FOR  
PART DESIGN

UNLESS OTHERWISE  
SPECIFIED UNITS ARE:

**inch**  
[mm]

LATEST VERSION  
6/20/2024

SHEET 1 OF 1