

ISOMETRIC VIEW

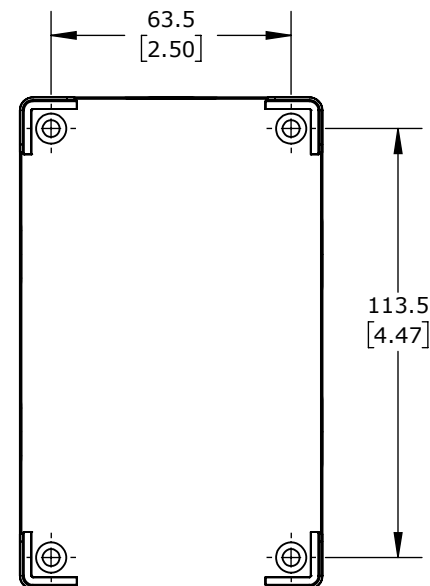
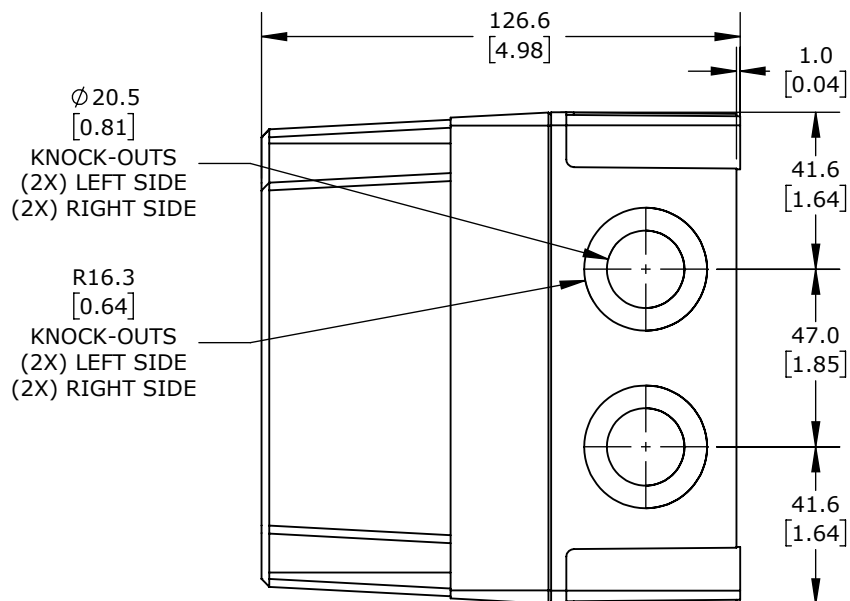
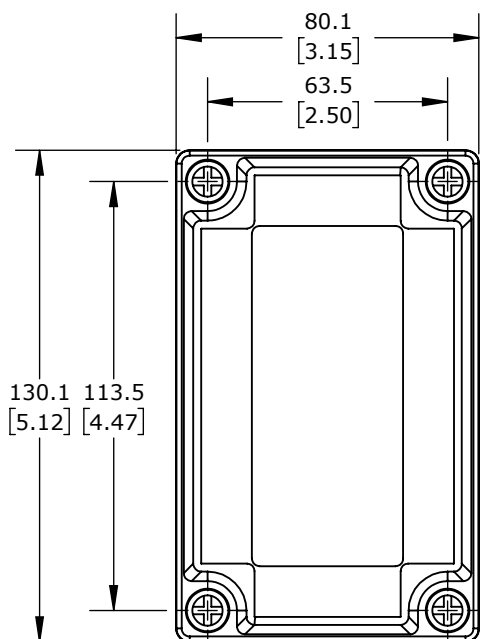
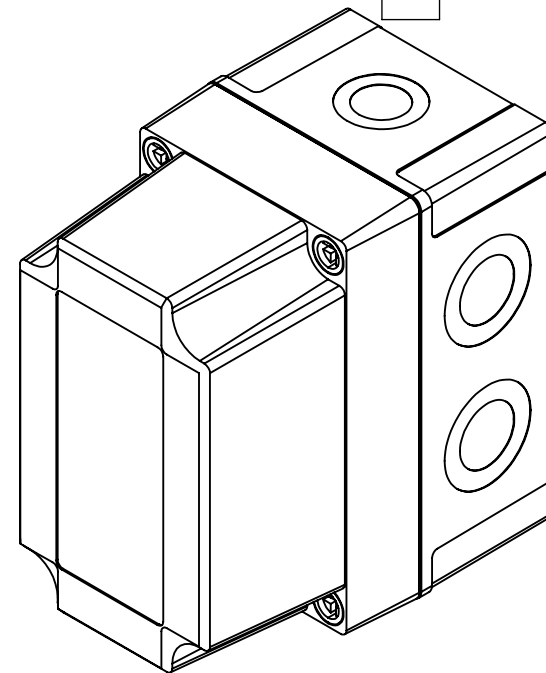

FIBOX MNX ENCLOSURES

ULPCM100125G

AutomationDirect.com  
1-800-633-0405



3rd  
ANGLE

NOT TO  
SCALE

PART DIMENSIONS MAY DIFFER SLIGHTLY  
DUE TO MANUFACTURER'S VARIANCES

METRIC UNITS USED  
FOR PART DESIGN

UNLESS OTHERWISE  
SPECIFIED UNITS ARE: **mm**  
[inch]

MODEL  
REV.

--

DRAWING DATE  
10/23/2025

SHEET 1 OF 1