

SECTION A-A

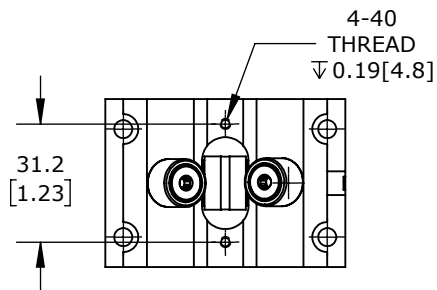

CAM FOLLOWER BEARING, 1.75IN OVERALL LENGTH, STEEL, 5/8IN INSIDE DIAMETER, ALUMINUM HOUSING, ADJUSTABLE RUNNING CLEARANCE. FOR USE WITH 5/8IN DIAMETER PBC SHAFTS.

PBC SPB SERIES SINGLE ROLLER PILLOW BLOCK

SPB-10-OPN

AutomationDirect.com
1-800-633-0405

3rd ANGLE	NOT TO SCALE	PART DIMENSIONS MAY DIFFER SLIGHTLY DUE TO MANUFACTURER'S VARIANCES	METRIC UNITS USED FOR PART DESIGN	UNLESS OTHERWISE SPECIFIED UNITS ARE:	mm [inch]	LATEST VERSION 1/13/2025	SHEET 1 OF 1
-----------	--------------	---	-----------------------------------	---------------------------------------	-----------	--------------------------	--------------