

### LASER SENTINEL FEATURES

- 1.) ETHERNET INPUT CONNECTOR  
(CONFIGURATION PC OR HOST)
- 2.) DIRECT MOUNTING HOLES (2)
- 3.) BRACKET MOUNTING HOLES (4)
- 4.-5.) I/O CONNECTORS (8+12 POLES  
OR 17+8 POLES, ACCORDING TO MODEL)
- 6.) ETHERNET OUTPUT CONNECTOR  
(TO SLAVES)
- 7.) DEVICE CLASS AND WARNING LABELS

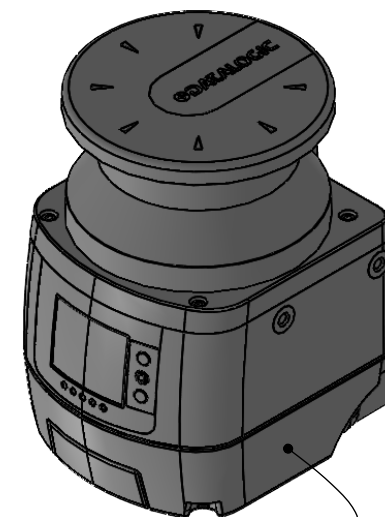

ISOMETRIC VIEW

7

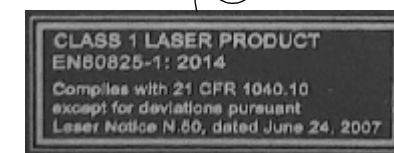

\*DEVICE CLASS & WARNING LABEL

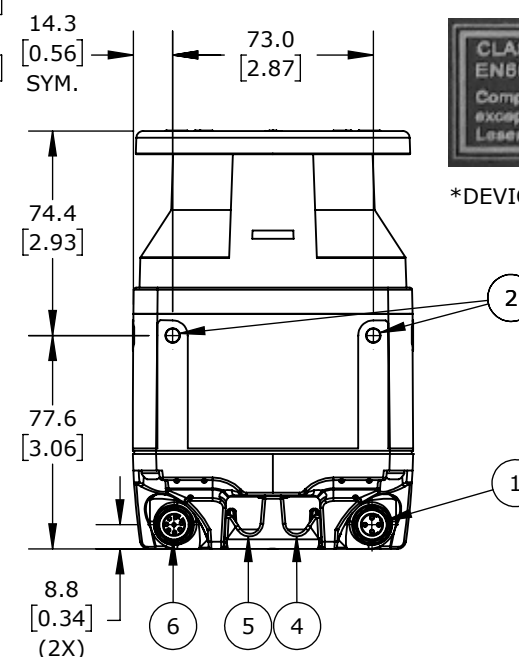
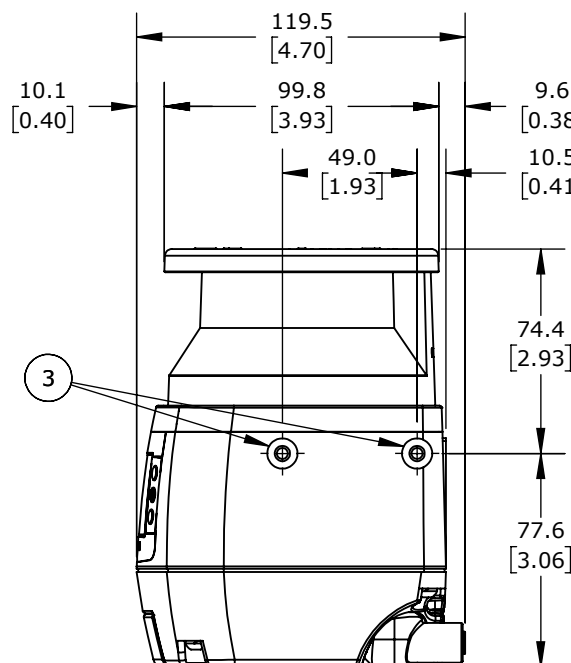
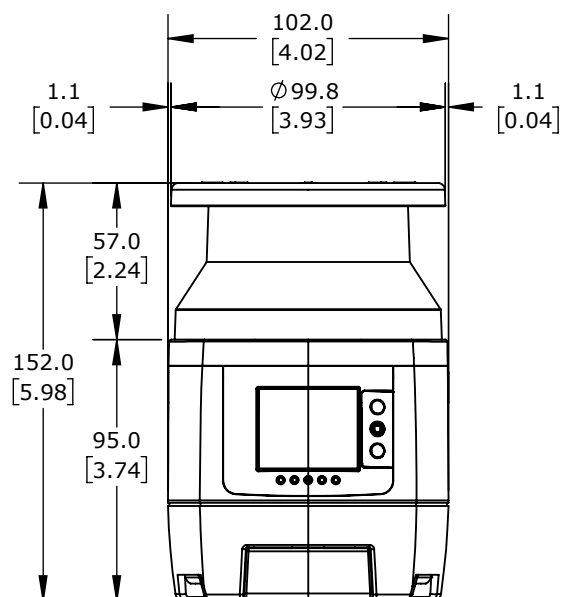

DATASENSING SLS MASTER REMOTE

SLS-M3-0812-E

AutomationDirect.com  
1-800-633-0405