

└ M-SLOT 8.3 X 10.1  $\nabla$  4.8,  
M-SLOT 4.8 X 6.7 THRU ALL  
(4X)

└  $\varnothing$  6.5  $\nabla$  3.5,  
 $\varnothing$  3.7 THRU ALL (6X)

└  $\varnothing$  10.7  $\nabla$  7.1,  
 $\varnothing$  7.1 THRU ALL (3X)

$\varnothing$  5.0  
[0.20]  
(5X)

$\varnothing$  4.1  
[0.16]  
(6X)

127°  
(4X)

ISOMETRIC VIEW

HOLE NUMBER	X DIMENSION	Y DIMENSION
1	9.3[0.36]	44.7[1.76]
2	9.5[0.38]	32.5[1.28]
3	13.3[0.52]	22.2[0.88]
4	16.8[0.66]	15.0[0.59]
5	19.3[0.76]	5.8[0.23]
6	31.8[1.25]	10.3[0.40]
7	31.8[1.25]	19.8[0.78]
8	31.8[1.25]	32.5[1.28]
9	44.3[1.74]	5.8[0.23]
10	46.8[1.84]	15.0[0.59]
11	50.3[1.98]	22.2[0.88]
12	44.3[1.74]	32.5[1.28]
13	54.0[2.13]	32.5[1.28]
14	54.0[2.13]	44.7[1.76]
15	46.8[1.84]	49.0[1.93]
16	48.8[1.92]	57.8[2.27]
17	54.0[2.13]	64.7[2.55]
18	51.3[2.02]	80.1[3.15]
19	48.8[1.92]	95.8[3.77]
20	19.1[0.75]	32.5[1.28]
21	16.8[0.66]	49.0[1.93]
22	14.7[0.58]	57.8[2.27]
23	9.3[0.36]	64.7[2.55]
24	12.0[0.47]	80.1[3.15]
25	14.7[0.58]	95.8[3.77]

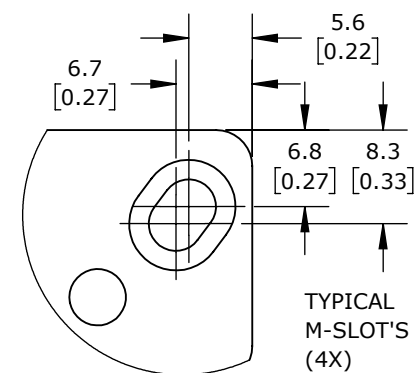
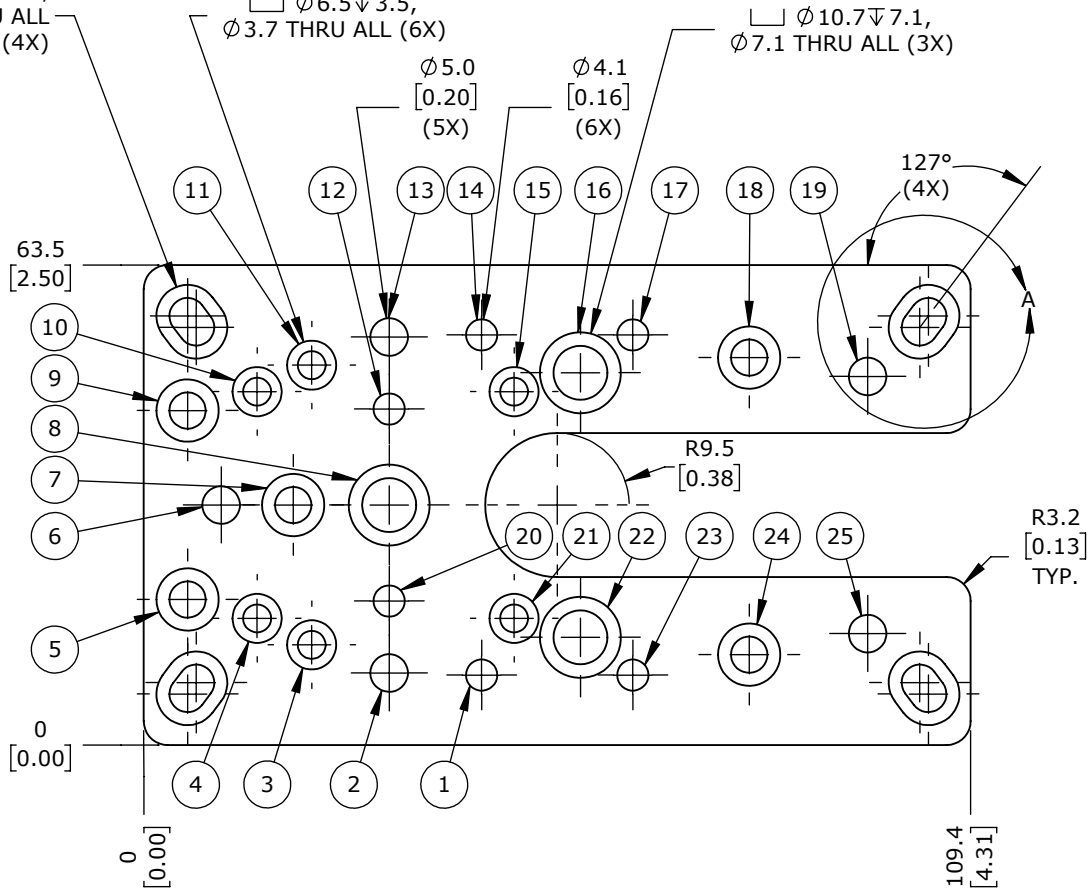

DETAIL A  
SCALE 1.5 : 1

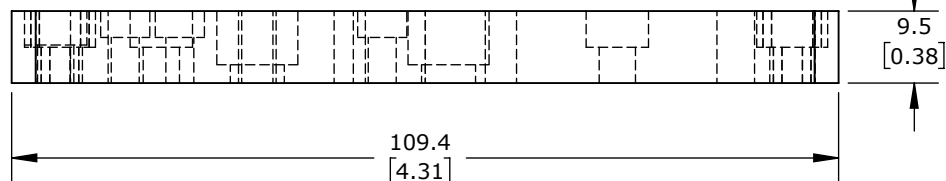
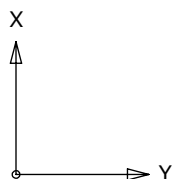

SWIVELINK STANDARD SERIES METRIC MOUNTING PLATE, FOR USE WITH BALL BASES SLM-1 OR SLM-1-40 OR SLM-1XS AND COGNEX, DALSA AND KEYENCE CAMERAS.

**SLM-5**

AutomationDirect.com  
1-800-633-0405



3rd  
ANGLE

NOT TO  
SCALE

PART DIMENSIONS MAY DIFFER SLIGHTLY  
DUE TO MANUFACTURER'S VARIANCES

METRIC UNITS USED  
FOR PART DESIGN

UNLESS OTHERWISE  
SPECIFIED UNITS ARE:

**mm**  
[inch]

LATEST VERSION  
3/29/2023

SHEET 1 OF 2