

PINOUT	
PIN	SINGLE
1	AC IN (L)
2	AC IN (N)
3	-VOUT
4	NC
5	+VOUT
NC:	NOT CONNECTED

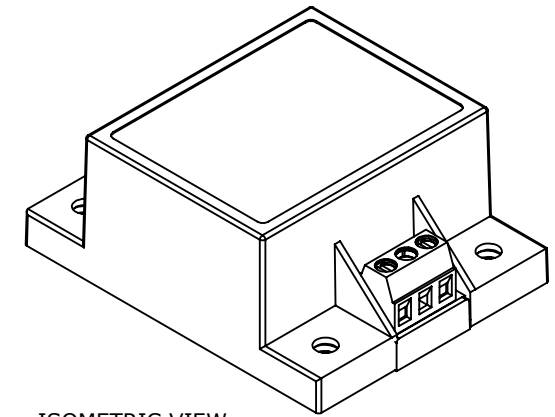

ISOMETRIC VIEW

MOUNTING SCREW LOCKED TORQUE: 0.2 Nm (2 kgfcm)

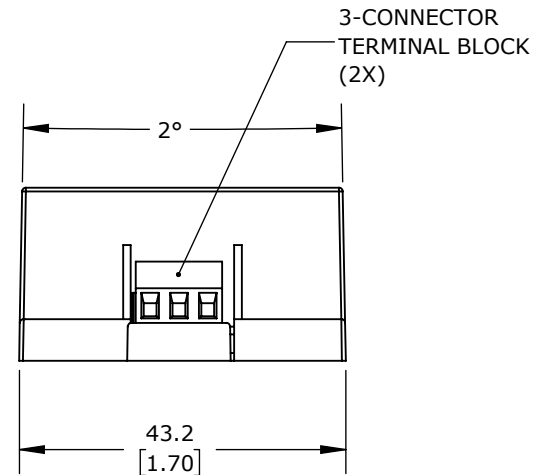
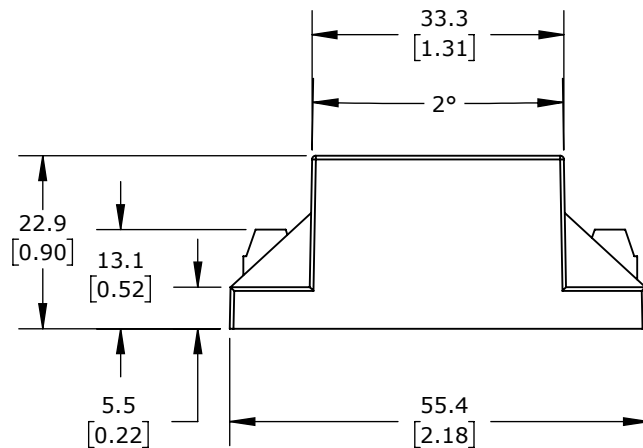

RHINO PSE-S SERIES SWITCHING POWER SUPPLY, 12 VDC @ 0.8A/10W, 120/240 VAC NOMINAL INPUT, 1-PHASE, ENCAPSULATED, PLASTIC RESIN AND FIBERGLASS HOUSING, CHASSIS MOUNT, SCREW TERMINALS.

**PSE12-110-S**

AutomationDirect.com  
1-800-633-0405



3rd  
ANGLE

NOT TO  
SCALE

PART DIMENSIONS MAY DIFFER SLIGHTLY  
DUE TO MANUFACTURER'S VARIANCES

METRIC UNITS USED  
FOR PART DESIGN

UNLESS OTHERWISE  
SPECIFIED UNITS ARE:

**mm**  
[inch]

LATEST VERSION  
6/5/2024

SHEET 1 OF 1