

18mm (DIN 43650A)  
PLUG

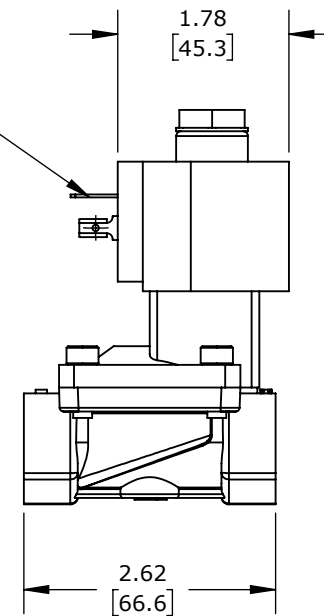

2-PORT (2-WAY), 2-POSITION, N.O., LEAD-FREE BRASS BODY, EPDM RUBBER SEAL(s), 3/8IN FEMALE NPT INLET(s), 3/8IN FEMALE NPT OUTLET(s), CV=4.3, 24 VDC OPERATING VOLTAGE, 9W, NSF/ANSI 61.

GC VALVES POTABLE WATER SOLENOID VALVE

NS712YH16C9CG1

AutomationDirect.com  
1-800-633-0405



3rd  
ANGLE

NOT TO  
SCALE

PART DIMENSIONS MAY DIFFER SLIGHTLY  
DUE TO MANUFACTURER'S VARIANCES

INCH UNITS USED FOR  
PART DESIGN

UNLESS OTHERWISE  
SPECIFIED UNITS ARE:

inch  
[mm]

LATEST VERSION  
2/18/2025

SHEET 1 OF 1