

ISOMETRIC VIEW

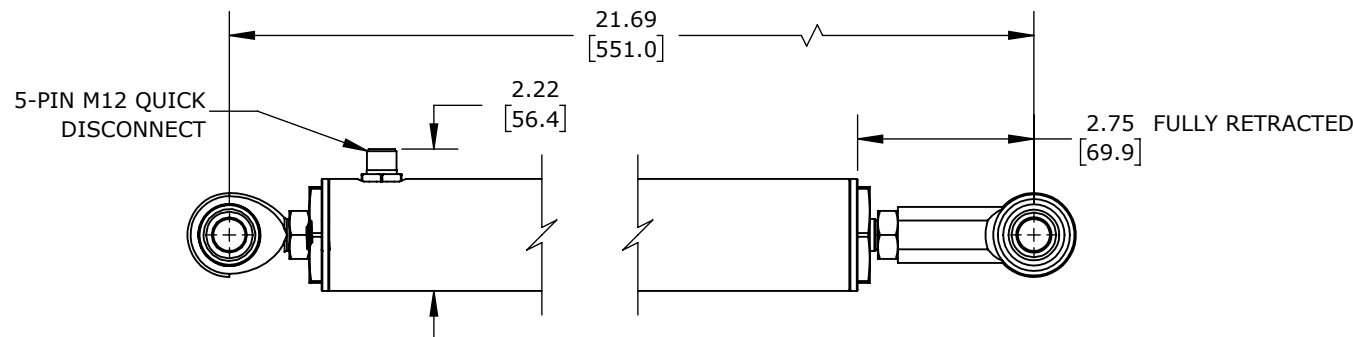
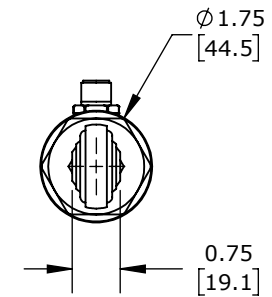
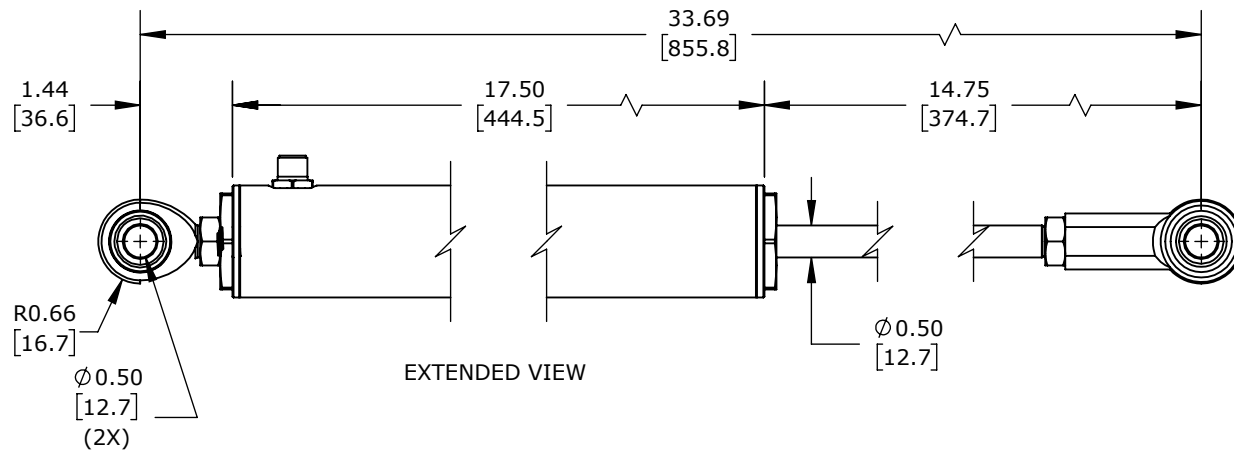

ALLIANCE SENSORS INDUCTIVE LINEAR POSITION SENSOR, SLIDE, 300MM STROKE, 12.5MM SHAFT DIAMETER, 0-10 VDC OUTPUT, 45MM DIAMETER X 454.1MM BODY, ROD EYES MOUNT, 5-PIN M12 QUICK-DISCONNECT.

LVE45-300R-01-10S

AutomationDirect.com
1-800-633-0405



3rd
ANGLE

NOT TO
SCALE

PART DIMENSIONS MAY DIFFER SLIGHTLY
DUE TO MANUFACTURER'S VARIANCES

METRIC UNITS USED
FOR PART DESIGN

UNLESS OTHERWISE
SPECIFIED UNITS ARE:

inch
[mm]

LATEST VERSION
3/22/2022

SHEET 1 OF 1