

TECHNICAL SPECIFICATIONS

SLPC [MM]	400
US [USEFUL STROKE]	400
MS [MECHANICAL STROKE]	404
L [TOTAL LENGTH]	586

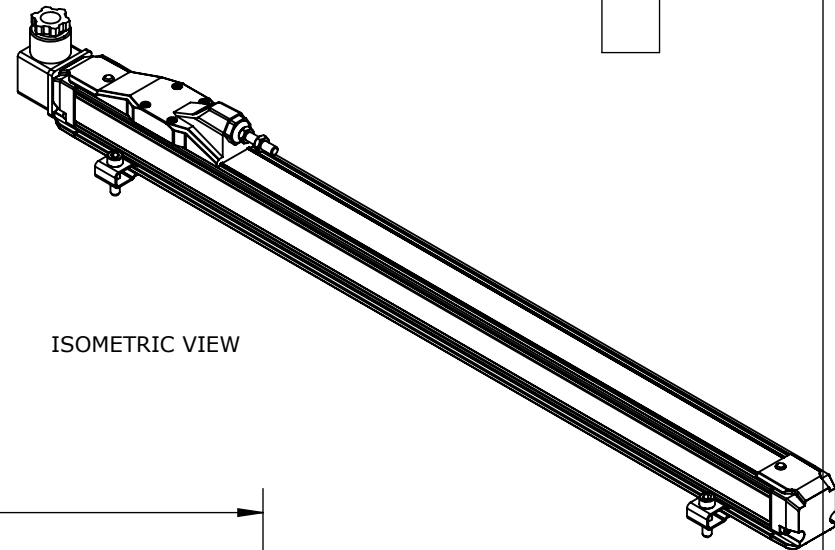

ISOMETRIC VIEW

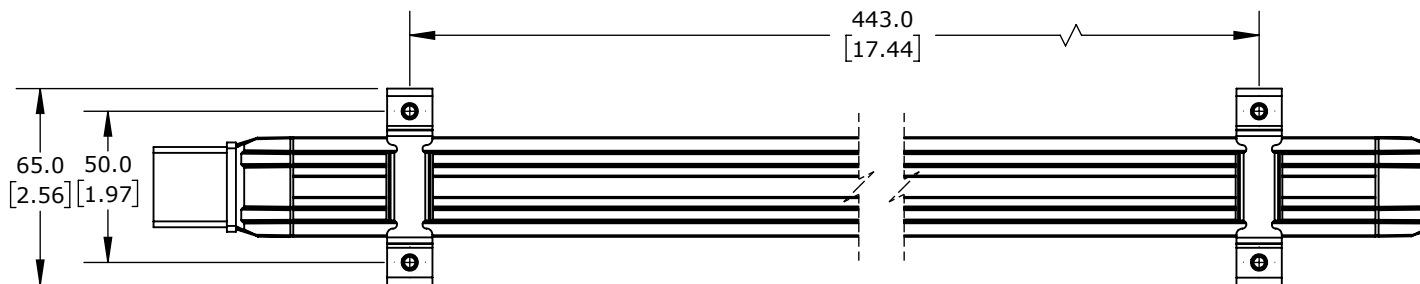
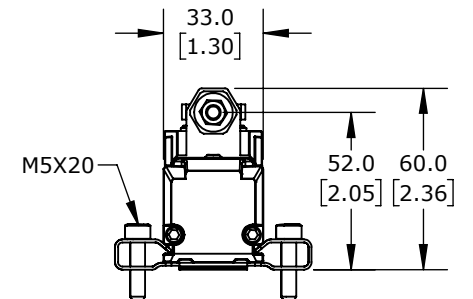
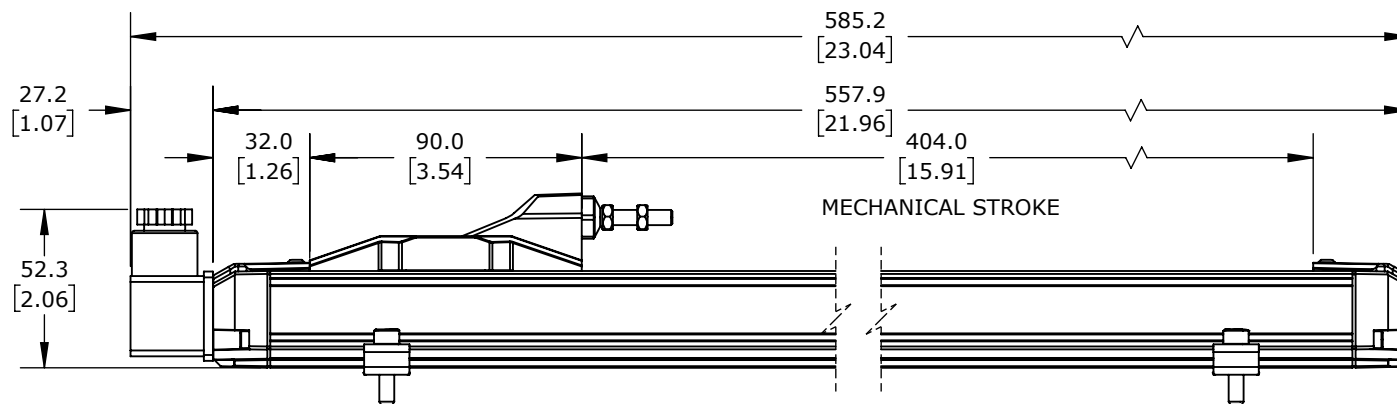

PROSENSE POTENTIOMETER LINEAR POSITION SENSOR, RODLESS SLIDE, 400MM STROKE, 33 X 33 X 558MM
BODY, CHANNEL MOUNT, 18MM DIN 43650 FORM A.

LSRS-33P-0400-D5-C1

AutomationDirect.com
1-800-633-0405



3rd
ANGLE

NOT TO
SCALE

PART DIMENSIONS MAY DIFFER SLIGHTLY
DUE TO MANUFACTURER'S VARIANCES

METRIC UNITS USED
FOR PART DESIGN

UNLESS OTHERWISE
SPECIFIED UNITS ARE:

mm
[inch]

LATEST VERSION
1/14/2025

SHEET 1 OF 1