

TECHNICAL SPECIFICATIONS

SLPC [MM]	350
US [USEFUL STROKE]	350
MS [MECHANICAL STROKE]	354
L [TOTAL LENGTH]	489

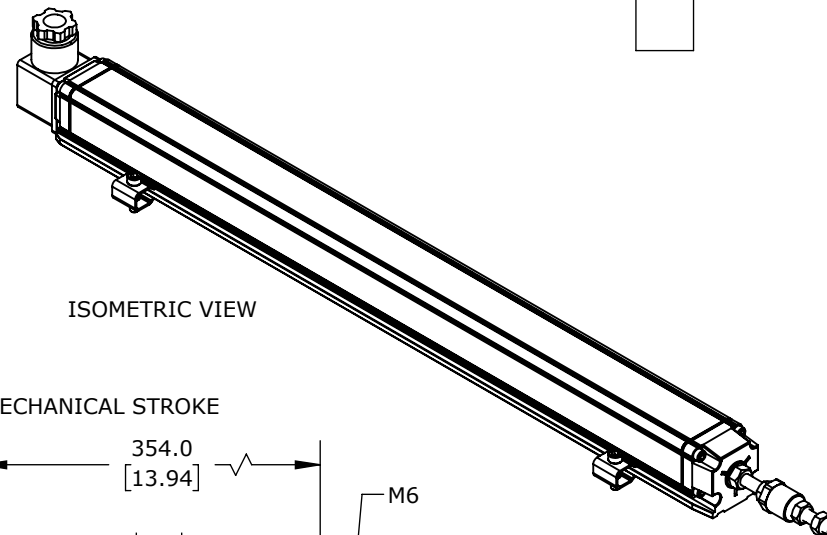

ISOMETRIC VIEW

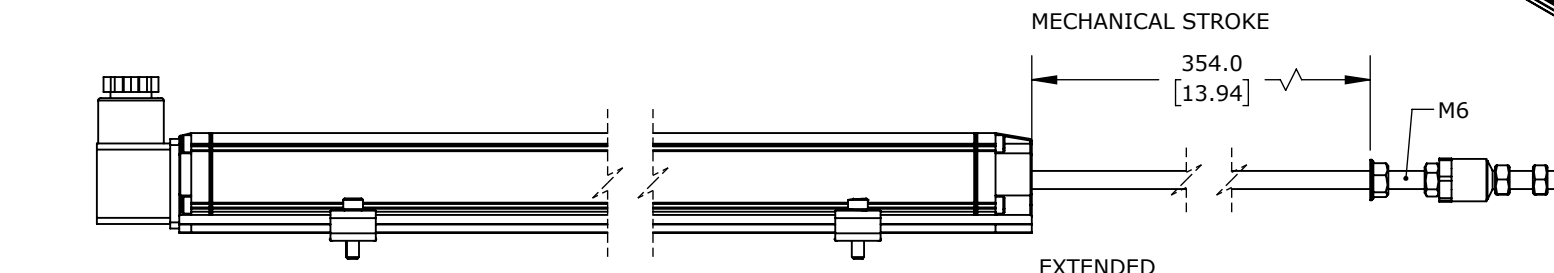

MECHANICAL STROKE

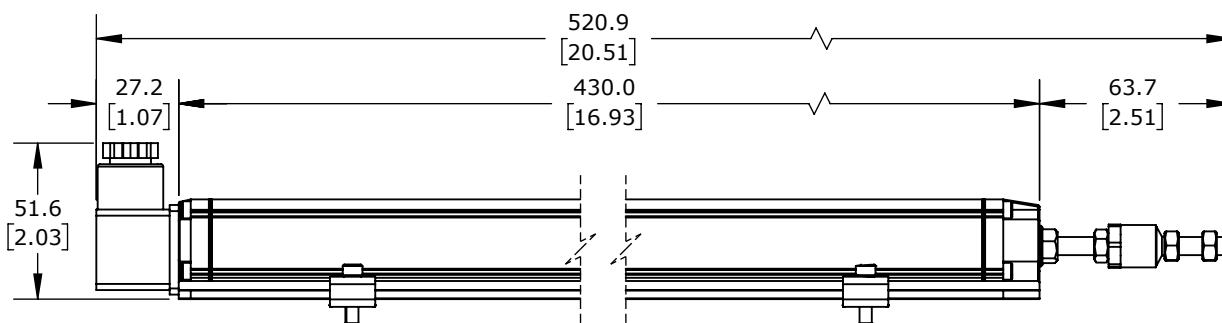

EXTENDED

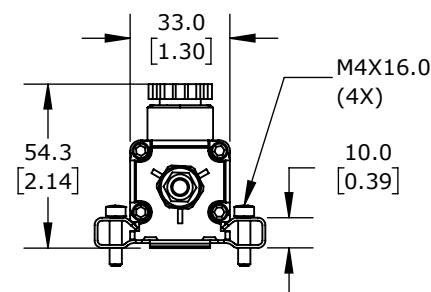

RETRACTED

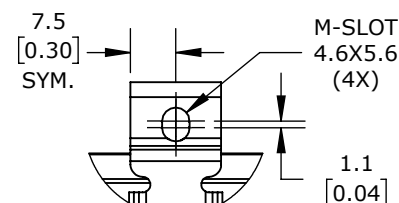
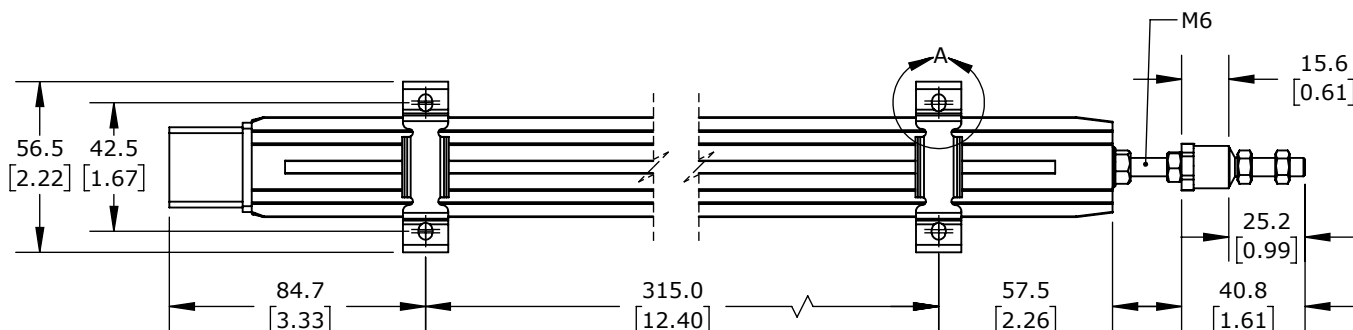

DETAIL A
SCALE 2 : 2.5

PROSENSE POTENTIOMETER LINEAR POSITION SENSOR, FIXED SLIDE, 350MM STROKE, 33 X 33 X 430MM BODY, CHANNEL MOUNT, 18MM DIN 43650 FORM A.

LSR-33P-0350-D5-C1

AutomationDirect.com
1-800-633-0405



3rd
ANGLE

NOT TO
SCALE

PART DIMENSIONS MAY DIFFER SLIGHTLY
DUE TO MANUFACTURER'S VARIANCES

METRIC UNITS USED
FOR PART DESIGN

UNLESS OTHERWISE
SPECIFIED UNITS ARE:

mm
[inch]

LATEST VERSION
1/10/2025

SHEET 1 OF 1