

TECHNICAL SPECIFICATIONS

SLPC [MM]	175
US [USEFUL STROKE]	175
MS [MECHANICAL STROKE]	178
L [TOTAL LENGTH]	276

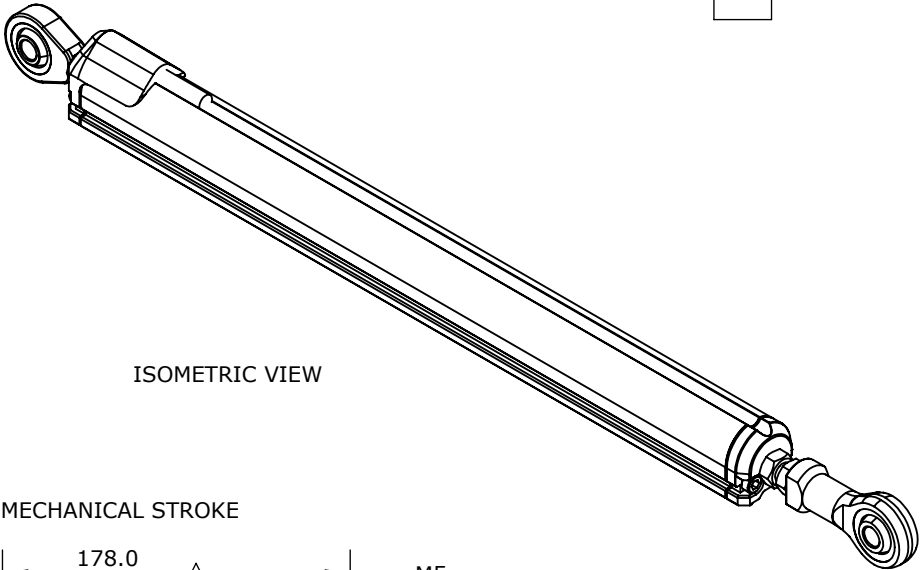

ISOMETRIC VIEW

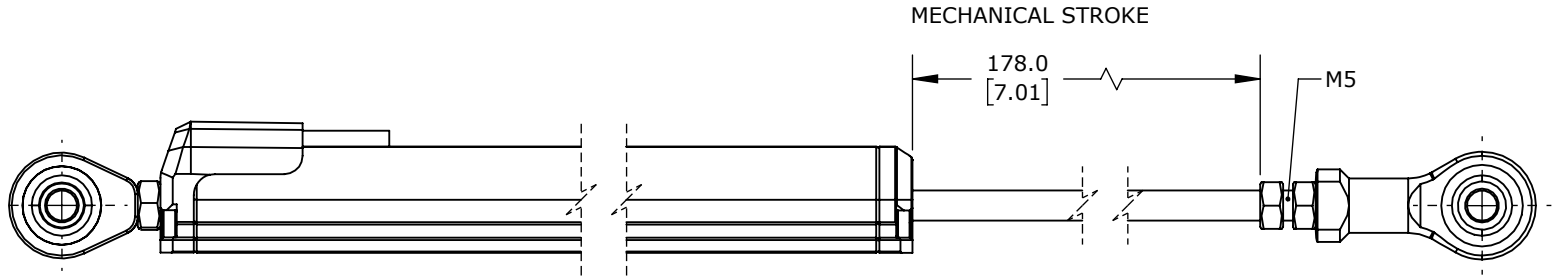

MECHANICAL STROKE

EXTENDED

±5MM ADJUSTABLE LENGTH

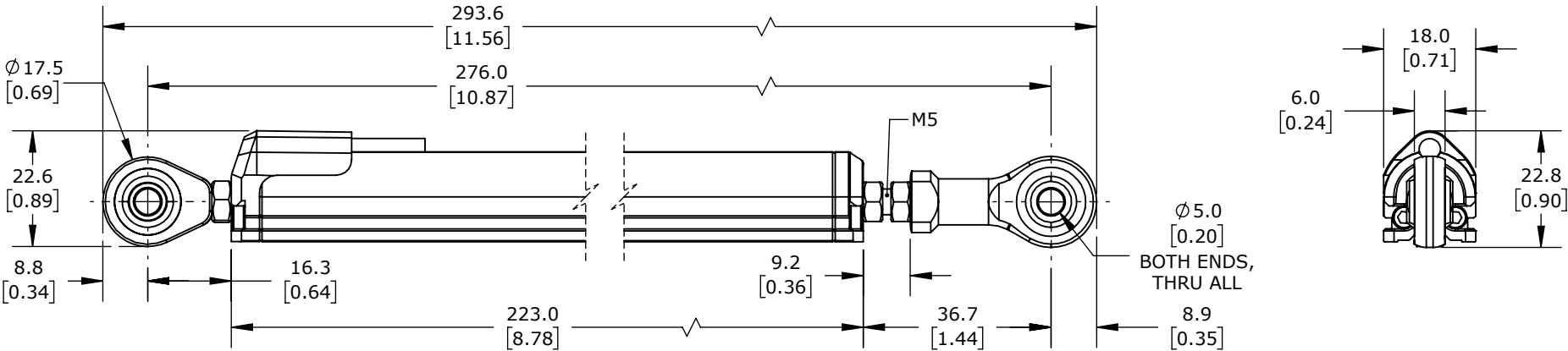

RETRACTED

PROSENSE POTENTIOMETER LINEAR POSITION SENSOR, PIVOTING SLIDE, 175MM STROKE, 18MM DIAMETER X 223MM BODY, ROD EYES MOUNT, PIGTAIL, 3.2FT/1M CABLE LENGTH.

LCR-18P-0175-C5-1A

AutomationDirect.com
1-800-633-0405



3rd
ANGLE

NOT TO
SCALE

PART DIMENSIONS MAY DIFFER SLIGHTLY
DUE TO MANUFACTURER'S VARIANCES

METRIC UNITS USED
FOR PART DESIGN

UNLESS OTHERWISE
SPECIFIED UNITS ARE:

mm
[inch]

LATEST VERSION
1/8/2025

SHEET 1 OF 1