

TECHNICAL SPECIFICATIONS

SLPC [MM]	10
US [USEFUL STROKE]	10
MS [MECHANICAL STROKE]	13
L [TOTAL LENGTH]	111

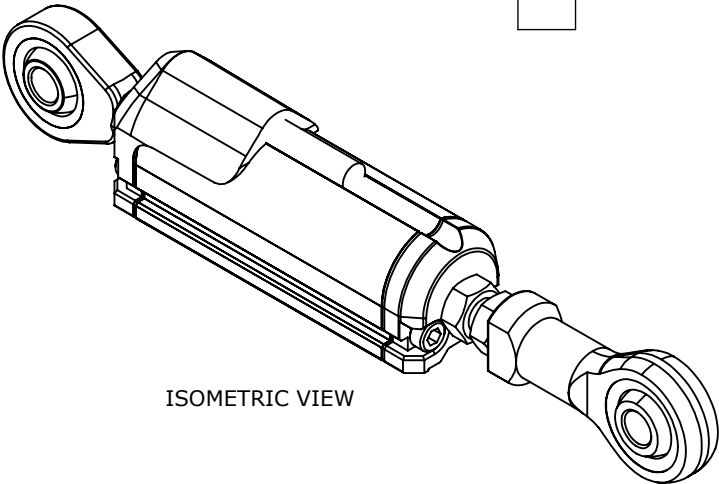

ISOMETRIC VIEW

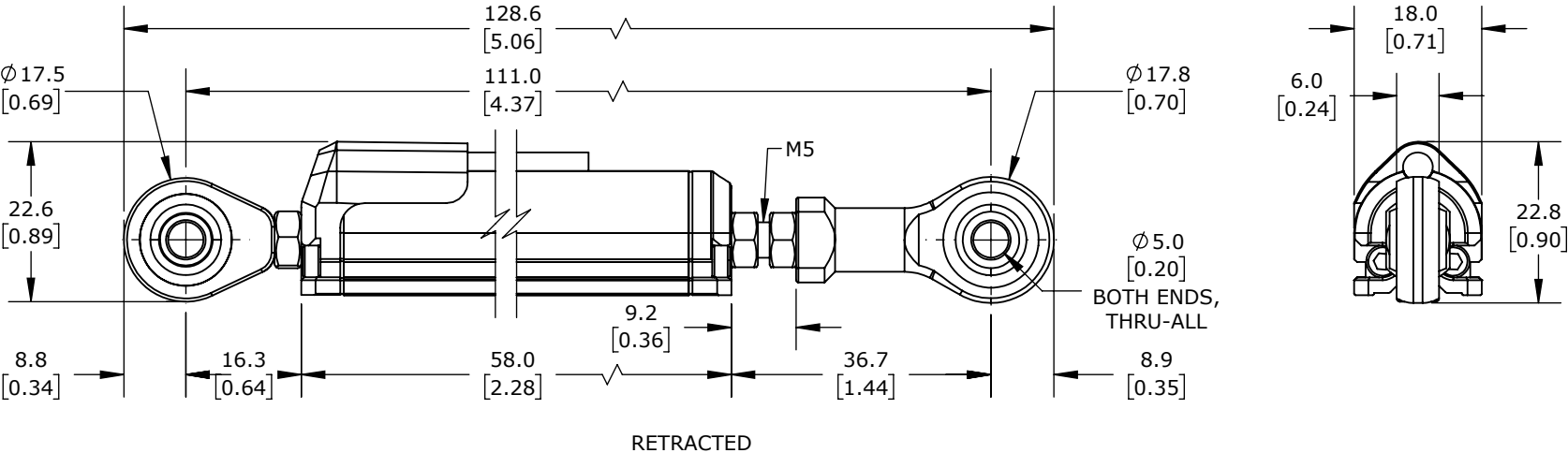
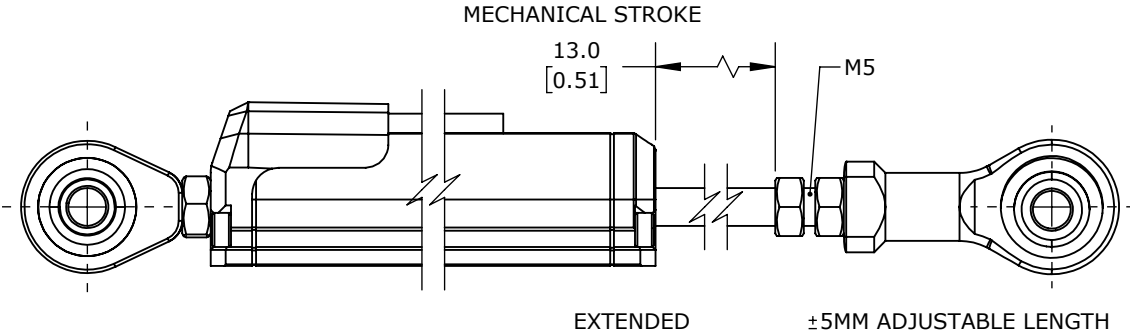

PROSENSE POTENTIOMETER LINEAR POSITION SENSOR, PIVOTING SLIDE, 10MM STROKE, 33 X 33 X 222MM BODY, ROD EYES MOUNT, PIGTAIL, 3.2FT/1M CABLE LENGTH.

LCR-18P-0010-A2-1A

AutomationDirect.com
1-800-633-0405



3rd
ANGLE

NOT TO
SCALE

PART DIMENSIONS MAY DIFFER SLIGHTLY
DUE TO MANUFACTURER'S VARIANCES

METRIC UNITS USED
FOR PART DESIGN

UNLESS OTHERWISE
SPECIFIED UNITS ARE:

mm
[inch]

LATEST VERSION
10/4/2024

SHEET 1 OF 1