

ISOMETRIC VIEW

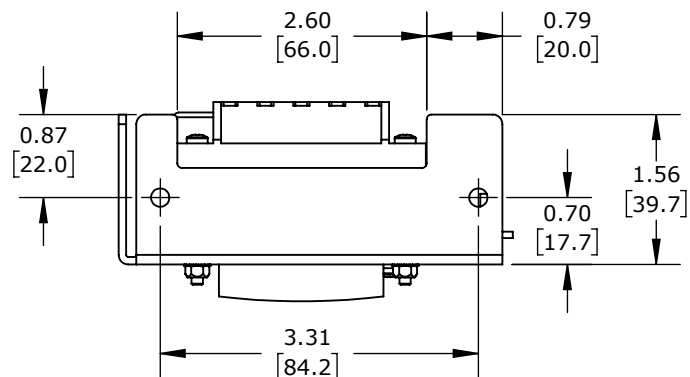

INTERNATIONAL POWER REGULATED LINEAR POWER SUPPLY, 24 VDC @ 1.2A/28W, 120/240 VAC NOMINAL INPUT, 1-PHASE, OPEN FRAME, ALUMINUM HOUSING, CHASSIS MOUNT, TURRET TERMINALS.

**IHB24-1.2**

AutomationDirect.com  
1-800-633-0405



3rd  
ANGLE

NOT TO  
SCALE

PART DIMENSIONS MAY DIFFER SLIGHTLY  
DUE TO MANUFACTURER'S VARIANCES

METRIC UNITS USED  
FOR PART DESIGN

UNLESS OTHERWISE  
SPECIFIED UNITS ARE:

**inch**  
**[mm]**

LATEST VERSION  
5/18/2023

SHEET 1 OF 1