

STANDARD DUPLEX
RECEPTACLES
(2X)

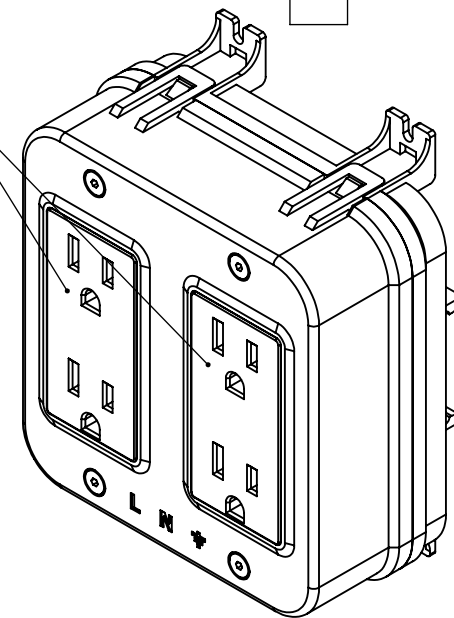

ISOMETRIC VIEW

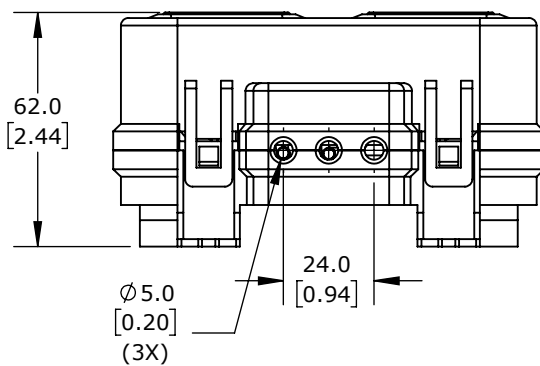

GENERAL NOTES :

- 1.) TIGHTENING TORQUE: 4.5 LB-IN (0.51 N.m)
- 2.) WIRE SIZE: 14 - 12AWG (COPPER OR COPPER CLAD)
- 3.) MOUNTING: PANEL (128.0 X 63.5 HOLE DISTANCES); DIN RAIL (35MM WIDE)

GLADIATOR QUAD STRAIGHT BLADE RECEPTACLE, 15A, 125 VAC, 1-PHASE, 2-POLE, 3-WIRE, NEMA 5-15, GLASS FIBER REINFORCED POLYAMIDE HOUSING, BLACK.

GR-REC4

AutomationDirect.com
1-800-633-0405



3rd
ANGLE

NOT TO
SCALE

PART DIMENSIONS MAY DIFFER SLIGHTLY
DUE TO MANUFACTURER'S VARIANCES

METRIC UNITS USED
FOR PART DESIGN

UNLESS OTHERWISE
SPECIFIED UNITS ARE:

mm
[inch]

LATEST VERSION
4/30/2024

SHEET 1 OF 1