

FOR REFERENCE ONLY
MOUNTING FEET SHOWN AS INSTALLED

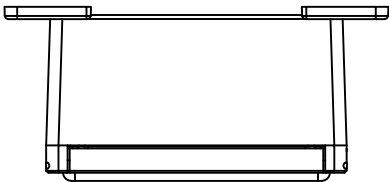
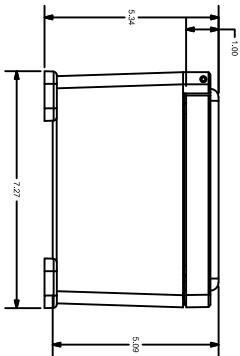
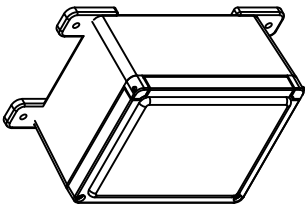

STAHLIN CLASSIC SERIES ENCLOSURE, NEMA 1/3/3S/3R/4X/12, 9 X 7 X 5IN (HXWXD), WALL MOUNT, FIBERGLASS REINFORCED POLYESTER, GRAY, CROWNED HINGED SCREW COVER

CL907HW

AutomationDirect.com
1-800-633-0405



3rd ANGLE	NOT TO SCALE	PART DIMENSIONS MAY DIFFER SLIGHTLY DUE TO MANUFACTURER'S VARIANCES	METRIC UNITS USED FOR PART DESIGN	UNLESS OTHERWISE SPECIFIED UNITS ARE:	inch [mm]	LATEST VERSION 1/27/2023	SHEET 1 OF 1
--------------	-----------------	--	--------------------------------------	--	--------------	-----------------------------	--------------