

FOR REFERENCE ONLY
MOUNTING FEET SHOWN AS INSTALLED

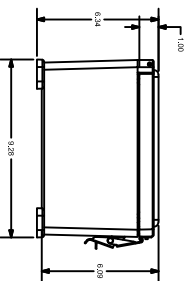
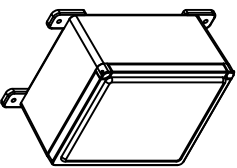
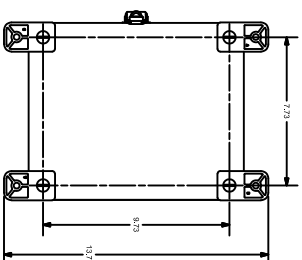
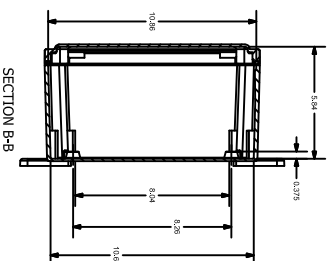
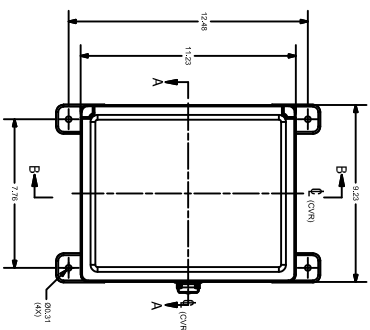
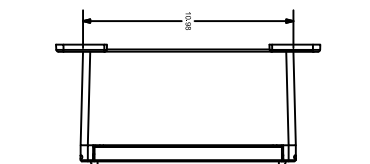

3rd
ANGLE

NOT TO
SCALE

PART DIMENSIONS MAY DIFFER SLIGHTLY
DUE TO MANUFACTURER'S VARIANCES

METRIC UNITS USED
FOR PART DESIGN

UNLESS OTHERWISE
SPECIFIED UNITS ARE:

inch

[mm]

LATEST VERSION

SHEET 1 OF 1

STAHLIN CLASSIC SERIES ENCLOSURE, NEMA 1/3/3S/3B/4X/12, 11 X 9 X 6IN (HXWXD), WALL MOUNT, FIBERGLASS REINFORCED
POLYESTER, GRAY, CROWNED SINGLE-DOOR, (1) QUICK-RELEASE LATCH, PADLOCK HASP AND STAPLE.

CL1109HPL

Automa tionDirect.com
1-800-633-0405