

REFLECTOR

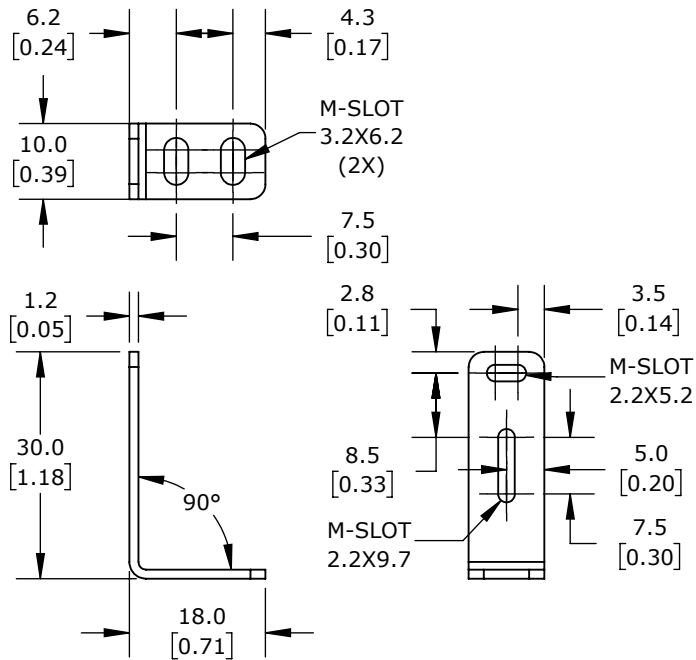

MOUNTING BRACKET
(2 PIECE)

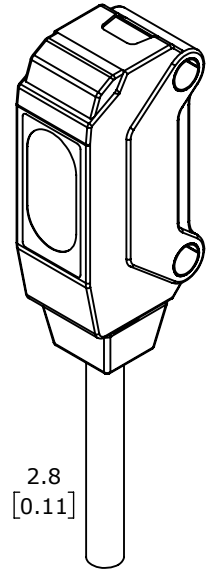
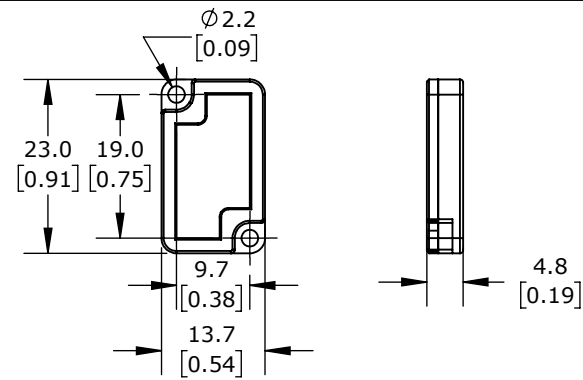
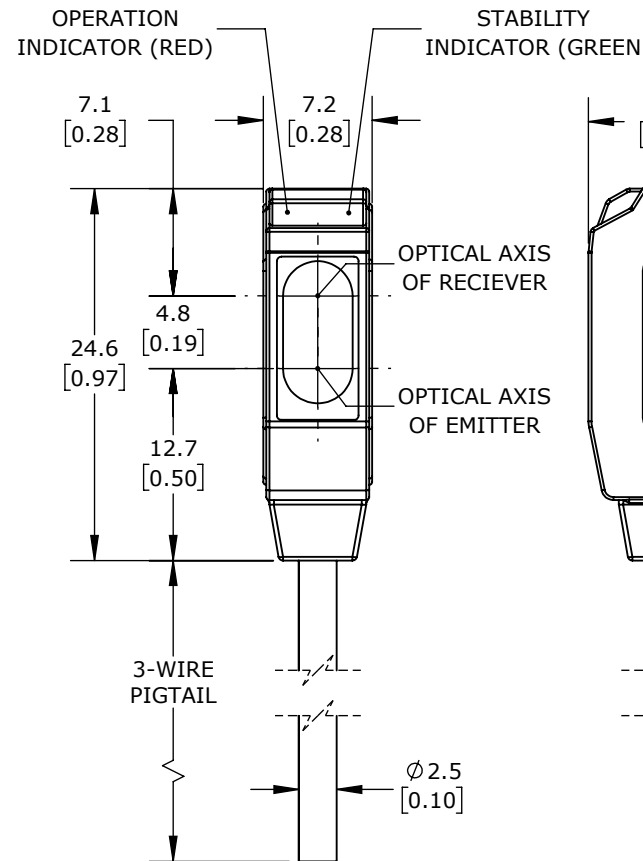

SENDER RECIEVER

AUTONICS PHOTOELECTRIC SENSOR, RECTANGULAR, RETROREFLECTIVE, VISIBLE RED LIGHT EMISSION, 10-200MM SENSING DISTANCE, LIGHT-ON, NPN, 3-WIRE, PIGTAIL.

BTS200-MDTL

AutomationDirect.com
1-800-633-0405



3rd
ANGLE

NOT TO
SCALE

PART DIMENSIONS MAY DIFFER SLIGHTLY
DUE TO MANUFACTURER'S VARIANCES

METRIC UNITS USED
FOR PART DESIGN

UNLESS OTHERWISE
SPECIFIED UNITS ARE:

mm
[inch]

LATEST VERSION
2/6/2025

SHEET 1 OF 1