

MOUNTING BRACKET  
( 2 PIECE )

REFLECTOR

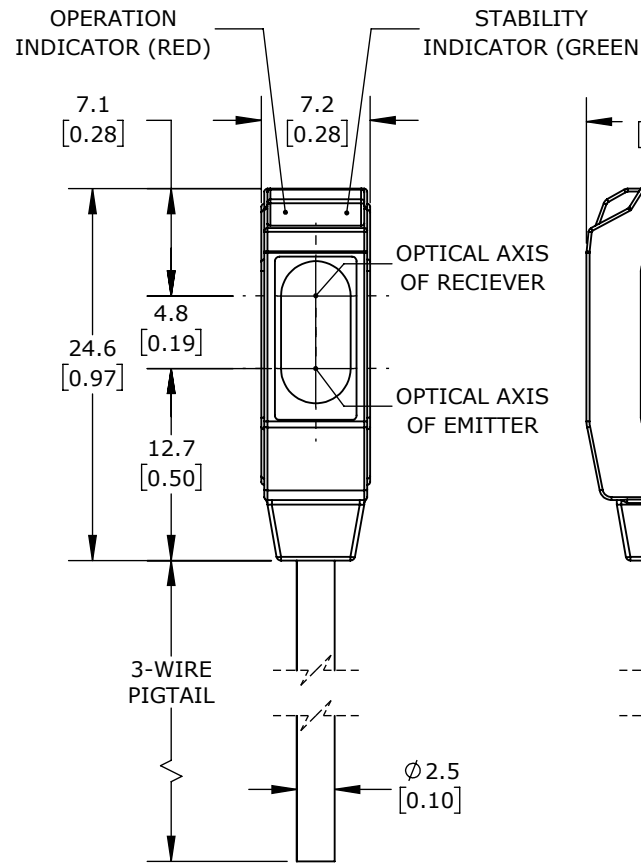
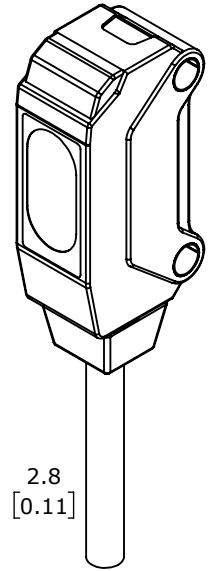
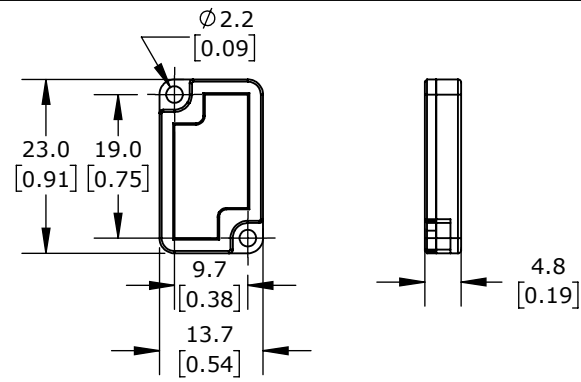

SENDER RECIEVER

AUTONICS PHOTOELECTRIC SENSOR, RECTANGULAR, RETROREFLECTIVE, VISIBLE RED LIGHT EMISSION, 10-200MM SENSING DISTANCE, LIGHT-ON, PNP, 3-WIRE, PIGTAIL.

BTS200-MDTL-P

AutomationDirect.com  
1-800-633-0405



### 3rd ANGLE

NOT TO  
SCALE

PART DIMENSIONS MAY DIFFER SLIGHTLY  
DUE TO MANUFACTURER'S VARIANCES

METRIC UNITS USED  
FOR PART DESIGN

UNLESS OTHERWISE  
SPECIFIED UNITS ARE:

mm  
[inch]

LATEST VERSION  
2/6/2025

SHEET 1 OF 1