

# TECHNICAL INFORMATION

- 1.) SENSING SURFACE
- 2.) HOUSING
- 3.) COVER
- 4.) POTENTIOMETER
- 5.) LED POWER
- 6.) LED FUNCTION INDICATOR

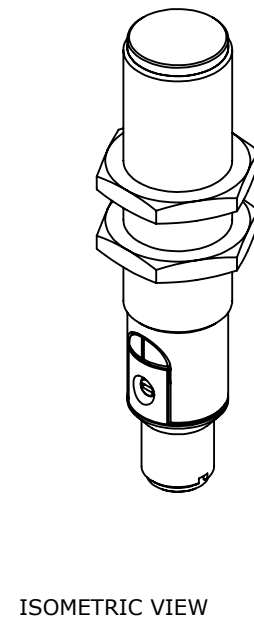
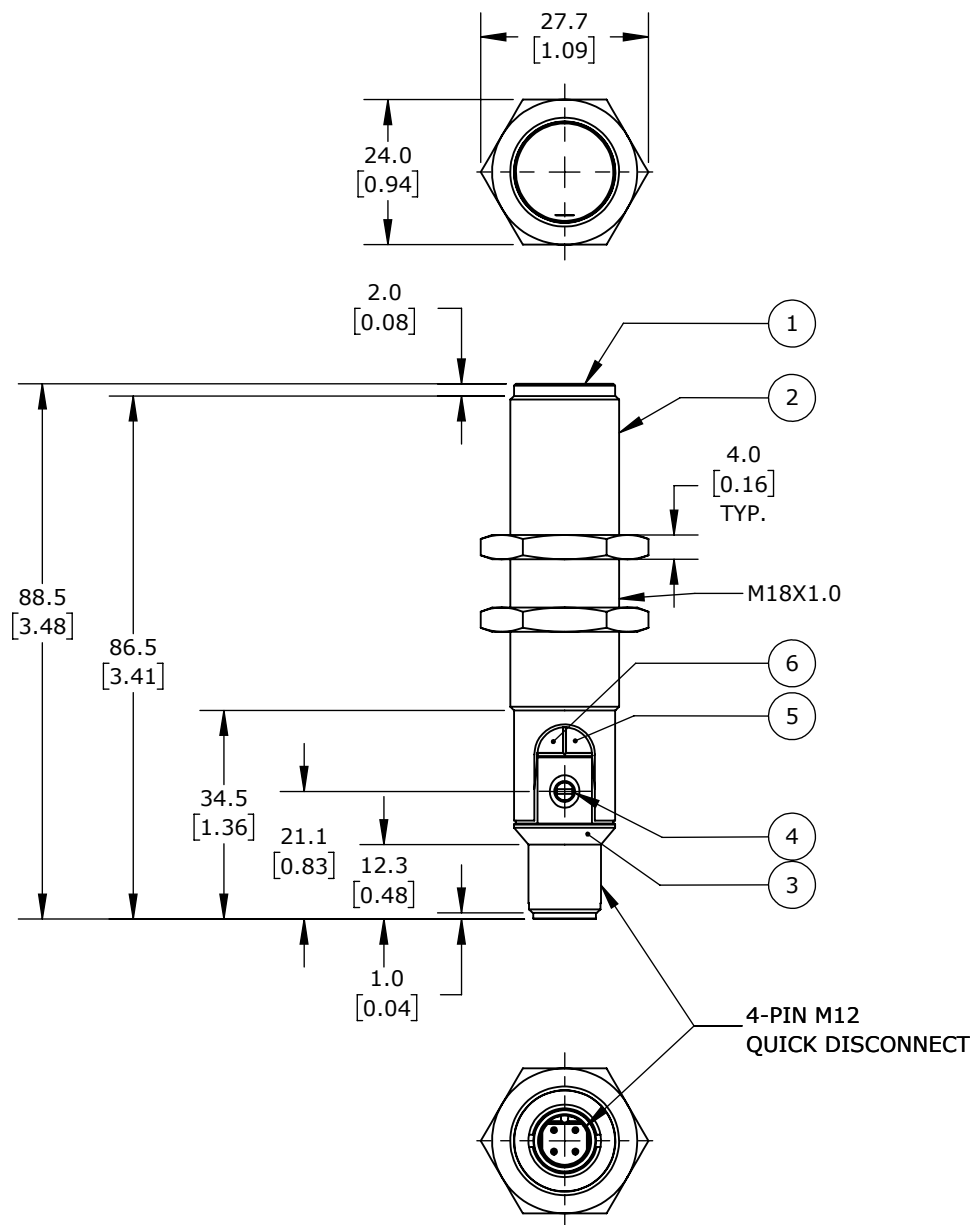

BALLUFF CAPACITIVE PROXIMITY SENSOR, TUBULAR, 18MM DIAMETER X 88.5MM BODY, STAINLESS STEEL HOUSING, PNP, N.O., 8MM SENSING DISTANCE, FLUSH, 100 HZ SWITCHING FREQUENCY, IP67, 4-PIN M12 QUICK-DISCONNECT.

BCS00MF

AutomationDirect.com  
1-800-633-0405



3rd  
ANGLE

NOT TO  
SCALE

PART DIMENSIONS MAY DIFFER SLIGHTLY  
DUE TO MANUFACTURER'S VARIANCES

METRIC UNITS USED  
FOR PART DESIGN

UNLESS OTHERWISE  
SPECIFIED UNITS ARE:

mm  
[inch]

LATEST VERSION  
7/20/2023

SHEET 1 OF 1