

└─ M-SLOT 0.32"X0.40" ▽0.19",
M-SLOT 0.19"X0.26 THRU ALL
(4X)

└─ $\varnothing 0.26 \nabla 0.14$ ",
 $\varnothing 0.15$ " THRU ALL (6X)

└─ $\varnothing 0.42 \nabla 0.28$ "
 $\varnothing 0.28$ " THRU ALL (3X)

└─ $\varnothing 0.32 \nabla 0.19$ "
 $\varnothing 0.19$ " THRU ALL
(5X)

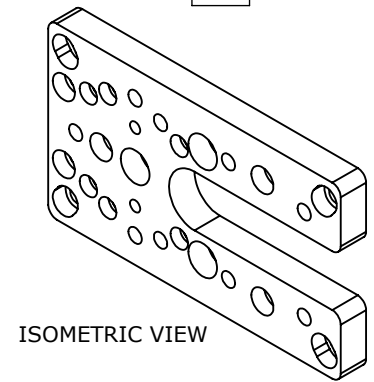

ISOMETRIC VIEW

HOLE NUMBER	X DIMENSION	Y DIMENSION
1	0.38[9.5]	1.28[32.5]
2	0.52[13.3]	0.88[22.2]
3	0.66[16.8]	0.59[15.0]
4	0.76[19.3]	0.23[5.8]
5	1.25[31.8]	0.40[10.3]
6	1.25[31.8]	0.78[19.8]
7	1.25[31.8]	1.28[32.5]
8	1.74[44.3]	0.23[5.8]
9	1.84[46.8]	0.59[15.0]
10	1.98[50.3]	0.78[19.8]
11	1.75[44.5]	1.28[32.5]
12	2.13[54.0]	1.28[32.5]
13	2.00[50.8]	1.65[42.0]
14	1.84[46.8]	1.93[49.0]
15	1.94[49.3]	2.27[57.8]
16	2.00[50.8]	2.65[67.4]
17	2.02[51.3]	3.15[80.1]
18	1.92[48.8]	3.77[95.8]
19	0.75[19.1]	1.28[32.5]
20	0.50[12.7]	1.65[42.0]
21	0.66[16.8]	1.93[49.0]
22	0.56[14.3]	2.27[57.8]
23	0.50[12.7]	2.65[67.4]
24	0.47[12.0]	3.15[80.1]
25	0.58[14.7]	3.77[95.8]

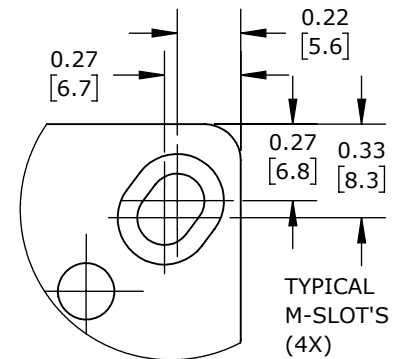
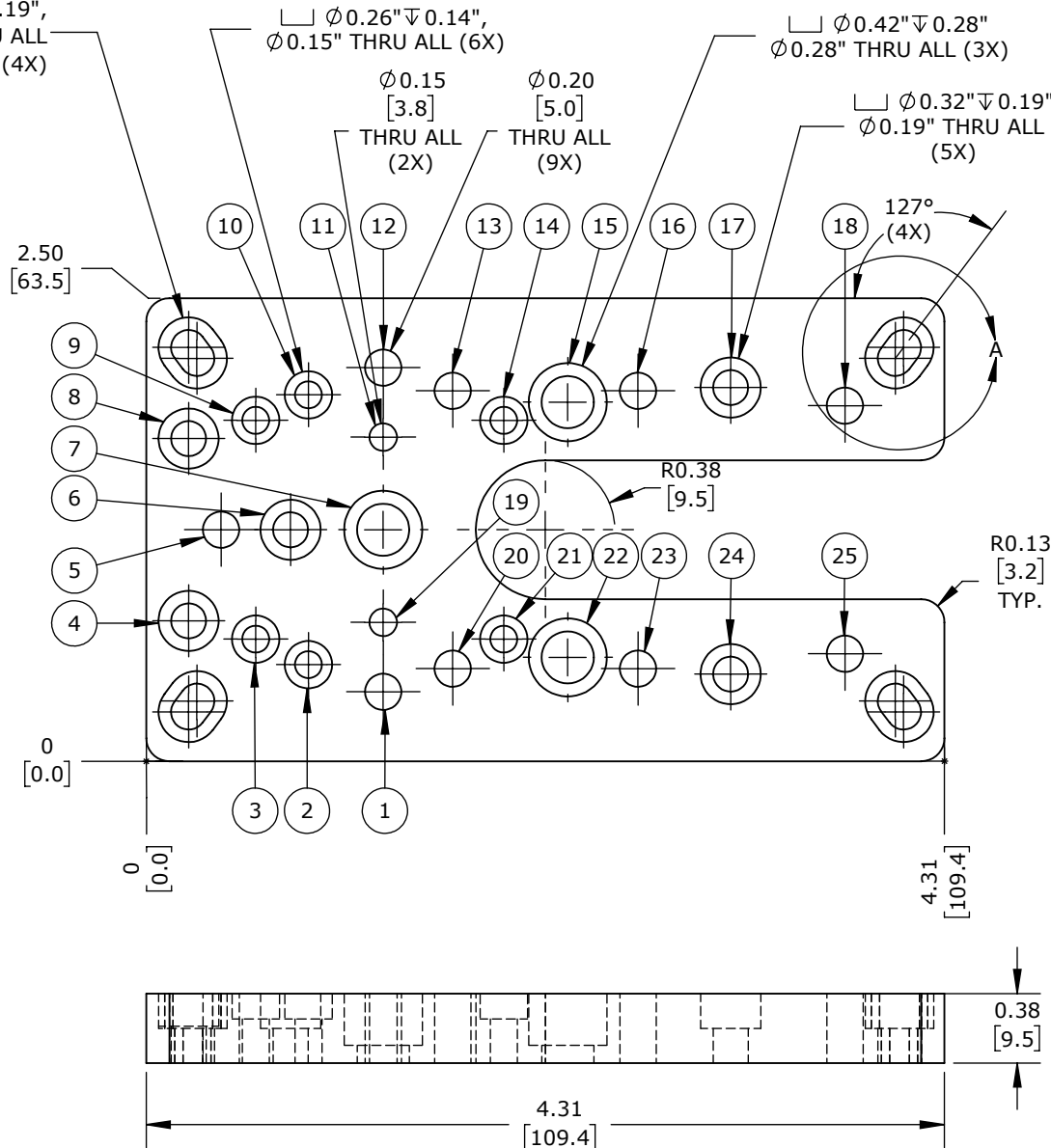

DETAIL A
SCALE 1.5 : 1

SWIVELINK STANDARD SERIES IMPERIAL MOUNTING PLATE, FOR USE WITH BALL BASES AF5B-1 OR AF5B-1-15
OR AF5B-1XS AND COGNEX, DALSA AND KEYENCE CAMERAS.

AF5B-5

AutomationDirect.com
1-800-633-0405



3rd
ANGLE

NOT TO
SCALE

PART DIMENSIONS MAY DIFFER SLIGHTLY
DUE TO MANUFACTURER'S VARIANCES

METRIC UNITS USED
FOR PART DESIGN

UNLESS OTHERWISE
SPECIFIED UNITS ARE:

inch
[mm]

LATEST VERSION
3/29/2023

SHEET 1 OF 2