

SECTION A-A

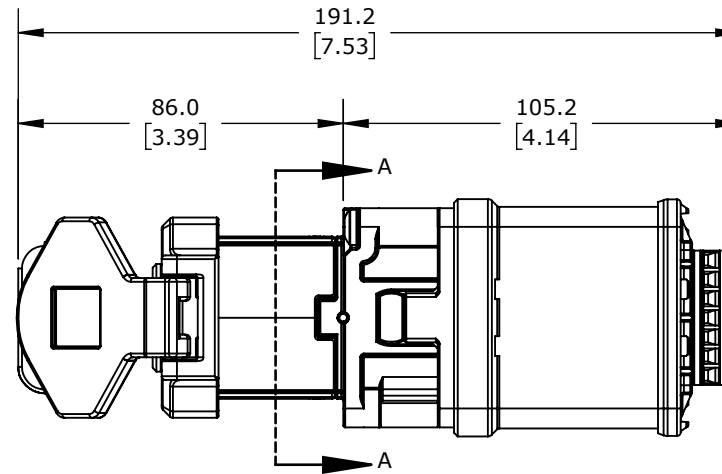
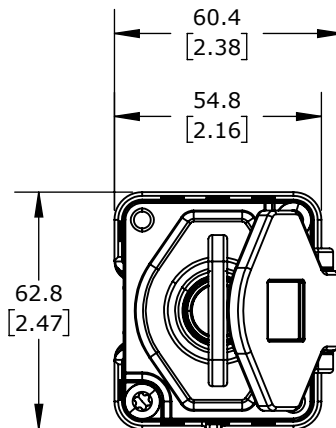
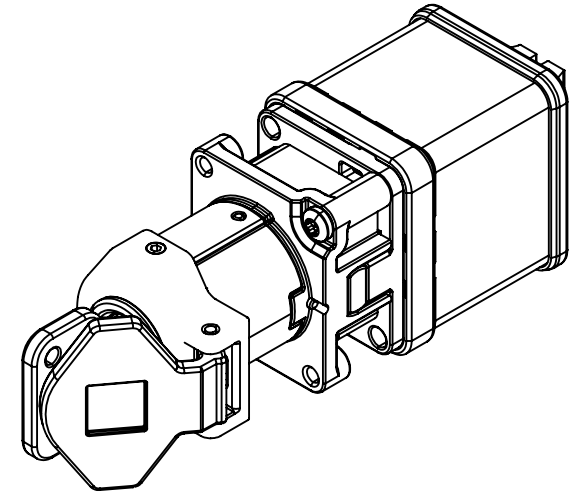

PANEL MOUNT FITTING

IDEM SKORPION SERIES SOLENOID CONTROL SWITCH, ROTARY KEY, A102 CODED, (4) N.C./(2) N.O. CONTACT(S), DIE-CAST ALUMINUM ALLOY. FOR USE WITH A102 CODED SKORPION TRAPPED KEY INTERLOCK SYSTEMS. (1) M-CS-SKR SOLENOID CONTROL SWITCH AND (1) SK-KEY KEY INCLUDED.

**800000-CS-SKR-A102**

AutomationDirect.com  
1-800-633-0405



3rd  
ANGLE

NOT TO  
SCALE

PART DIMENSIONS MAY DIFFER SLIGHTLY  
DUE TO MANUFACTURER'S VARIANCES

METRIC UNITS USED  
FOR PART DESIGN

UNLESS OTHERWISE  
SPECIFIED UNITS ARE:

**mm**  
[inch]

LATEST VERSION  
8/10/2022

SHEET 1 OF 1